

RESOLUTION NO. 01- 17692

A RESOLUTION OF THE CITY OF BILLINGS, MONTANA, EXPANDING THE BOUNDARIES OF THE BILLINGS URBAN PLANNING AREA TO INCLUDE THE WILLIAM D. PIERCE SUBDIVISION.

WHEREAS, an Urban Planning Study was conducted on the William D. Pierce Subdivision and was submitted to the City for review and approval, and

WHEREAS, the Billings Urban Planning Area is the area established by the City, for the purpose of planning for future growth of the City, and

WHEREAS, the purpose of the study is to determine impacts on city services, the natural environment, and the feasibility of extending City services within the proposed area, and

WHEREAS, the study area encompasses the property located south of the proposed Shiloh business Park Subdivision and north of Montana Rail Link Right-of-Way, bounded on the east by the Shiloh Interchange Right-of-Way and on the west by Shiloh Road, bordering existing City limits on the north and east, and

WHEREAS, the Yellowstone County Board of Planning reviewed the Urban Planning Study on the William D. Pierce Subdivision at its regular meeting on March 27, 2001, and

WHEREAS, the Yellowstone County Board of Planning has recommended approval of inclusion of the William D. Subdivision in the Billings Urban Planning Area, finding that municipal services can safely and efficiently be extended to this area and the projected growth is consistent with existing and proposed land use and transportation plans, and

WHEREAS, a public hearing was properly noticed and held by the Billings City Council as required by law.

NOW, THEREFORE, BE IT RESOLVED BY THE CITY COUNCIL OF THE CITY OF BILLINGS, MONTANA, AS FOLLOWS:

1. URBAN PLANNING STUDY. The Urban Planning Study for the William D. Pierce Subdivision is hereby approved by the Billings City Council.
2. URBAN PLANNING AREA. The boundaries of the Billings Urban Planning Area are hereby extended to include the William D. Pierce Subdivision.

PASSED AND APPROVED by the City Council this 23rd day of April, 2001.



THE CITY OF BILLINGS:

BY:

Charles F. Tooley
Charles F. Tooley

Charles F. Tooley
MAYOR

ATTEST:

BY:

Marita Herold
Marita Herold, CMC/AAE

City Clerk

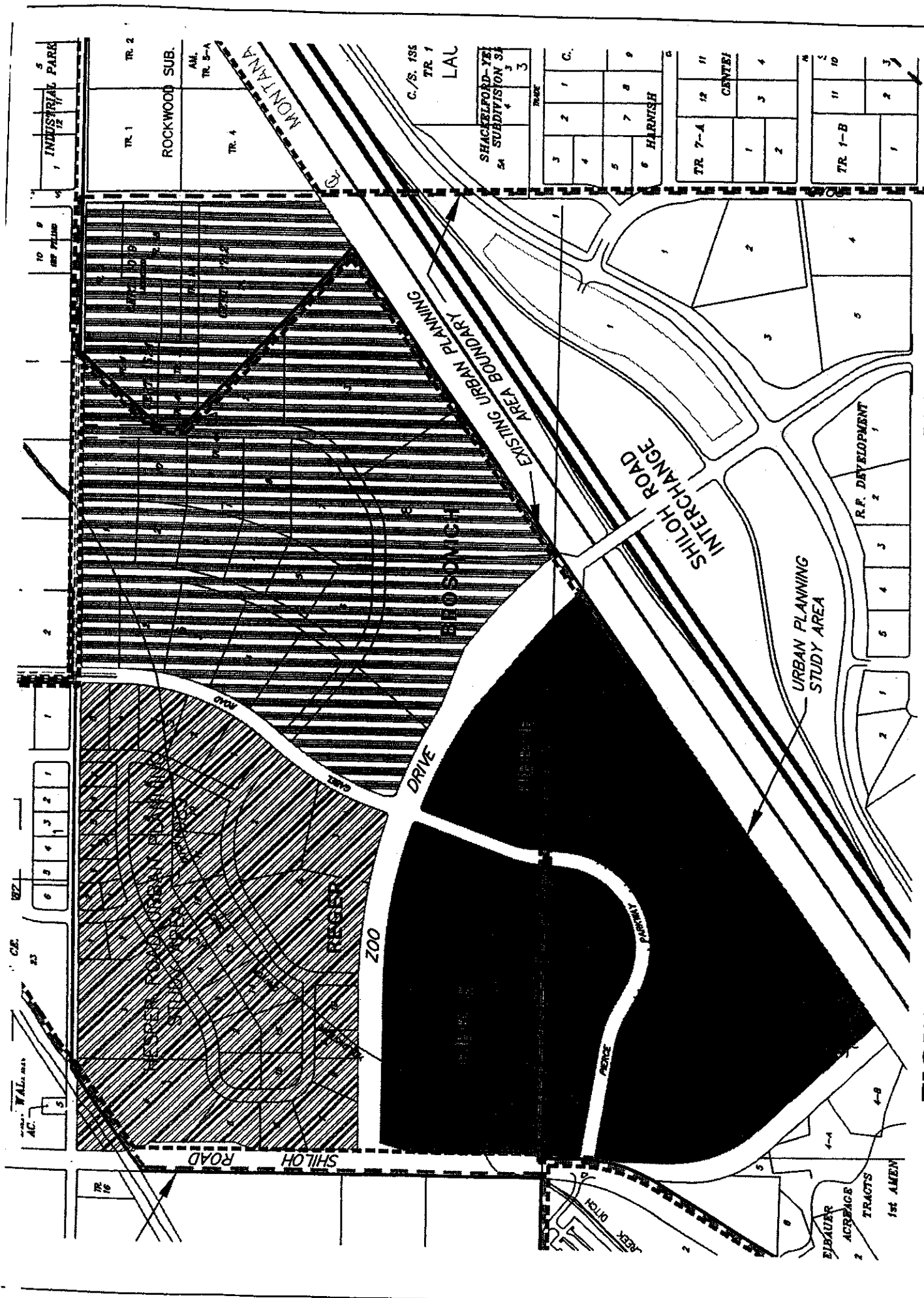
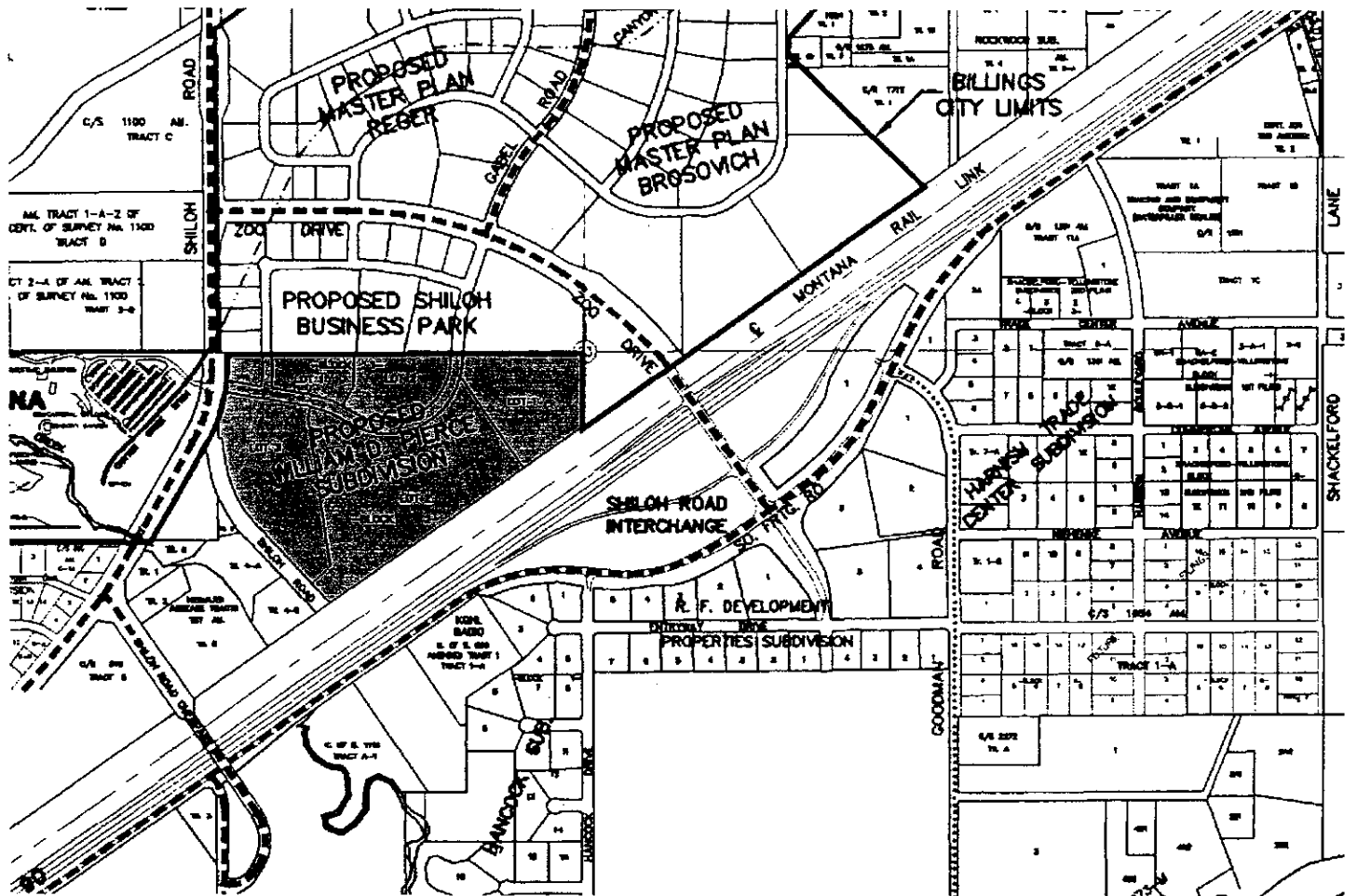

FIGURE 1: SUBJECT PROPERTIES AND LAYOUT

BAN ANNING UDY



William D. Pierce Subdivision

Billings, Montana • December 2000
February 2001 Revised