

RESOLUTION NO. 01- 17681

A RESOLUTION OF THE CITY OF BILLINGS APPROVING  
PETITIONS FOR ANNEXATION AND ANNEXING  
TERRITORY TO THE CITY.

WHEREAS, one hundred percent (100%) of the freeholders who constitute more than fifty percent (50%) of the resident freeholder electors have petitioned the City for annexation of the territory hereinafter described; and

WHEREAS, the territory was described in the Petition as required by law, and

WHEREAS, annexation of said territory would be in the best interest of the City.

NOW, THEREFORE, BE IT RESOLVED BY THE CITY COUNCIL OF THE CITY OF BILLINGS, MONTANA, AS FOLLOWS:

1. TERRITORY ANNEXED. Pursuant to Petition filed as provided M.C.A., Title 7, Chapter 2, Part 46, the following territory is hereby annexed to the City of Billings:

Lot 1, Block 1, Gabel Subdivision, 3<sup>rd</sup> filing.

(#01-04)

2. PROCEDURE. All procedures as required under M.C.A., Title 7, Chapter 2, Part 46, have been duly and properly followed and taken.

3. CONDITIONS OF APPROVAL. Annexation is approved subject to the following condition:

- (A) That prior to development of the site, including the issuance of any building permits, the following shall occur:
  - A Development Agreement be executed between the owner(s) and the City which shall stipulate specific infrastructure improvements, and provide guarantees for said improvements; or
  - If the property is subdivided, the required Subdivision Improvements Agreement (SIA) shall be approved and filed with the subdivision, and will stipulate specific infrastructure improvements and provide guarantees for such infrastructure improvements.
- (B) That all of South 32<sup>nd</sup> Street West adjacent to the subject property be annexed.

PASSED by the City Council and APPROVED this 12th day of March, 2001.



THE CITY OF BILLINGS:  
BY: Charles F. Tooley  
Charles F. Tooley, MAYOR

ATTEST:

BY: Marita Herold  
Marita Herold, CMC/AAE CITY CLERK

LONG AVENUE

SHILOH ROAD

HERSPER ROAD

SHILOH DRAIN

EXHIBIT

SHILOH DRAIN

SHILOH DRAIN

SHILOH DRAIN

SHILOH DRAIN

SHILOH DRAIN

SHILOH DRAIN

SHILOH DRAIN

SHILOH DRAIN

SHILOH DRAIN

SHILOH DRAIN

SHILOH DRAIN

SHILOH DRAIN

SHILOH DRAIN

SHILOH DRAIN

SHILOH DRAIN

SHILOH DRAIN

SHILOH DRAIN

SHILOH DRAIN



MONTANA SUBDIVISION  
SUBDIVISION  
RUBENSTEIN MONTANA  
BLOCK 1  
PAGE 1

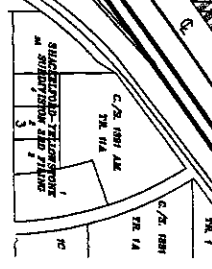
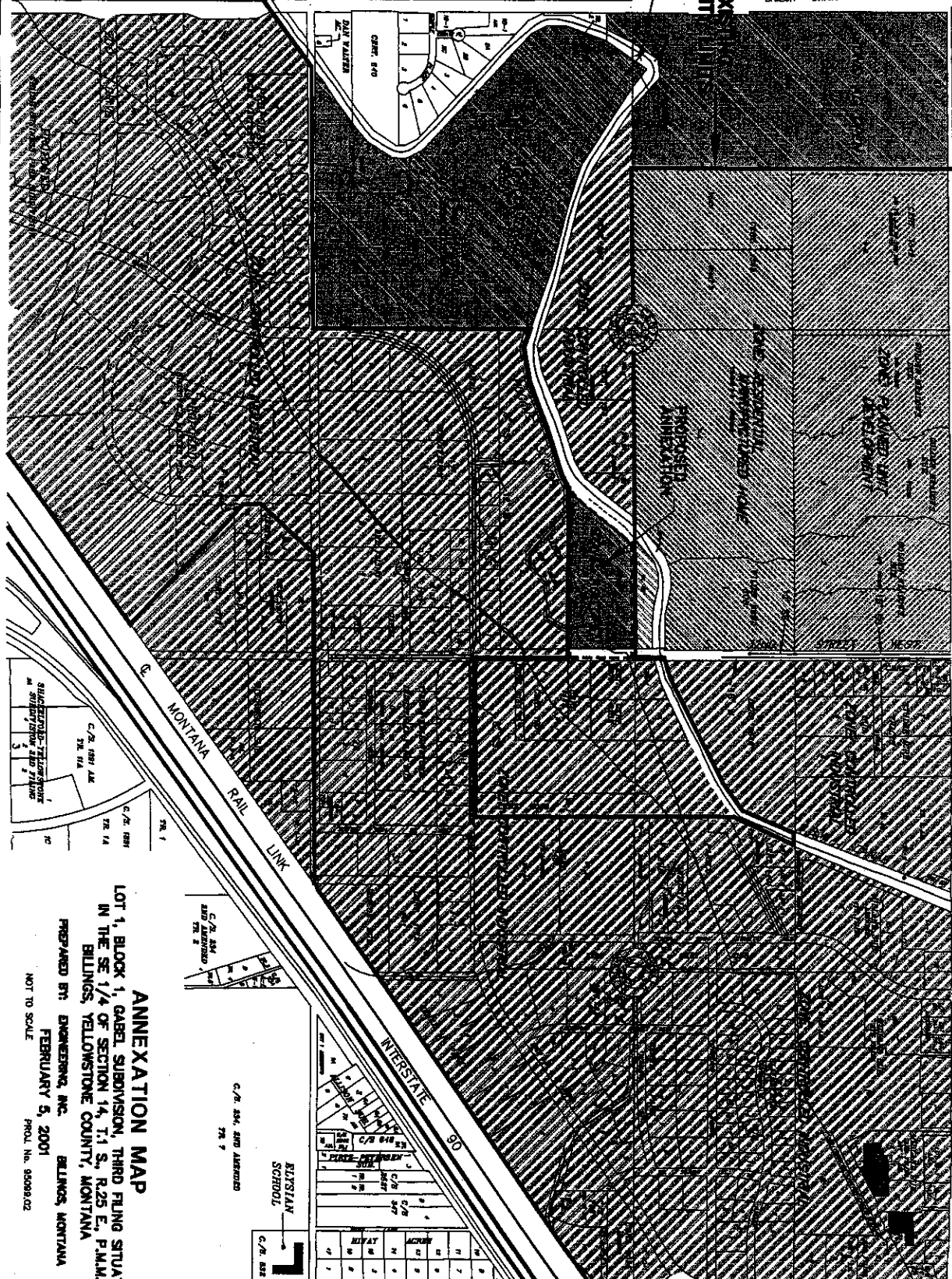
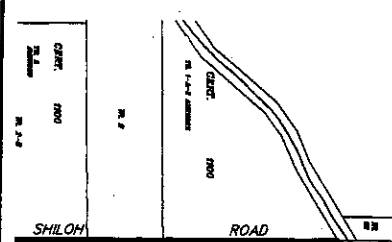

**ANNEXATION MAP**  
LOT 1, BLOCK 1, GABEL SUBDIVISION, THIRD FILING SITUATED  
IN THE SE 1/4 OF SECTION 14, T.1 S., R.25 E., P.M.M.  
BILLINGS, YELLOWSTONE COUNTY, MONTANA  
PREPARED BY: ENGINEERING, INC. BILLINGS, MONTANA  
FEBRUARY 5, 2001  
NOT TO SCALE  
PROJ. NO. 00099.02

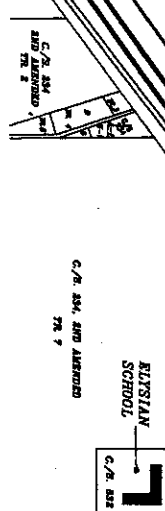

ELSTIAN SCHOOL

C/R 354	C/R 355	C/R 356	C/R 357	C/R 358	C/R 359	C/R 360	C/R 361	C/R 362	C/R 363	C/R 364	C/R 365	C/R 366	C/R 367	C/R 368	C/R 369	C/R 370	C/R 371	C/R 372	C/R 373	C/R 374	C/R 375	C/R 376	C/R 377	C/R 378	C/R 379	C/R 380	C/R 381	C/R 382	C/R 383	C/R 384	C/R 385	C/R 386	C/R 387	C/R 388	C/R 389	C/R 390	C/R 391	C/R 392	C/R 393	C/R 394	C/R 395	C/R 396	C/R 397	C/R 398	C/R 399	C/R 400
---------	---------	---------	---------	---------	---------	---------	---------	---------	---------	---------	---------	---------	---------	---------	---------	---------	---------	---------	---------	---------	---------	---------	---------	---------	---------	---------	---------	---------	---------	---------	---------	---------	---------	---------	---------	---------	---------	---------	---------	---------	---------	---------	---------	---------	---------	---------