

ORDINANCE NO. 98- 5050

AN ORDINANCE OF THE CITY OF BILLINGS, AMENDING BILLINGS MUNICIPAL CODE, CHAPTER 11, ELECTIONS, IN PARTICULAR, SECTION 11-102(c), WARD BOUNDARIES; AND CHANGING THE WARD BOUNDARIES ESTABLISHED THEREIN BY ADDING CERTAIN NEWLY ANNEXED REAL PROPERTY TO WARD II, PROVIDING FOR CERTIFICATION AND REPEALING OF ALL ORDINANCES AND RESOLUTIONS INCONSISTENT THEREWITH.

BE IT RESOLVED BY THE CITY COUNCIL OF THE CITY OF BILLINGS, MONTANA:

1. AMENDMENT. Pursuant to Billings Municipal Code, Section 1.16.030, and the State Law, Billings Municipal Code, Section 1.16.030 Ward Boundaries, is hereby amended by adding to the following designated Ward the following described real property:

WARD II:

C/S 2055, Tract 2;

Containing 21.675 acres, more or less. (#97-06)

2. CERTIFICATION. Pursuant to M.C.A. Section 13-3-103, the above change and alteration is hereby certified to the election administrator by the City Council, and the City Administrator or his designee is hereby directed to certify the changes and alterations and to deliver a map showing the boundaries of the ward, the streets, avenues and alleys by name, and the ward by number, to the election administrator not more than ten (10) days after the effective date of this ordinance.

3. REPEALER. All other ordinances, sections of the Billings Municipal Code and ordinances inconsistent herewith are hereby repealed.

PASSED by the City Council on the first reading this 12th. day of January, 1998.

PASSED, ADOPTED AND APPROVED on second reading this 26th. day of January, 1998.



THE CITY OF BILLINGS:

BY: Charles F. Tooley
Charles F. Tooley, MAYOR

ATTEST:

BY: Marita Herold
Marita Herold, CMC CITY CLERK

ANNEXATION MAP

ANNEXATION No. 97-06

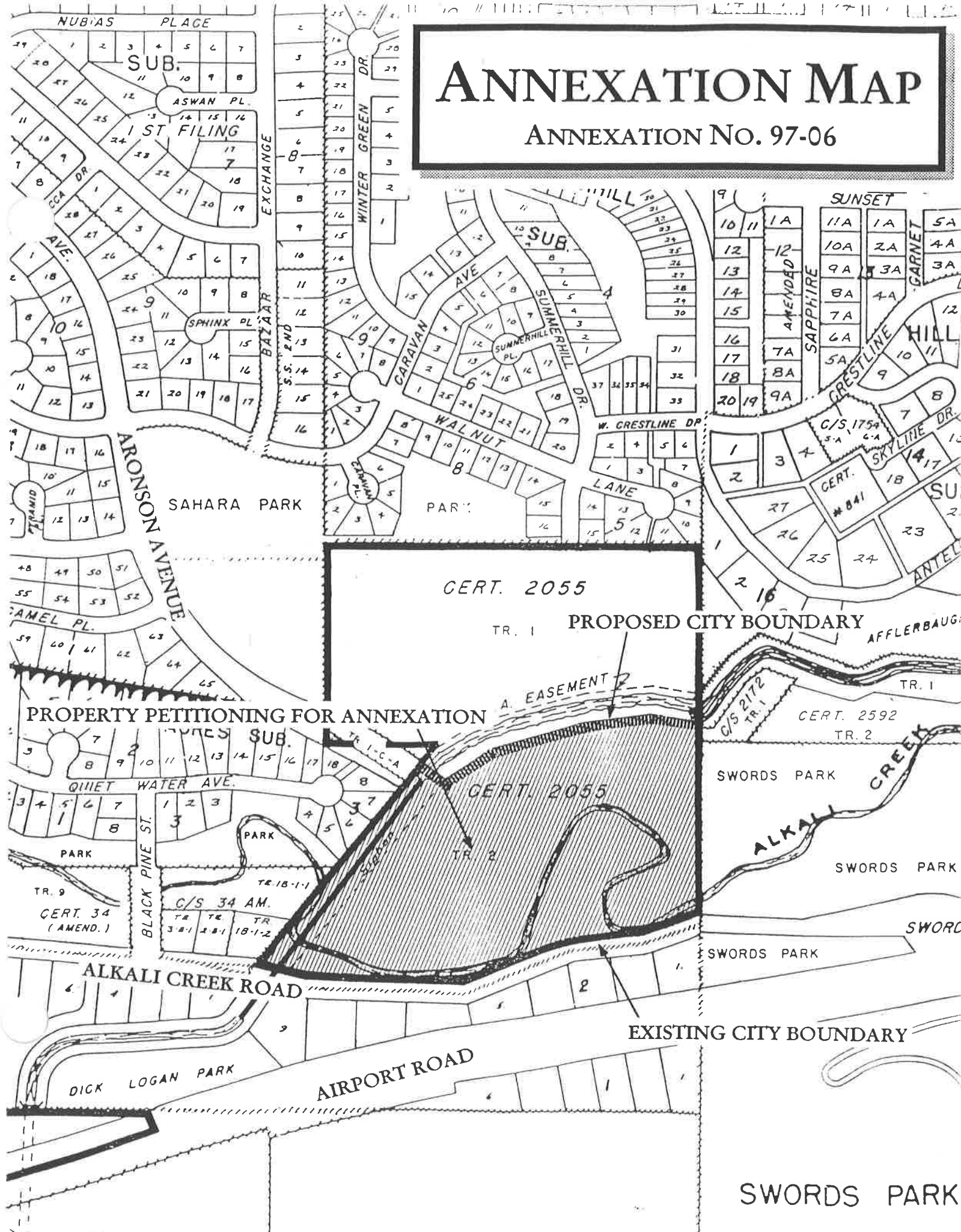

CERT. 2055

PROPOSED CITY BOUNDARY

PROPERTY PETITIONING FOR ANNEXATION

CERT. 2055

EXISTING CITY BOUNDARY

SWORDS PARK

NUBIAS PLACE
SUB.
ASWAN PL.
1ST FILING

EXCHANGE
WINTER GREEN DR.
SUNSET
SUNNERHILL PL.
SUMMERHILL DR.

SAHARA PARK
ARONSON AVENUE
W. CRESTLINE DR.
LANE

TR. 1
TR. 2
TR. 1
TR. 2
TR. 1
TR. 2
TR. 1
TR. 2

ALKALI CREEK ROAD
AIRPORT ROAD
DICK LOGAN PARK

CARAVAN AVE.
WALNUT

SUNSET
SUNNERHILL PL.
SUMMERHILL DR.

W. CRESTLINE DR.
LANE

SUNSET
SUNNERHILL PL.
SUMMERHILL DR.

SUNSET
SUNNERHILL PL.
SUMMERHILL DR.

TR. 1
TR. 2
TR. 1
TR. 2
TR. 1
TR. 2

TR. 1
TR. 2
TR. 1
TR. 2
TR. 1
TR. 2

TR. 1
TR. 2
TR. 1
TR. 2
TR. 1
TR. 2

TR. 1
TR. 2
TR. 1
TR. 2
TR. 1
TR. 2

TR. 1
TR. 2
TR. 1
TR. 2
TR. 1
TR. 2

TR. 1
TR. 2
TR. 1
TR. 2
TR. 1
TR. 2

TR. 1
TR. 2
TR. 1
TR. 2
TR. 1
TR. 2

TR. 1
TR. 2
TR. 1
TR. 2
TR. 1
TR. 2

TR. 1
TR. 2
TR. 1
TR. 2
TR. 1
TR. 2

TR. 1
TR. 2
TR. 1
TR. 2
TR. 1
TR. 2