

**BUILDING ROOFING PROJECT for CITY OF BILLINGS MET TRANSIT
Addendum #2**

**This addendum must be acknowledged below and included with your proposal documents which
are due no later than 2:00 pm on Feb 26, 2019.**

It has come to the City of Billings attention that the published bid packet does not include sufficient information to for interested parties to provide a complete and accurate bid, therefore the following structural diagrams and related documents are being provided. Please review the attached documentation and indicate your review by signing below.

Company Name

Date

Contact Name (please print)

Title

Signature of Contact Position

ROOF INSPECTION WORKSHEET

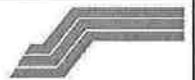

BRADFORD
ROOF MANAGEMENT

DATE : 12/1/16

BUILDING NAME : MET BUS

INSPECTOR : SLS

ADDRESS : 1705 MONAD RD

SECTION : B

BUILDING NUMBER : 001

AREA : 8281 SQ FT

BF - BASEFLASHING
CF - COUNTERFLASHING
DR - DRAINS
EJ - EXPANSION JOINTS
EJC - EXPN. JOINT CURBS
EM - EDGE METAL

EQ - EQUIPMENT
GN - GENERAL CODES
GT - GUTTER/DOWNSPOUTS
MB - MEMBRANE
MC - METAL CAP
MS - MASONRY

PN - PITCH PANS
PP - PIPE PENETRATIONS
PT - PAINTING
RG - RECLET
SC - SCUPPERS
SF - ROOF SURFACING

SL - SKYLIGHTS
SM - SEAMS
VP - SHEET METAL VENTS

IDENT #	PHASE TYPE	PHASE #	QUANTITY OF WORK
1	RG	1	110
2	BF	1	1
3	VP	2	20

SCALE : 1" = _____

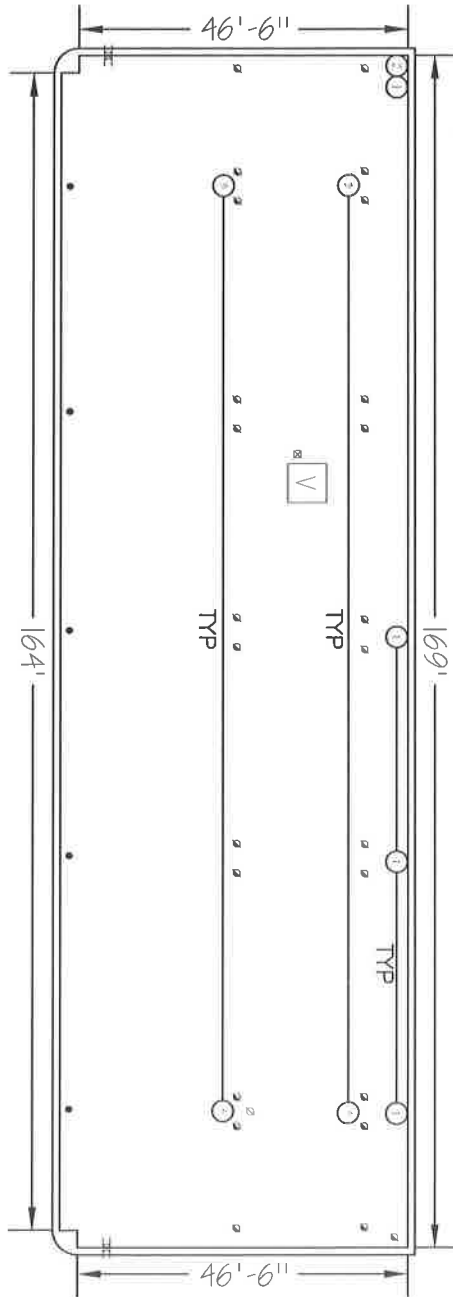

NORTH

© Copyright 2016
Bradford Roof Management.

ROOF INVENTORY

Site	MET BUS	Met Bus	Owner	City Of Billings	
Section	B	MET BUS	Building Use	Garage	
Building	001		Existing Roof Installation	1998	Approx
Area	8,281	SQFT	Reroof Year		
Inspector	SLS		Reroof Cost		
			Cost/s.f.		

Roof Section Access Accessed from adjacent section D

Existing Roof Profile

Type	Flat Roof	Slope	Uniform	0.250 inches/foot
Roof Deck	Steel	Overlay	No	
Wet Cuts	No	Dry Cuts	No	

Vapor Retarder

No Vapor Retarder Installed

Insulation Breakdown

Total R-Value 37.90

Board Stock	Tapered	Thickness	R-Value	Attachment
Expanded Polystyrene	Yes	9.50	36.58	Loose Laid
Wood Fiberboard	No	0.50	1.32	Mechanically Attached
Board Stock Totals		10.00	37.90	

InsulationFills	Tapered	Thickness	R-Value
No Insulating Fill Installed	No	0.50	0.00
Insulating Fills Totals		0.50	0.00

ROOF INVENTORY

Membrane

Plies	1			
Attachment	Loose Ballasted			
Class	Vulcanized Elastomers: EPDM, Neoprene			
Type	EPDM- Ethylene, Propylene, Diene Monomer			
Reinforcement	None - No Reinforcement	Warranty	Warranty Number	Exp. Date
Manufacturer		Unknown		
Contractor		Unknown		
Surface Type	River Gravel			

Flushed Penetrations Information

Roof Penetrations	Description	Amount
	Sheet Metal Furnace Flues	25
	Plumbing Vents	1

Flashing Information

Base Flashing	Description	Amount
	EPDM	
Coping	Description	Amount
	Cap	267
Coping Material	Description	Amount
	Kynar Coated Galvanized	
Counter Flashing	Description	Amount
	Metal	169
Counter Material	Description	Amount
	Kynar Coated Galvanized	
Edge Material	Description	Amount
	No Roof Edge Material Installed	
Edge Metal	Description	Amount
	None	
Expansion Joints	Description	Amount
	None	
Flashing Adhesive	Description	Amount

ROOF INVENTORY

Flashing Adhesive	Description	Amount
	Bonding Adhesive	

Reglet	Description	Amount
	None	0

RI Base Flashing	Description	Amount
	Curb Flashing	22
	Parapet Flashing	267
	Wall Flashing	169

Structural Delineations	Description	Amount
	None	

Miscellaneous Equipment

Drain	Description	Amount
	Interior Bowl Drains	5

Gutter	Description	Amount
	None	0

Pipe Support	Description	Amount
	None	

Walkway	Description	Amount
	No Walkways Installed	

Miscellaneous Information

Equipment Support	Description	Amount
	Curbs (Boxed)	

ROOF INSPECTION WORKSHEET

DATE : 12/1/16



BUILDING NAME : MET BUS

INSPECTOR : SLS

ADDRESS : 1705 MONAD RD

SECTION : C

BUILDING NUMBER : 001

AREA : 12,307 Sq.Ft

- | | | | |
|-------------------------|------------------------|------------------------|------------------------|
| BF - BASEFLASHING | EQ - EQUIPMENT | PN - PITCH PANS | SL - SKYLIGHTS |
| CF - COUNTERFLASHING | GN - GENERAL CODES | PP - PIPE PENETRATIONS | SM - SEAMS |
| DR - DRAINS | GT - GUTTER/DOWNSPOUTS | PT - PAINTING | VP - SHEET METAL VENTS |
| EJ - EXPANSION JOINTS | MB - MEMBRANE | RG - REGLET | |
| EJC - EXPN. JOINT CURBS | MC - METAL CAP | SC - SCUPPERS | |
| EM - EDGE METAL | MS - MASONRY | SF - ROOF SURFACING | |

IDENT #	PHASE TYPE	PHASE #	QUANTITY OF WORK
1	BF	2	300
2	BF	3	14
3	BF	1	1

SCALE : _____

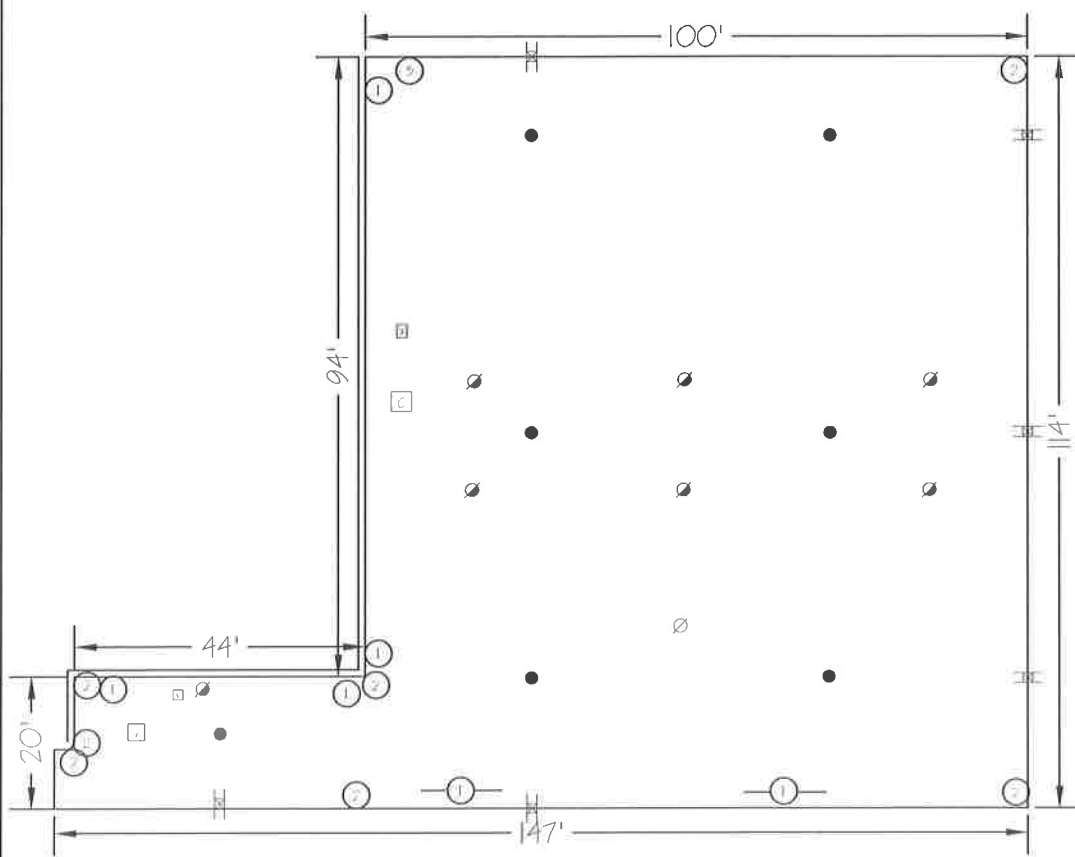

ROOF INVENTORY

Site	MET BUS	Met Bus	Owner	City Of Billings	
Section	C	MET BUS	Building Use	Garage	
Building	001		Existing Roof Installation	1998	Approx
Area	12,307	SQFT	Reroof Year		
Inspector	SLS		Reroof Cost		
			Cost/s.f.		

Roof Section Access Accessed from adjacent section D

Existing Roof Profile

Type	Flat Roof	Slope	Uniform	0.250 inches/foot
Roof Deck	Steel	Overlay	No	
Wet Cuts	No	Dry Cuts	Yes	

Vapor Retarder

No Vapor Retarder Installed

Insulation Breakdown

Total R-Value 9.02

Board Stock	Tapered	Thickness	R-Value	Attachment
Wood Fiberboard	No	0.50	1.32	Mechanically Attached
Expanded Polystyrene	No	2.00	7.70	Loose Laid
Board Stock Totals		2.50	9.02	

InsulationFills	Tapered	Thickness	R-Value
No Insulating Fill Installed	No	0.50	0.00
Insulating Fills Totals		0.50	0.00

ROOF INVENTORY

Membrane

Plies	1			
Attachment	Loose Ballasted			
Class	Vulcanized Elastomers: EPDM, Neoprene			
Type	EPDM- Ethylene, Propylene, Diene Monomer			
Reinforcement	None - No Reinforcement	Warranty	Warranty Number	Exp. Date
Manufacturer		Unknown		
Contractor		Unknown		
Surface Type	River Gravel			

Flashed Penetrations Information

Roof Penetrations	Description	Amount
	Sheet Metal Furnace Flues	7
	Plumbing Vents	1

Flashing Information

Base Flashing	Description	Amount
	EPDM	
Coping	Description	Amount
	Cap	13
Coping Material	Description	Amount
	Kynar Coated Galvanized	
Counter Flashing	Description	Amount
	None	
Edge Material	Description	Amount
	Kynar Coated Galvanized	
Edge Metal	Description	Amount
	Raised Embedded Edge Metal	370
Expansion Joints	Description	Amount
	None	
Flashing Adhesive	Description	Amount
	Bonding Adhesive	
Reglet	Description	Amount

ROOF INVENTORY

Reglet	Description	Amount
	None	0

RI BaseFlashing	Description	Amount
	Curb Flashing	35
	Wall Flashing	13
	Parapet Flashing	138

Structural Delineations	Description	Amount
	None	

Miscellaneous Equipment

Drain	Description	Amount
	Overflow Scuppers	6
	Interior Bowl Drains	7

Gutter	Description	Amount
	None	0

Pipe Support	Description	Amount
	None	

Walkway	Description	Amount
	No Walkways Installed	

Miscellaneous Information

Equipment Support	Description	Amount
	Curbs (Boxed)	

ROOF INSPECTION WORKSHEET

DATE: 12/1/16



BUILDING NAME: MET BLIS

INSPECTOR: SL5

ADDRESS: 1705 MONAD RD

SECTION: D

BUILDING NUMBER: OOI

AREA: 3130 SQ FT

BF - BASEFLASHING	EQ - EQUIPMENT	PN - PITCH PANS	SL - SKYLIGHTS
CF - COUNTERFLASHING	GN - GENERAL NOTES	PP - PIPE PENETRATIONS	SM - SEAMS
DR - DRAINS	GT - GUTTER/ DOWNSPOUTS	PT - PAINTING	VP - SHEET METAL VENTS
EJ - EXPANSION JOINTS	MB - MEMBRANE	RG - REGLET	
EJC - EXPN. JOINT CURBS	MC - METAL CAP	SC - SCUPPERS	
EM - EDGE METAL	MS - MASONRY	SF - ROOF SURFACING	

IDENT #	PHASE TYPE	PHASE #	QUANTITY OF WORK
1	BF	1	2
2	GT	8	2
3	SF	3	2

SCALE: 1" = 16'

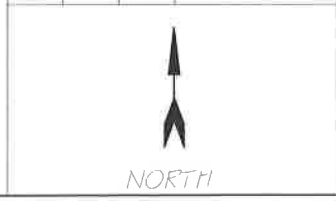
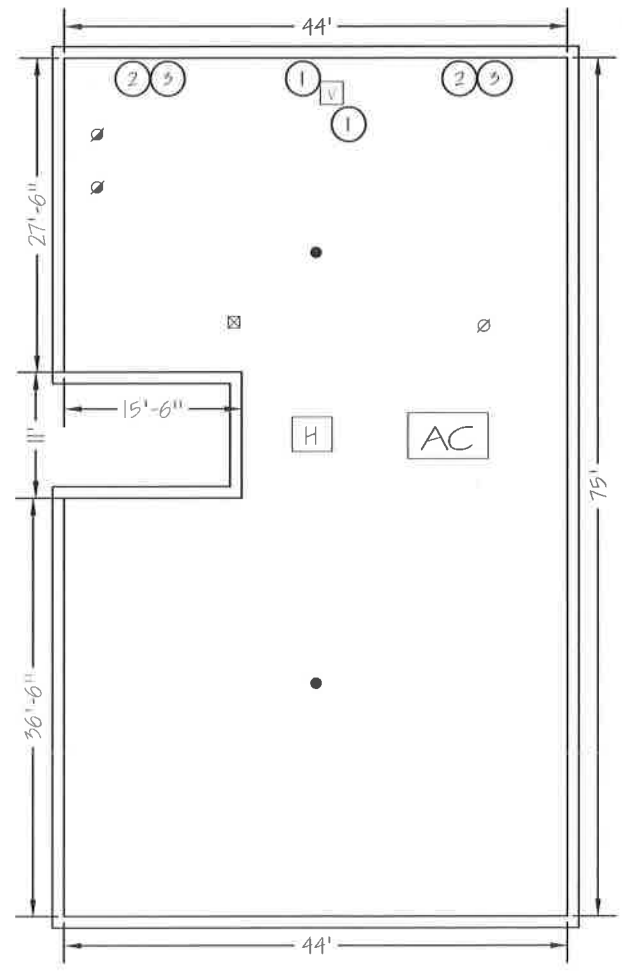

ROOF INVENTORY

Site	MET BUS	Met Bus	Owner	City Of Billings
Section	D	MET BUS	Building Use	Office \ Bank \ Financial Institution
Building	001		Existing Roof Installation	1998 Approx
Area	3,130	SQFT	Reroof Year	
Inspector	SLS		Reroof Cost	
			Cost/s.f.	

Roof Section Access Internal ladder:permanent

Existing Roof Profile

Type	Flat Roof	Slope	Uniform 0.250 inches/foot
Roof Deck	Steel	Overlay	No
Wet Cuts	No	Dry Cuts	No

Vapor Retarder

No Vapor Retarder Installed

Insulation Breakdown

Total R-Value 37.90

Board Stock	Tapered	Thickness	R-Value	Attachment
Wood Fiberboard	No	0.50	1.32	Mechanically Attached
Expanded Polystyrene	No	9.50	36.58	Loose Laid
Board Stock Totals		10.00	37.90	

InsulationFills	Tapered	Thickness	R-Value
No Insulating Fill Installed	No	0.50	0.00
Insulating Fills Totals		0.50	0.00

ROOF INVENTORY

Membrane

Plies 1
Attachment Loose Ballasted
Class Vulcanized Elastomers: EPDM, Neoprene
Type EPDM- Ethylene, Propylene, Diene Monomer
Reinforcement None - No Reinforcement **Warranty** **Warranty Number** **Exp. Date**
Manufacturer Unknown
Contractor Unknown
Surface Type River Gravel

Flashed Penetrations Information

Roof Penetrations	Description	Amount
	Sheet Metal Furnace Flues	2
	Pitch Pans	1
	Plumbing Vents	1

Flashing Information

Base Flashing	Description	Amount
	EPDM	
Coping	Description	Amount
	None	
Counter Flashing	Description	Amount
	Metal	150
Counter Material	Description	Amount
	Kynar Coated Galvanized	
Edge Material	Description	Amount
	No Roof Edge Material Installed	
Edge Metal	Description	Amount
	None	
Expansion Joints	Description	Amount
	None	
Flashing Adhesive	Description	Amount

ROOF INVENTORY

Flashing Adhesive	Description	Amount
	Bonding Adhesive	

Reglet	Description	Amount
	None	0

RI Base Flashing	Description	Amount
	Wall Flashing	150
	Parapet Flashing	119
	Curb Flashing	43

Structural Definitions	Description	Amount
	None	

Miscellaneous Equipment

Drain	Description	Amount
	Interior Bowl Drains	2

Gutter	Description	Amount
	None	0

Pipe Support	Description	Amount
	None	

Walkway	Description	Amount
	No Walkways Installed	

Miscellaneous Information

Equipment Support	Description	Amount
	Curbs (Boxed)	