

RESOLUTION NUMBER 05-18286

A RESOLUTION TO EXPAND THE BOUNDARIES OF EXTENDED SPECIAL IMPROVEMENT MAINTENANCE DISTRICT NO. 4005 FOR THE PURPOSE OF MAINTAINING THE EXISTING AND FUTURE PARK IMPROVEMENTS IN HIGH SIERRA SUBDIVISION, FIRST FILING TO INCLUDE HIGH SIERRA SUBDIVISION, THIRD AND FOURTH FILINGS.

WHEREAS, City Council of Billings, Montana hereby finds, determines and declares that:

1. The public interest and convenience require expanding the boundaries of Extended Special Improvement Maintenance District No. 4005 created by *Resolution 86-15207 on January 27th, 1986*.
2. All lands are benefited and no lands that are not benefited have been included within the district. All lands within the district will be enhanced in value to the extent of the assessments to be levied upon such lands, and all lands included within the district should be assessed accordingly to pay the cost and expenses of the district.

NOW, THEREFORE, BE IT RESOLVED BY THE CITY COUNCIL OF THE CITY OF BILLINGS:

1. *Jurisdiction and Creation:* Extended Special Improvement Maintenance District No.4005 is of more than local or ordinary public benefit. The Council has acquired jurisdiction to order the improvements and it does hereby expand the boundaries of Extended Special Improvement Maintenance District No. 4005. All lands included in the expanded boundaries of Extended Special Improvement Maintenance District No. 4005 are benefited and no lands that are not benefited have been included in said district.
2. *General Character of Improvements and Maintenance:* The general character of the improvements to be maintained is as follows: landscaping, trees, irrigation systems, irrigation system water services, and other park equipment and improvements installed by the developer and as part of a future Special Improvement District.
3. *Boundaries:* The boundaries of the district are described and designated on Exhibit "A" attached hereto.
4. *Maintenance Estimate:* The estimated cost of the proposed expansion maintenance for the current year shall be \$0.00545 per square foot of lot area as described in the Maintenance Estimate attached hereto as Exhibit "D".
5. *Assessment Method:* All of the costs and expenses of the district will be assessed against the entire district, and each lot or parcel of land within the district will be assessed for that part of the whole cost which its assessable area bears to the total assessable area in the entire district, exclusive of streets, avenues, alleys and public places. Assessments for each lot during the current year will be approximately \$0.00545 per square foot of lot area. In accordance with 7-1-1479 MCA, the assessment for each lot in each ensuing year will be set by the City Council by resolution.
6. *Payment of Assessment:* The assessments for all maintenance and costs of the district shall be paid in equal annual installments, provided that the payment of one-half of said annual assessment may be deferred to May 31st of the year following the assessment. All money derived from the collection of said assessments otherwise shall constitute the existing fund known as Fund of Special Improvement Maintenance District No. 4005.
7. *Bonds for Improvements:* There will be no bonds sold for this district as it is for maintenance only.
8. *Engineering:* No engineering will be required for the maintenance of the district.
9. *District Accounts:* The Director of Finance is hereby authorized and directed to establish the necessary accounts to govern the receiving of all revenues and the expenditures of the same district.

PASSED AND APPROVED by the City Council of the City of Billings, Montana this 13th day of June, 2005.



CITY OF BILLINGS

By: Charles F. Tooley
Charles F. Tooley Mayor

ATTEST:

By: Marita Herold
Marita Herold, CMC/AE City Clerk

EXPANDED PARK MAINTENANCE DISTRICT # 4005

HIGH SIERRA SUBDIVISION
FIRST, THIRD, & FOURTH FILINGS
BILLINGS, MONTANA

PREPARED BY : ENGINEERING, INC.
SCALE : 1" = 200'

MARCH, 2005
BILLINGS, MONTANA

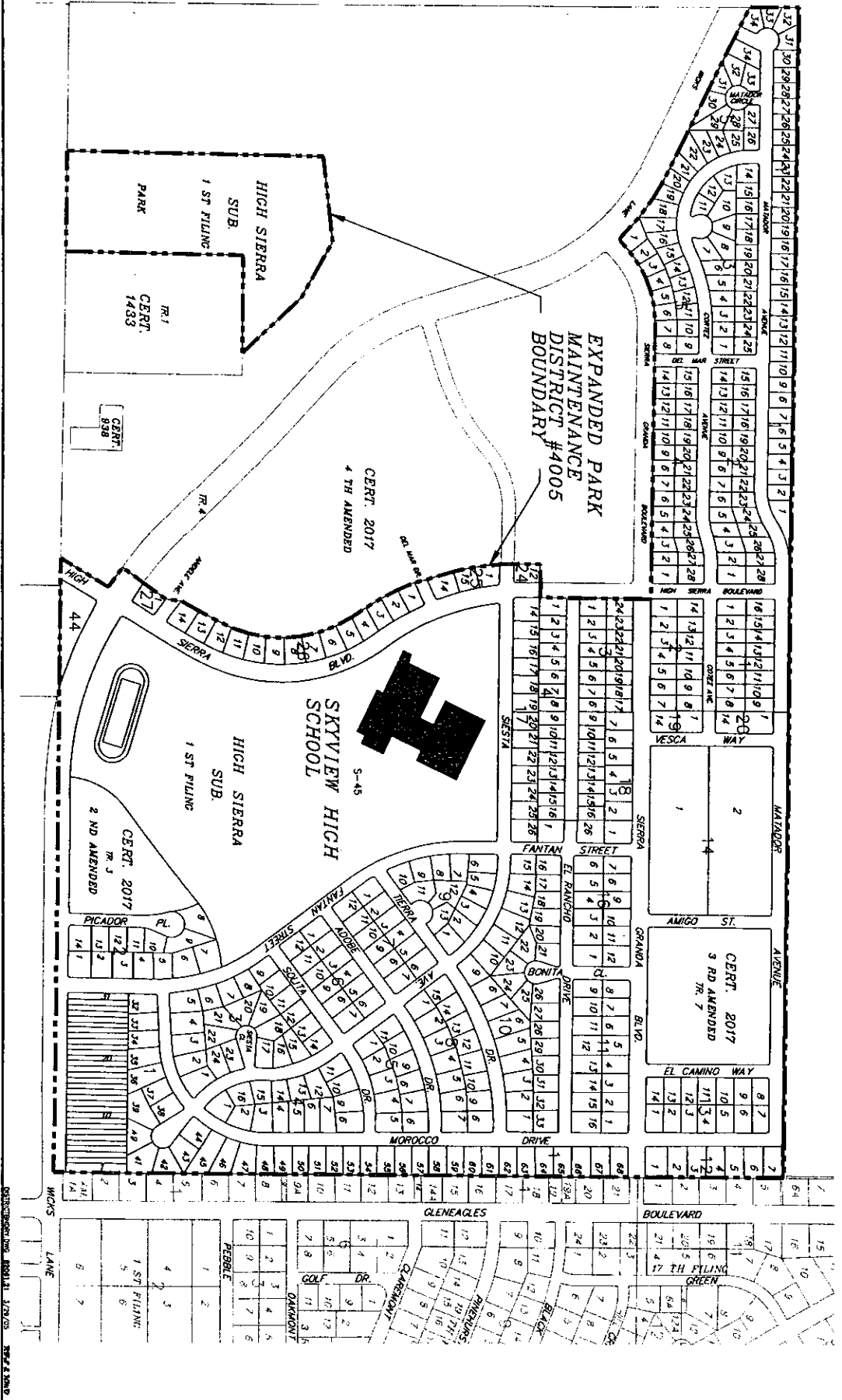

DATE OF RECORDING: 03/17/2005 09:42:00 AM

EXHIBIT "B"

BOUNDARY DESCRIPTION EXPANDED PARK MAINTENANCE DISTRICT No. 4005 HIGH SIERRA SUBDIVISION, FIRST, THIRD AND FOURTH FILINGS PARK MAINTENANCE DISTRICT

Meets and Bounds Description:

Beginning at a point which is the south $\frac{1}{4}$ corner of Section 17, T. 1 N., R. 26 E., P.M.M.;

thence, from said point of beginning, WEST a distance of 116.42 feet;

thence N 30°29'36" E a distance of 225.93 feet;

thence along a curve to the left with a radius of 20.00 feet a distance of 30.76 feet;

thence along a curve to the right with a radius of 1813.10 feet a distance of 92.70 feet;

thence N 35°17'54" E a distance of 250.00 feet;

thence N 05°44'30" E a distance of 69.42 feet;

thence N 30°29'36" E a distance of 124.41 feet;

thence N 28°22'07" E a distance of 47.45 feet;

thence N 22°34'41" E a distance of 81.84 feet;

thence N 15°14'46" E a distance of 81.84 feet;

thence N 07°54'50" E a distance of 81.84 feet;

thence N 00°34'55" E a distance of 81.84 feet;

thence N 06°45'01" W a distance of 81.84 feet;

thence N 14°04'56" W a distance of 81.84 feet;

thence N 21°24'52" W a distance of 81.84 feet;

thence N 28°06'06" W a distance of 67.47 feet;

thence N 31°07'24" W a distance of 350.10 feet;

thence N 07°18'52" W a distance of 63.16 feet;

thence N 24°46'44" W a distance of 128.19 feet;
thence N 11°21'18" W a distance of 98.30 feet;
thence N 00°03'48" E a distance of 120.00 feet;
thence N 05°55'12" W a distance of 60.33 feet;
thence N 00°03'48" E a distance of 120.00 feet;
thence S 89°56'12" E a distance of 170.00 feet;
thence N 00°19'30" W a distance of 500.62 feet;
thence N 89°56'12" W a distance of 1244.49 feet;
thence along a curve to the left with a radius of 510.00 feet a distance of 375.46 feet;
thence S 47°52'57" W a distance of 47.28 feet;
thence N 88°19'43" W a distance of 14.45 feet;
thence along a non-tangent curve to the left with a radius of 1060.00 feet a distance of 355.07 feet;
thence N 64°00'50" W a distance of 853.72 feet;
thence N 00°11'23" W a distance of 206.65 feet;
thence S 89°55'15" E a distance of 5297.18 feet;
thence S 00°27'40" E a distance of 570.33 feet;
thence N 89°56'12" W a distance of 25.00 feet;
thence S 00°27'40" E a distance of 50.00 feet;
thence S 89°56'12" E a distance of 25.00 feet;
thence S 00°27'40" E a distance of 2681.32 feet;
thence WEST a distance of 2656.39 feet to the point of beginning.

AND

Beginning at a point which is situated WEST a distance of 1522.94 feet from the S1/4 corner of Section 17, T. 1 N., R. 26 E., P.M.M.;

thence, from said point of beginning, WEST a distance of 441.05 feet;

thence NORTH a distance of 1168.23 feet;

thence N 80°38'26" E a distance of 200.92 feet;

thence along a curve to the right with a radius of 1191.12 feet a distance of 174.82 feet;

thence S 60°57'46" E a distance of 290.07 feet;

thence S 43°49'51" E a distance of 382.33 feet;

thence WEST a distance of 449.54 feet;

thence SOUTH a distance of 800.00 feet to the point of beginning.

EXHIBIT "C"

**OWNERSHIP RECORDS
PARK MAINTENANCE DISTRICT No. 4005
HIGH SIERRA SUBDIVISION
EXTENDED PARK MAINTENANCE DISTRICT**

*Corrected
Ownership*

*Certified true & correct
3/23
Dept. of Rev. Rec.*

Ranges: TAX YEAR: (R) 2005 - 2005
 ASSESSOR#: (L) A22221, A22222, A27036,
 A27037, A27038, A27044, A27045,
 A27046, A27047, A27054, A27091,
 A27092, A30249, A30250, A31300,
 A31301, A31301, A31307, A31308,
 A31309, A31310, A31311, A31312,
 A31313, A31314, D05245C
 TAX TYPE: (A)
 LEVY DISTRICT: (A)
 SUB-LEVY DIST: (A)
 SPECIAL DISTRICT: (A)

OPTIONS: SORT ORDER: N # OF COPIES: 1

Assessor#	Owner/Mailing Address	Legal Description	Levy Sub Tax Dist Dist Type Key #1
D05245C	BILLINGS SCHOOL DISTRICT # 2 ✓ 415 N 30TH ST BILLINGS MT 59101-1252	03-1033-17-1-05-01-0000 C OF S 2017 TR 5 AMNDTR 7 17 LN 26	2 RE
A27054	BILLINGS SCHOOL DISTRICT #2 ✓ 415 N 30TH ST BILLINGS MT 59101-1252	03-1033-17-1-03-21-0000 HS1 SubDivision HS1 LT 2 BLK 14 HIGH SIERRA SUBD 1ST FILING	2 RE
A31307	BULLARD, MICHAEL J & JEANNIE M ✓ 1108 MATADOR AVENUE ✓ BILLINGS MT 59101-2048	03-1033-17-1-20-17-0000 HS3 SubDivision HS3 LT 9 BLK 1 HIGH SIERRA SUB 3RD FILING AMD LT 1 BLK 2 HIGH SIERRA SUB 2ND FIL 8116 SF (OLD A30250) (05)	2 RE
A31308	DAWSON BUILDERS INC ✓ 4736 S WOODHAVEN WAY ✓ BILLINGS MT 59106-2494 <i>Hanson, Dustin D ✓ Sylvia M ✓ 1126 Matador Ave Blgs MT 59105</i>	03-1033-17-1-20-19-0000 HS3 SubDivision HS3 LT 10 BLK 1 HIGH SIERRA SUB 3RD FILING AMD LT 1 BLK 2 HIGH SIERRA SUB 2ND FIL 8117 SF (OLD A30250) (05)	2 RE
A31311	DAWSON BUILDERS INC ✓ 4736 S WOODHAVEN WAY BILLINGS MT 59106-2494	03-1033-17-1-20-25-0000 HS3 SubDivision HS3 LT 13 BLK 1 HIGH SIERRA SUB 3RD FILING AMD LT 1 BLK 2 HIGH SIERRA SUB 2ND FIL 8120 SF (OLD A30250) (05)	2 RE
A31313	HIGH SIERRA DEVELOPMENT ✓ 175 N 27TH ST STE 940 BILLINGS MT 59101-2048	03-1033-17-1-20-29-0000 HS3 SubDivision HS3 LT 15 BLK 1 HIGH SIERRA SUB 3RD FILING AMD LT 1 BLK 2 HIGH SIERRA SUB 2ND FIL 8096 SF (OLD A30250) (05)	2 RE
A31300	HIGH SIERRA DEVELOPMENT ✓ 175 N 27TH ST STE 940 BILLINGS MT 59101-2048	03-1033-17-1-20-03-0000 HS3 SubDivision HS3 LT 2 BLK 1 HIGH SIERRA SUB 3RD FILING	2 RE

*Pope, Carey
Pope, Sheri
1162 Matador
Blgs, MT 59105*

Assessor#	Owner/Mailing Address	Legal Description	Levy Sub Tax	Dist Dist Type Key #1
		AMD LT 1 BLK 2 HIGH SIERRA SUB 2ND FIL 8034 SF (OLD A30250) (05)		
A31301	HIGH SIERRA DEVELOPMENT ✓ 175 N 27TH ST STE 940 BILLINGS MT 59101-2048	03-1033-17-1-20-05-0000 HS3 SubDivision HS3 LT 3 BLK 1 HIGH SIERRA SUB 3RD FILING AMD LT 1 BLK 2 HIGH SIERRA SUB 2ND FIL 8060 SF (OLD A30250) (05)	2	RE Hardmeyer, O 1027 Victory Av Blgo mt 59105
A30250	HIGH SIERRA DEVELOPMENT LLC ✓ 175 N 27TH ST STE 940 BILLINGS MT 59101-2048	03-1033-17-1-20-01-0000 HS3 SubDivision HS3 LT 1 BLK 1 HIGH SIERRA SUB 3RD FILING AMD LT 1 BLK 2 HIGH SIERRA 2ND FILING 9563 SF (05)	2	RE OAKland Home Builders Corp 175 N 27th #90 Blgo mt 5910
A30249	HIGH SIERRA II INC ✓ 175 N 27TH ST STE 940 BILLINGS MT 59101-2048	03-1033-17-2-01-01-0000 HS2 SubDivision HS2 LT 1 BLK 1 HIGH SIERRA SUB 2ND FILING 34.024 AC (OLD #D05245B) (03)	2	RE
A22322	HILL, RON S LIVING TRUST ✓ PO BOX 50636 BILLINGS MT 59105-0636	03-1033-16-7-01-05-0000 L17 SubDivision L17 LT 5 BLK 17 LAKE HILLS SUBD 17TH FILING	2	RE
A22321	HILL, RON S LIVING TRUST ✓ PO BOX 50636 BILLINGS MT 59105-0636	03-1033-16-7-01-04-0000 L17 SubDivision L17 LT 4 BLK 17 LAKE HILLS SUBD 17TH FILING	2	RE
A31310	WARNER, SHANNON L ✓ JOHNSON, BRAD J & ✓ 1144 MATADOR AVE BILLINGS MT 59105-5433	03-1033-17-1-20-23-0000 HS3 SubDivision HS3 LT 12 BLK 1 HIGH SIERRA SUB 3RD FILING AMD LT 1 BLK 2 HIGH SIERRA SUB 2ND FIL 8119 SF (OLD A30250) (05)	2	RE
A31314	LOWENSTEIN, JEFFREY J & KOREEN M ✓ 1196 MATADOR AVE BILLINGS MT 59105-5433	03-1033-17-1-20-31-0000 HS3 SubDivision HS3 LT 16 BLK 1 HIGH SIERRA SUB 3RD FILING AMD LT 1 BLK 2 HIGH SIERRA SUB 2ND FIL 9753 SF (OLD A30250) (05)	2	RE
A27091	LYNDES, JAY C ✓ 600 INDIAN TRL BILLINGS MT 59105-2702	03-1033-17-1-11-27-0000 HS1 SubDivision HS1 LT 1 BLK 20 HIGH SIERRA SUBD 1ST FILING	2	RE
A27092	LYNDES, JAY C ✓ 600 INDIAN TRL BILLINGS MT 59105-2702	03-1033-17-1-11-01-0000 HS1 SubDivision HS1 LT 14 BLK 20 HIGH SIERRA SUBD 1ST FILING	2	RE
A27047	LYNDES, JAY C ✓ 600 INDIAN TRL BILLINGS MT 59105-2702	03-1033-17-1-07-17-0000 HS1 SubDivision HS1 LT 9 BLK 13 HIGH SIERRA SUBD 1ST FILING	2	RE

Assessor#	Owner/Mailing Address	Legal Description	Levy Sub Tax	
			Dist	Dist Type Key #1
A27046	LYNDES, JAY C 600 INDIAN TRL BILLINGS MT 59105-2702	03-1033-17-1-07-15-0000 HS1 SubDivision HS1 LT 8 BLK 13 HIGH SIERRA SUBD 1ST FILING	2	RE
A27045	LYNDES, JAY C 600 INDIAN TRL BILLINGS MT 59105-2702	03-1033-17-1-07-13-0000 HS1 SubDivision HS1 LT 7 BLK 13 HIGH SIERRA SUBD 1ST FILING	2	RE
A27044	LYNDES, JAY C 600 INDIAN TRL BILLINGS MT 59105-2702	03-1033-17-1-07-11-0000 HS1 SubDivision HS1 LT 6 BLK 13 HIGH SIERRA SUBD 1ST FILING	2	RE
A27038	LYNDES, JAY C 600 INDIAN TRL BILLINGS MT 59105-2702	03-1033-17-1-09-15-0000 HS1 SubDivision HS1 LT 7 BLK 12 HIGH SIERRA SUBD 1ST FILING	2	RE
A27037	LYNDES, JAY C 600 INDIAN TRL BILLINGS MT 59105-2702	03-1033-17-1-09-13-0000 HS1 SubDivision HS1 LT 6 BLK 12 HIGH SIERRA SUBD 1ST FILING	2	RE
A27036	LYNDES, JAY C 600 INDIAN TRL BILLINGS MT 59105-2702	03-1033-17-1-09-11-0000 HS1 SubDivision HS1 LT 5 BLK 12 HIGH SIERRA SUBD 1ST FILING	2	RE
A31309	MAISEL, ERIC C & DONNA A 1138 MATADOR AV BILLINGS MT 59105	03-1033-17-1-20-21-0000 HS3 SubDivision HS3 LT 11 BLK 1 HIGH SIERRA SUB 3RD FILING AMD LT 1 BLK 2 HIGH SIERRA SUB 2ND FIL 8118 SF (OLD A30250) (05)	2	RE
A31312	SIMPSON, JOHN K & BRANDI R 1176 MATADOR AVE BILLINGS MT 59105-5433	03-1033-17-1-20-27-0000 HS3 SubDivision HS3 LT 14 BLK 1 HIGH SIERRA SUB 3RD FILING AMD LT 1 BLK 2 HIGH SIERRA SUB 2ND FIL 8121 SF (OLD A30250) (05)	2	RE

*Certified true & correct
Dept. of Rev. Baul*

Ranges: TAX YEAR: (R) 2005 - 2005
ASSESSOR#: (L) A22219, A22220, A27033,
A27034, A27035, A27041, A27042,
A27043, A27049, A27050, A27053,
A27089, A27408, A31302, A31303,
A31304, A31305, A31306, A31322,
A31323, A31324, A31325, A31326,
A31327, A31328
TAX TYPE: (A)
LEVY DISTRICT: (A)
SUB-LEVY DIST: (A)
SPECIAL DISTRICT: (A)

OPTIONS: SORT ORDER: N # OF COPIES: 1

Assessor#	Owner/Mailing Address	Legal Description	Levy Sub Tax Dist Dist Type Key #1
A27053	BILLINGS SCHOOL DISTRICT #2 415 N 30TH ST BILLINGS MT 59101-1252	03-1033-17-1-03-01-0000 HS1 SubDivision HS1 LT 1 BLK 14 HIGH SIERRA SUBD 1ST FILING	2 RE
A27408	BOYER LAND LLC 2810 CENTRAL AVE STE C BILLINGS MT 59102-4651	03-1033-20-3-12-10-0000 TE3 SubDivision TE3 LT 16 BLK 1 TERRACE ESTATES SUBD 3RD	2 RE
A31322	HIGH SIERRA DEVELOPMENT 175 N 27TH ST STE 940 BILLINGS MT 59101-2048	03-1033-17-1-21-15-0000 HS3 SubDivision HS3 LT 8 BLK 2 HIGH SIERRA SUB 3RD FILING AMD LT 1 BLK 2 HIGH SIERRA SUB 2ND FIL 8500 SF (OLD A30250) (05)	2 RE
A31324	HIGH SIERRA DEVELOPMENT 175 N 27TH ST STE 940 BILLINGS MT 59101-2048	03-1033-17-1-21-19-0000 HS3 SubDivision HS3 LT 10 BLK 2 HIGH SIERRA SUB 3RD FILING AMD LT 1 BLK 2 HIGH SIERRA SUB 2ND FIL 8500 SF (OLD A30250) (05)	2 RE
A31302	HIGH SIERRA DEVELOPMENT 175 N 27TH ST STE 940 BILLINGS MT 59101-2048	03-1033-17-1-20-07-0000 HS3 SubDivision HS3 LT 4 BLK 1 HIGH SIERRA SUB 3RD FILING AMD LT 1 BLK 2 HIGH SIERRA SUB 2ND FIL 8060 SF (OLD A30250) (05)	2 RE
A31323	HIGH SIERRA DEVELOPMENT 175 N 27TH ST STE 940 BILLINGS MT 59101-2048	03-1033-17-1-21-17-0000 HS3 SubDivision HS3 LT 9 BLK 2 HIGH SIERRA SUB 3RD FILING AMD LT 1 BLK 2 HIGH SIERRA SUB 2ND FIL 8500 SF (OLD A30250) (05)	2 RE
A31304	HIGH SIERRA DEVELOPMENT 175 N 27TH ST STE 940 BILLINGS MT 59101-2048	03-1033-17-1-20-11-0000 HS3 SubDivision HS3 LT 6 BLK 1 HIGH SIERRA SUB 3RD FILING AMD LT 1 BLK 2 HIGH SIERRA SUB 2ND FIL	2 RE

*Oakland Home
175 N 27th ST
Blgs, MT 59101*

Assessor#	Owner/Mailing Address	Legal Description	Levy Dist	Sub Dist	Tax Type	Key #1
		8060 SF (OLD A30250) (05)				
A31303	HIGH SIERRA DEVELOPMENT 175 N 27TH ST STE 940 BILLINGS MT 59101-2048	03-1033-17-1-20-09-0000 HS3 SubDivision HS3 LT 5 BLK 1 HIGH SIERRA SUB 3RD FILING AMD LT 1 BLK 2 HIGH SIERRA SUB 2ND FIL 8060 SF (OLD A30250) (05)	2		RE	
A22219	HILL, RON S LIVING TRUST PO BOX 50636 BILLINGS MT 59105-0636	03-1033-16-2-01-02-0000 L17 SubDivision L17 LT 2 BLK 17 LAKE HILLS SUBD 17TH FILING	2		RE	
A31328	J & E CONSTRUCTION 1070 S 24TH ST W BILLINGS MT 59102-6406	03-1033-17-1-21-27-0000 HS3 SubDivision HS3 LT 14 BLK 2 HIGH SIERRA SUB 3RD FILING AMD LT 1 BLK 2 HIGH SIERRA SUB 2ND FIL 9733 SF (OLD A30250) (05)	2		RE	
A31327	J & E CONSTRUCTION INC 1070 S 24TH ST W BILLINGS MT 59102-6406	03-1033-17-1-21-25-0000 HS3 SubDivision HS3 LT 13 BLK 2 HIGH SIERRA SUB 3RD FILING AMD LT 1 BLK 2 HIGH SIERRA SUB 2ND FIL 8500 SF (OLD A30250) (05)	2		RE	
A31326	J & E CONSTRUCTION INC 1070 S 24TH ST W BILLINGS MT 59102-6406	03-1033-17-1-21-23-0000 HS3 SubDivision HS3 LT 12 BLK 2 HIGH SIERRA SUB 3RD FILING AMD LT 1 BLK 2 HIGH SIERRA SUB 2ND FIL 8500 SF (OLD A30250) (05)	2		RE	
A31305	J & J BUILDERS LLC 2622 NORMAL AVE BILLINGS MT 59102-1012	03-1033-17-1-20-13-0000 HS3 SubDivision HS3 LT 7 BLK 1 HIGH SIERRA SUB 3RD FILING AMD LT 1 BLK 2 HIGH SIERRA 2ND FIL 8060 SF (OLD A30250) (05)	2		RE	
A31306	J & J BUILDERS LLC 2622 NORMAL AVE BILLINGS MT 59102-1012	03-1033-17-1-20-15-0000 HS3 SubDivision HS3 LT 8 BLK 1 HIGH SIERRA SUB 3RD FILING AMD LT 1 BLK 2 HIGH SIERRA SUB 2ND FIL 8060 SF (OLD A30250) (05)	2		RE	
A27089	LYNDES, JAY C 600 INDIAN TRL BILLINGS MT 59105-2702	03-1033-17-1-01-27-0000 HS1 SubDivision HS1 LT 1 BLK 19 HIGH SIERRA SUBD 1ST FILING	2		RE	
A27050	LYNDES, JAY C 600 INDIAN TRL BILLINGS MT 59105-2702	03-1033-17-1-07-23-0000 HS1 SubDivision HSI LT 12 BLK 13 HIGH SIERRA SUBD 1ST FILING	2		RE	
A27049	LYNDES, JAY C 600 INDIAN TRL	03-1033-17-1-07-21-0000 HS1 SubDivision HS1	2		RE	

Assessor#	Owner/Mailing Address	Legal Description	Levy Sub Tax Dist Dist Type Key #1
	BILLINGS MT 59105-2702	LT 11 BLK 13 HIGH SIERRA SUBD 1ST FILING	
A27043	LYNDES, JAY C ✓ 600 INDIAN TRL BILLINGS MT 59105-2702	03-1033-17-1-07-09-0000 HS1 SubDivision HS1	2 RE
A27042	LYNDES, JAY C ✓ 600 INDIAN TRL BILLINGS MT 59105-2702	03-1033-17-1-07-07-0000 HS1 SubDivision HS1	2 RE
A27041	LYNDES, JAY C ✓ 600 INDIAN TRL BILLINGS MT 59105-2702	03-1033-17-1-07-05-0000 HS1 SubDivision HS1	2 RE
A27035	LYNDES, JAY C ✓ 600 INDIAN TRL BILLINGS MT 59105-2702	03-1033-17-1-09-09-0000 HS1 SubDivision HS1	2 RE
A27034	LYNDES, JAY C ✓ 600 INDIAN TRL BILLINGS MT 59105-2702	03-1033-17-1-09-07-0000 HS1 SubDivision HS1	2 RE
A27033	LYNDES, JAY C ✓ 600 INDIAN TRL BILLINGS MT 59105-2702	03-1033-17-1-09-05-0000 HS1 SubDivision HS1	2 RE
A31325	OAKLAND HOME BUILDERS CORP ✓ 175 N 27TH ST STE 940 BILLINGS MT 59101-2048	03-1033-17-1-21-21-0000 HS3 SubDivision HS3 LT 11 BLK 2 HIGH SIERRA SUB 3RD FILING AMD LT 1 BLK 2 HIGH SIERRA SUB 2ND FIL 8500 SF (OLD A30250) (05)	2 RE ✓
A22220	TORRES, JOE STEVE ✓ 13038 TERRA BELLA ST PACDIMA CA 91331-3145	03-1033-18-2-01-03-0000 L17 SubDivision L17 LT 3 BLK 17 LAKE HILLS SUBD 17TH FILING	2 RE

Griffin, Benjamin
Griffin, Laura Leah
1158 Cortez Ave
Blq MT 59105

*Certified true
3/23/05 10/1/05
Dept. of Revenue
Bael*

Ranges: TAX YEAR: (R) 2005 - 2005
ASSESSOR#: (L) A27024, A27025, A27026,
A27027, A27028, A27029, A27030,
A27055, A27056, A27057, A27058,
A27059, A27060, A27088, A31329,
A31335, A31336, A31337, A31338,
A31339, A31340, A31341, A31342,
A31343, A31344
TAX TYPE: (A)
LEVY DISTRICT: (A)
SUB-LEVY DIST: (A)
SPECIAL DISTRICT: (A)

OPTIONS: SORT ORDER: N # OF COPIES: 1

Assessor#	Owner/Mailing Address	Legal Description	Levy Sub Tax Dist Dist Type Key #1
A31335	CZECZEL, KONRAD A & CHELSEA A 1119 EL RANCHO DR BILLINGS MT 59105-5424	03-1033-17-4-40-13-0000 HS3 SubDivision HS3 LT 7 BLK 3 HIGH SIERRA SUB 3RD FILING AMD LT 1 BLK 2 HIGH SIERRA SUB 2ND FIL 7412 SF (OLD A30250) (05)	2 RE
A31329	DAWSON BUILDERS 4736 S WOODHAVEN WAY BILLINGS MT 59106-2494	03-1033-17-4-40-01-0000 HS3 SubDivision HS3 LT 1 BLK 3 HIGH SIERRA SUB 3RD FILING AMD LT 1 BLK 2 HIGH SIERRA SUB 2ND FIL 9609 SF (OLD A30250) (05)	2 RE
A31337	HIGH SIERRA DEVELOPMENT 175 N 27TH ST STE 940 BILLINGS MT 59101-2048	03-1033-17-4-40-17-0000 HS3 SubDivision HS3 LT 9 BLK 3 HIGH SIERRA SUB 3RD FILING AMD LT 1 BLK 2 HIGH SIERRA SUB 2ND FIL 7425 SF (OLD A30250) (05)	2 RE
A31338	HIGH SIERRA DEVELOPMENT 175 N 27TH ST STE 940 BILLINGS MT 59101-2048	03-1033-17-4-40-19-0000 HS3 SubDivision HS3 LT 10 BLK 3 HIGH SIERRA SUB 3RD FILING AMD LT 1 BLK 2 HIGH SIERRA SUB 2ND FIL 7425 SF (OLD A30250) (05)	2 RE
A31342	HIGH SIERRA DEVELOPMENT 175 N 27TH ST STE 940 BILLINGS MT 59101-2048	03-1033-17-4-40-27-0000 HS3 SubDivision HS3 LT 14 BLK 3 HIGH SIERRA SUB 3RD FILING AMD LT 1 BLK 2 HIGH SIERRA SUB 2ND FIL 7425 SF (OLD A30250) (05)	2 RE
A31343	HIGH SIERRA DEVELOPMENT 175 N 27TH ST STE 940 BILLINGS MT 59101-2048	03-1033-17-4-40-29-0000 HS3 SubDivision HS3 LT 15 BLK 3 HIGH SIERRA SUB 3RD FILING AMD LT 1 BLK 2 HIGH SIERRA SUB 2ND FIL 7425 SF (OLD A30250) (05)	2 RE

*Dawson Build
4736 S. WoodH
Blq, MT 59101*

Dawson Build

Assessor#	Owner/Mailing Address	Legal Description	Levy Dist	Sub Dist	Tax Type	Key #1
A31340	HIGH SIERRA DEVELOPMENT 175 N 27TH ST STE 940 BILLINGS MT 59101-2048	03-1033-17-4-40-23-0000 HS3 SubDivision HS3 LT 12 BLK 3 HIGH SIERRA SUB 3RD FILING AMD LT 1 BLK 2 HIGH SIERRA SUB 2ND FIL 7425 SF (OLD A30250) (05)	2		RE	
A31339	HIGH SIERRA DEVELOPMENT 175 N 27TH ST STE 940 BILLINGS MT 59101-2048	03-1033-17-4-40-21-0000 HS3 SubDivision HS3 LT 11 BLK 3 HIGH SIERRA SUB 3RD FILING AMD LT 1 BLK 2 HIGH SIERRA 2ND FIL 7425 SF (OLD A30250) (05)	2		RE	
A31341	HIGH SIERRA DEVELOPMENT 175 N 27TH ST # STE940 BILLINGS MT 59101-2048	03-1033-17-4-40-25-0000 HS3 SubDivision HS3 LT 13 BLK 3 HIGH SIERRA SUB 3RD FILING AMD LT 1 BLK 2 HIGH SIERRA SUB 2ND FIL 7425 SF (OLD A30250) (05)	2		RE	Dawson Build
A31344	HOGAN, DEANNE 1011 EL RANCHO DRIVE BILLINGS MT 59105	03-1033-17-4-40-31-0000 HS3 SubDivision HS3 LT 16 BLK 3 HIGH SIERRA SUB 3RD FILING AMD LT 1 BLK 2 HIGH SIERRA SUB 2ND FIL 7425 SF (OLD A30250) (05)	2		RE	
A31336	KATCO LLC 2827 WESTWOOD DR BILLINGS MT 59102-2655	03-1033-17-4-40-15-0000 HS3 SubDivision HS3 LT 8 BLK 3 HIGH SIERRA SUB 3RD FILING AMD LT 1 BLK 2 HIGH SIERRA SUB 2ND FIL 7412 SF (OLD A30250) (05)	2		RE	Wilhelm, Dav Wilhelm, Jess 1105 El Ranch Billings mt 59
A27058	LYNDES, JAY C 600 INDIAN TRL BILLINGS MT 59105-2702	03-1033-17-4-35-07-0000 HS1 SubDivision HS1 LT 4 BLK 16 HIGH SIERRA SUBD 1ST FILING	2		RE	
A27057	LYNDES, JAY C 600 INDIAN TRL BILLINGS MT 59105-2702	03-1033-17-4-35-05-0000 HS1 SubDivision HS1 LT 3 BLK 16 HIGH SIERRA SUBD 1ST FILING	2		RE	
A27024	LYNDES, JAY C 600 INDIAN TRL BILLINGS MT 59105-2702	03-1033-17-4-37-15-0000 HS1 SubDivision HS1 LT 9 BLK 11 HIGH SIERRA SUBD 1ST FILING	2		RE	
A27056	LYNDES, JAY C 600 INDIAN TRL BILLINGS MT 59105-2702	03-1033-17-4-35-03-0000 HS1 SubDivision HS1 LT 2 BLK 16 HIGH SIERRA SUBD 1ST FILING	2		RE	
A27055	LYNDES, JAY C 600 INDIAN TRL BILLINGS MT 59105-2702	03-1033-17-4-35-01-0000 HS1 SubDivision HS1 LT 1 BLK 16 HIGH SIERRA SUBD 1ST FILING	2		RE	
A27025	LYNDES, JAY C 600 INDIAN TRL	03-1033-17-4-37-13-0000 HS1 SubDivision HS1	2		RE	

Assessor#	Owner/Mailing Address	Legal Description	Levy Sub Tax	
			Dist Dist	Type Key #1
	BILLINGS MT 59105-2702	LT 10 BLK 11 HIGH SIERRA SUBD 1ST FILING		
A27026	LYNDES, JAY C ✓ 600 INDIAN TRL BILLINGS MT 59105-2702	03-1033-17-4-37-11-0000 HS1 SubDivision HS1 LT 11 BLK 11 HIGH SIERRA SUBD 1ST FILING	2	RE
A27027	LYNDES, JAY C 4 600 INDIAN TRL BILLINGS MT 59105-2702	03-1033-17-4-37-09-0000 HS1 SubDivision HS1 LT 12 BLK 11 HIGH SIERRA SUBD 1ST FILING	2	RE
A27060	LYNDES, JAY C 4 600 INDIAN TRL BILLINGS MT 59105-2702	03-1033-17-4-35-11-0000 HS1 SubDivision HS1 LT 6 BLK 16 HIGH SIERRA SUBD 1ST FILING	2	RE
A27059	LYNDES, JAY C 4 600 INDIAN TRL BILLINGS MT 59105-2702	03-1033-17-4-35-09-0000 HS1 SubDivision HS1 LT 5 BLK 16 HIGH SIERRA SUBD 1ST FILING	2	RE
A27028	LYNDES, JAY C 4 600 INDIAN TRL BILLINGS MT 59105-2702	03-1033-17-4-37-07-0000 HS1 SubDivision HS1 LT 13 BLK 11 HIGH SIERRA SUBD 1ST FILING	2	RE
A27030	LYNDES, JAY C 4 600 INDIAN TRL BILLINGS MT 59105-2702	03-1033-17-4-37-03-0000 HS1 SubDivision HS1 LT 15 BLK 11 HIGH SIERRA SUBD 1ST FILING	2	RE
A27029	LYNDES, JAY C 4 600 INDIAN TRL BILLINGS MT 59105-2702	03-1033-17-4-37-05-0000 HS1 SubDivision HS1 LT 14 BLK 11 HIGH SIERRA SUBD 1ST FILING	2	RE
A27088	LYNDES, JAY C 4 600 INDIAN TRL BILLINGS MT 59105-2702	03-1033-17-4-33-01-0000 HS1 SubDivision HS1 LT 26 BLK 18 HIGH SIERRA SUBD 1ST FILING	2	RE

*Certified thru
3/23/05 10/9/05
Dept. of Rev. Bd.*

Ranges: TAX YEAR: (R) 2005 - 2005
 ASSESSOR#: (L) A22001, A26867, A27023,
 A27031, A27061, A27062, A27063,
 A27064, A27065, A27066, A27081,
 A27082, A27083, A27084, A27086,
 A27087, A28085, A31345, A31346,
 A31347, A31348, A31349, A31350,
 A31351, A31352

TAX TYPE: (A)
 LEVY DISTRICT: (A)
 SUB-LEVY DIST: (A)
 SPECIAL DISTRICT: (A)

OPTIONS: SORT ORDER: N # OF COPIES: 1

Assessor#	Owner/Mailing Address	Legal Description	Levy Dist	Sub Dist	Tax Type	Key #1
A31350	ADKINS, LYNDA S ✓ 1178 SIERRA GRANDE BLVD BILLINGS MT 59105-5426	03-1033-17-4-40-43-0000 HS3 SubDivision HS3 LT 22 BLK 3 HIGH SIERRA SUB 3RD FILING AMD LT 1 BLK 2 HIGH SIERRA SUB 2ND FIL 7412 SF (OLD A30250) (05)	2		RE	
A26867	GRAHAM, RICHARD C ✓ 1977 MOROCCO DR BILLINGS MT 59105-5409	03-1033-17-4-11-71-0000 HS1 SubDivision HS1 LT 67 BLK 1 HIGH SIERRA SUBD 1ST FILING	2		RE	
A22001	HILL, RON S LIVING TRUST ✓ PO BOX 506 ✓ BILLINGS MT 59105-0636	03-1033-16-3-01-23-0000 L17 SubDivision L17 LT 20 BLK 1 LAKE HILLS SUBD 17TH FILING	2		RE	
A27031	HOLLOWAY, TIMOTHY K & STACY L ✓ 1980 MOROCCO DR BILLINGS MT 59105-5408	03-1033-17-4-37-01-0000 HS1 SubDivision HS1 LT 16 BLK 11 HIGH SIERRA SUBD 1ST FILING	2		RE	
A31345	J & E CONSTRUCTION ✓ 1070 S 24TH ST W BILLINGS MT 59102-6406	03-1033-17-4-40-33-0000 HS3 SubDivision HS3 LT 17 BLK 3 HIGH SIERRA SUB 3RD FILING AMD LT 1 BLK 2 HIGH SIERRA SUB 2ND FIL 7412 SF (OLD A30250) (05)	2		RE	
A31351	J & E CONSTRUCTION ✓ 1070 S 24TH ST W BILLINGS MT 59102-6406	03-1033-17-4-40-45-0000 HS3 SubDivision HS3 LT 23 BLK 3 HIGH SIERRA SUB 3RD FILING AMD LT 1 BLK 2 HIGH SIERRA SUB 2ND FIL 7412 SF (OLD A30250) (05)	2		RE	
A31346	J & E CONSTRUCTION ✓ 1070 S 24TH ST W BILLINGS MT 59102-6406	03-1033-17-4-40-35-0000 HS3 SubDivision HS3 LT 18 BLK 3 HIGH SIERRA SUB 3RD FILING AMD LT 1 BLK 2 HIGH SIERRA SUB 2ND FIL 7412 SF (OLD A30250) (05)	2		RE	

*✓ Krivitz, Just
✓ RE Krivitz, Elizabeth
1186 Sierra Grande
Billings MT 59102*

Assessor#	Owner/Mailing Address	Legal Description	Levy Dist	Sub Dist	Tax Type	Key #1
A31349	J & E CONSTRUCTION 1070 S 24TH ST W BILLINGS MT 59102-6406	03-1033-17-4-40-41-0000 HS3 SubDivision HS3 LT 21 BLK 3 HIGH SIERRA SUB 3RD FILING AMD LT 1 BLK 2 HIGH SIERRA SUB 2ND FIL 7412 SF (OLD A30250) (05)	2		RE	
A31348	J & E CONSTRUCTION 1070 S 24TH ST W BILLINGS MT 59102-6406	03-1033-17-4-40-39-0000 HS3 SubDivision HS3 LT 20 BLK 3 HIGH SIERRA SUB 3RD FILING AMD LT 1 BLK 2 HIGH SIERRA SUB 2ND FIL 7412 SF (OLD A30250) (05)	2		RE	
A31347	J & E CONSTRUCTION 1070 S 24TH ST W BILLINGS MT 59102-6406	03-1033-17-4-40-37-0000 HS3 SubDivision HS3 LT 19 BLK 3 HIGH SIERRA SUB 3RD FILING AMD LT 1 BLK 2 HIGH SIERRA SUB 2ND FIL 7412 SF (OLD A30250) (05)	2		RE	
A27082	LYNDES, JAY C 600 INDIAN TRL BILLINGS MT 59105-2702	03-1033-17-4-33-49-0000 HS1 SubDivision HS1 LT 2 BLK 18 HIGH SIERRA SUBD 1ST FILING	2		RE	
A27086	LYNDES, JAY C 600 INDIAN TRL BILLINGS MT 59105-2702	03-1033-17-4-33-41-0000 HS1 SubDivision HS1 LT 6 BLK 18 HIGH SIERRA SUBD 1ST FILING	2		RE	
A27083	LYNDES, JAY C 600 INDIAN TRL BILLINGS MT 59105-2702	03-1033-17-4-33-47-0000 HS1 SubDivision HS1 LT 3 BLK 18 HIGH SIERRA SUBD 1ST FILING	2		RE	
A27023	LYNDES, JAY C 600 INDIAN TRL BILLINGS MT 59105-2702	03-1033-17-4-37-17-0000 HS1 SubDivision HS1 LT 8 BLK 11 HIGH SIERRA SUBD 1ST FILING	2		RE	
A27061	LYNDES, JAY C 600 INDIAN TRL BILLINGS MT 59105-2702	03-1033-17-4-35-13-0000 HS1 SubDivision HS1 LT 7 BLK 16 HIGH SIERRA SUBD 1ST FILING	2		RE	
A27062	LYNDES, JAY C 600 INDIAN TRL BILLINGS MT 59105-2702	03-1033-17-4-35-15-0000 HS1 SubDivision HS1 LT 8 BLK 16 HIGH SIERRA SUBD 1ST FILING	2		RE	
A27063	LYNDES, JAY C 600 INDIAN TRL BILLINGS MT 59105-2702	03-1033-17-4-35-17-0000 HS1 SubDivision HS1 LT 9 BLK 16 HIGH SIERRA SUBD 1ST FILING	2		RE	
A27064	LYNDES, JAY C 600 INDIAN TRL BILLINGS MT 59105-2702	03-1033-17-4-35-19-0000 HS1 SubDivision HS1 LT 10 BLK 16 HIGH SIERRA SUBD 1ST FILING	2		RE	
A27065	LYNDES, JAY C 600 INDIAN TRL	03-1033-17-4-35-21-0000 HS1 SubDivision HS1	2		RE	

Assessor#	Owner/Mailing Address	Legal Description	Levy Sub Tax		
			Dist	Dist	Type Key #1
	BILLINGS MT 59105-2702	LT 11 BLK 16 HIGH SIERRA SUBD 1ST FILING			
A27066	LYNDES, JAY C ✓ 600 INDIAN TRL BILLINGS MT 59105-2702	03-1033-17-4-35-23-0000 HS1 SubDivision HS1 LT 12 BLK 16 HIGH SIERRA SUBD 1ST FILING	2		RE
A27087	LYNDES, JAY C ✓ 600 INDIAN TRL BILLINGS MT 59105-2702	03-1033-17-4-33-39-0000 HS1 SubDivision HS1 LT 7 BLK 18 HIGH SIERRA SUBD 1ST FILING	2		RE
A27084	LYNDES, JAY C ✓ 600 INDIAN TRL BILLINGS MT 59105-2702	03-1033-17-4-33-45-0000 HS1 SubDivision HS1 LT 4 BLK 18 HIGH SIERRA SUBD 1ST FILING	2		RE
A27081	LYNDES, JAY C ✓ 600 INDIAN TRL BILLINGS MT 59105-2702	03-1033-17-4-33-51-0000 HS1 SubDivision HS1 LT 1 BLK 18 HIGH SIERRA SUBD 1ST FILING	2		RE
A31352	MCGUIRE, RYAN R & PATRICIA J ✓ 1192 SIERRA GRANDE BLVD BILLINGS MT 59105-5426	03-1033-17-4-40-47-0000 HS3 SubDivision HS3 LT 24 BLK 3 HIGH SIERRA SUB 3RD FILING AMD LT 1 BLK 2 HIGH SIERRA SUB 2ND FIL 9678 SF (OLD A30250) (05)	2		RE
A28085 7	SNYDER, RALPH O ✓ 3714 FORT LARAMIE DR BILLINGS MT 59102-7738	03-0926-11-2-07-19-0000 PW3 SubDivision PW3	2		RE

*Certified true
3/23/05
Dept. of Rev.
Ba*

Ranges: TAX YEAR: (R) 2005 - 2005
ASSESSOR#: (L) A21998, A26863, A26864,
A26983, A26984, A26985, A26986,
A26998, A26999, A27004, A27067,
A27078, A27079, A27080, A31358,
A31359, A31360, A31361, A31362,
A31363, A31364, A31365, A31366,
A31367, A31368
TAX TYPE: (A)
LEVY DISTRICT: (A)
SUB-LEVY DIST: (A)
SPECIAL DISTRICT: (A)

OPTIONS: SORT ORDER: N # OF COPIES: 1

Assessor#	Owner/Mailing Address	Legal Description	Levy Dist	Sub Dist	Tax Type	Key #1
A21998	ALEXANDER, JAMES B & LOUIS M 1940 GLENWAGLES BLVD BILLINGS MT 59105-3551	03-1033-16-3-01-20-0000 L19 SubDivision L19 LT 18 BLK 1 LAKE HILLS SUBD 19TH FILING	2		RE	
A31359	DAWSON BUILDERS INC <i>Mekarie R Howrey 3329924 4-21-05</i> 4736 S WOODHAVEN WAY BILLINGS MT 59106-2494 <i>1118 El Rancho Billings Mt 59105</i>	03-1033-17-4-41-13-0000 HS3 SubDivision HS3 LT 7 BLK 4 HIGH SIERRA SUB 3RD FILING AMD LT 1 BLK 2 HIGH SIERRA SUB 2ND FIL 7459 SF (OLD A30250) (05)	2		RE	
A31360	DAWSON BUILDERS INC 4736 S WOODHAVEN WAY BILLINGS MT 59106-2494	03-1033-17-4-41-15-0000 HS3 SubDivision HS3 LT 8 BLK 4 HIGH SIERRA SUB 3RD FILING AMD LT 1 BLK 2 HIGH SIERRA SUB 2ND FIL 7459 SF (OLD A30250) (05)	2		RE	
A26983	FARNUM, JAMES K & WANCY 845 TIERRA DR BILLINGS MT 59105-5415	03-1033-17-4-29-01-0000 HS1 SubDivision HS1 LT 1 BLK 10 HIGH SIERRA SUBD 1ST FILING	2		RE	
A31358	FIRELAKE CORP <i>Timothy Jay Paulson & Lynette Paulson 1130 El Rancho Billings, Mt 59105 3329507 4-18-05</i> 3208 RUGBY DR BILLINGS MT 59102-0752	03-1033-17-4-41-11-0000 HS3 SubDivision HS3 LT 6 BLK 4 HIGH SIERRA SUB 3RD FILING AMD LT 1 BLK 2 HIGH SIERRA SUB 2ND FIL 7459 SF (OLD A30250) (05)	2		RE	
A27080	FRITZ, LARRY J & MELISSIA L 1005 SIESTA AVE BILLINGS MT 59105-5428	03-1033-17-4-31-01-0000 HS1 SubDivision HS1 LT 26 BLK 17 HIGH SIERRA SUBD 1ST FILING	2		RE	
A27079	GARTON, LANCE & JENNIFER A 1023 SIESTA AVE BILLINGS MT 59105-5428	03-1033-17-4-31-03-0000 HS1 SubDivision HS1 LT 25 BLK 17 HIGH SIERRA SUBD 1ST FILING	2		RE	
A26864	HARRIS, STEVEN P 1941 MOROCCO DR	03-1033-17-4-11-65-0000 HS1 SubDivision HS1	2		RE	

Assessor#	Owner/Mailing Address	Legal Description	Levy Sub Tax	
			Dist	Dist Type Key #1
	BILLINGS MT 59105-5409	LT 64 BLK 1 HIGH SIERRA SUBD 1ST FILING		
A31362	✓ HIGH SIERRA DEVELOPMENT 175 N 27TH ST STE 940 BILLINGS MT 59101-2048	03-1033-17-4-41-19-0000 HS3 SubDivision HS3 LT 10 BLK 4 HIGH SIERRA SUB 3RD FILING AMD LT 1 BLK 2 HIGH SIERRA SUB 2ND FIL 7380 SF (OLD A30250) (05)	2	RE
A31363	✓ HIGH SIERRA DEVELOPMENT 175 N 27TH ST STE 940 BILLINGS MT 59101-2048	03-1033-17-4-41-21-0000 HS3 SubDivision HS3 LT 11 BLK 4 HIGH SIERRA SUB 3RD FILING AMD LT 1 BLK 2 HIGH SIERRA SUB 2ND FIL 7380 SF (OLD A30250) (05)	2	RE
A31364	✓ HIGH SIERRA DEVELOPMENT 175 N 27TH ST STE 940 BILLINGS MT 59101-2048	03-1033-17-4-41-23-0000 HS3 SubDivision HS3 LT 12 BLK 4 HIGH SIERRA SUB 3RD FILING AMD LT 1 BLK 2 HIGH SIERRA SUB 2ND FIL 7380 SF (OLD A30250) (05)	2	RE
A31365	✓ HIGH SIERRA DEVELOPMENT 175 N 27TH ST STE 940 BILLINGS MT 59101-2048	03-1033-17-4-41-25-0000 HS3 SubDivision HS3 LT 13 BLK 4 HIGH SIERRA SUB 3RD FILING AMD LT 1 BLK 2 HIGH SUB 2ND FIL 7380 SF (OLD A30250) (05)	2	RE
A31366	✓ HIGH SIERRA DEVELOPMENT 175 N 27TH ST STE 940 BILLINGS MT 59101-2048	03-1033-17-4-41-27-0000 HS3 SubDivision HS3 LT 14 BLK 4 HIGH SIERRA SUB 3RD FILING AMD LT 1 BLK 2 HIGH SIERRA SUB 2ND FIL 7380 SF (OLD A30250) (05)	2	RE
A31367	✓ HIGH SIERRA DEVELOPMENT 175 N 27TH ST STE 940 BILLINGS MT 59101-2048	03-1033-17-4-41-29-0000 HS3 SubDivision HS3 LT 15 BLK 4 HIGH SIERRA SUB 3RD FILING AMD LT 1 BLK 2 HIGH SIERRA SUB 2ND FIL 7380 SF (OLD A30250) (05)	2	RE
A31368	✓ HIGH SIERRA DEVELOPMENT 175 N 27TH ST STE 940 BILLINGS MT 59101-2048 <i>Katco LLC Dawson Builders 2827 Westwood Dr Billings Mt 59102 3327979 4-5-05</i>	03-1033-17-4-41-31-0000 HS3 SubDivision HS3 LT 16 BLK 4 HIGH SIERRA SUB 3RD FILING AMD LT 1 BLK 2 HIGH SIERRA SUB 2ND FIL 7380 SF (OLD A30250) (05)	2	RE
A27078	✓ HULL, TODD & SARA 1035 SIESTA AVE BILLINGS MT 59105-5428	03-1033-17-4-31-05-0000 HS1 SubDivision HS1 LT 24 BLK 17 HIGH SEIRRA SUBD 1ST FILING	2	RE
A31361	✓ KATCO LLC 2827 WESTWOOD DR BILLINGS MT 59102-2655	03-1033-17-4-41-17-0000 HS3 SubDivision HS3 LT 9 BLK 4 HIGH SIERRA SUB 3RD FILING AMD LT 1 BLK 2 HIGH SIERRA SUB 2ND FIL	2	RE

Assessor#	Owner/Mailing Address	Legal Description	Levy Dist	Sub Dist	Tax Type	Key #1
		7380 SF (OLD A30250) (05)				
A27067	✓ LYNDES, JAY C 600 INDIAN TRL BILLINGS MT 59105-2702	03-1033-17-4-31-51-0000 HS1 SubDivision HS1 LT 1 BLK 17 HIGH SIERRA SUBD 1ST FILING	2		RE	
A26984	✗ LYNDES, JAY C 600 INDIAN TRL BILLINGS MT 59105-2702	03-1033-17-4-29-03-0000 HS1 SubDivision HS1 LT 2 BLK 10 HIGH SIERRA SUBD 1ST FILING	2		RE	
A26985	✗ LYNDES, JAY C 600 INDIAN TRL BILLINGS MT 59105-2702	03-1033-17-4-29-05-0000 HS1 SubDivision HS1 LT 3 BLK 10 HIGH SIERRA SUBD 1ST FILING	2		RE	
A26986	✗ LYNDES, JAY C 600 INDIAN TRL BILLINGS MT 59105-2702	03-1033-17-4-29-07-0000 HS1 SubDivision HS1 LT 4 BLK 10 HIGH SIERRA SUBD 1ST FILING	2		RE	
A26998	✗ LYNDES, JAY C 600 INDIAN TRL BILLINGS MT 59105-2702	03-1033-17-4-29-31-0000 HS1 SubDivision HS1 LT 16 BLK 10 HIGH SIERRA SUBD 1ST FILING	2		RE	
A26999	✗ LYNDES, JAY C 600 INDIAN TRL BILLINGS MT 59105-2702	03-1033-17-4-29-33-0000 HS1 SubDivision HS1 LT 17 BLK 10 HIGH SIERRA SUBD 1ST FILING	2		RE	
A27004	✓ LYNDES, JAY C 600 INDIAN TRL BILLINGS MT 59105-2702	03-1033-17-4-29-43-0000 HS1 SubDivision HS1 LT 22 BLK 10 HIGH SIERRA SUBD 1ST FILING	2		RE	
A26863	✓ ORERIFERO, DANIEL & LYNETTE 1925 MOROCCO DR BILLINGS MT 59105-5409	03-1033-17-4-11-63-0000 HS1 SubDivision HS1 LT 63 BLK 1 HIGH SIERRA SUBD 1ST FILING	2		RE	

*Certified true
14/9/05 3/23
Dept. of Rev.
Paul*

Ranges: TAX YEAR: (R) 2005 - 2005
 ASSESSOR#: (L) A21997, A26862, A26987,
 A26988, A26989, A26990, A26993,
 A26994, A26995, A26996, A26997,
 A27005, A27006, A27007, A27068,
 A27069, A27070, A27071, A27072,
 A27073, A27074, A27075, A27076,
 A27077, A27093

TAX TYPE: (A)
 LEVY DISTRICT: (A)
 SUB-LEVY DIST: (A)
 SPECIAL DISTRICT: (A)

OPTIONS: SORT ORDER: N # OF COPIES: 1

Assessor#	Owner/Mailing Address	Legal Description	Levy Dist	Sub Dist	Tax Type	Key #1
A27074	✓ ANDERSON, CHRIS D & CYNTHIA S 1095 SIESTA AVE BILLINGS MT 59105-5428	03-1033-17-4-31-13-0000 HS1 SubDivision HS1 LT 20 BLK 17 HIGH SIERRA SUBD 1ST FILING	2		RE	
A27076	✓ CORP/PRESIDING BISHOP CHRUCH OF LDS LDS CHURCH TAX ADM RE 531-6227 50 E NORTH TEMPLE FL 22 SALT LAKE CTY UT 84150-0002	03-1033-17-4-31-09-0000 HS1 SubDivision HS1 LT 22 BLK 17 HIGH SIERRA SUBD 1ST FILING	2		RE	
A27075	✓ FOURSTAR, STEVEN D 1083 SIESTA AVE BILLINGS MT 59105-5428	03-1033-17-4-31-11-0000 HS1 SubDivision HS1 LT 21 BLK 17 HIGH SIERRA SUBD 1ST FILING	2		RE	
A27068	✓ BORMAN, MICHAEL A & LYNDA L 1195 SIESTA AVE BILLINGS MT 59105-5401	03-1033-17-4-31-25-0000 HS1 SubDivision HS1 LT 14 BLK 17 HIGH SIERRA SUBD 1ST FILING	2		RE	
A26997	✓ GRAVGAARD, ROGER M & MIA J 993 SIESTA AVE BILLINGS MT 59105-5418	03-1033-17-4-29-29-0000 HS1 SubDivision HS1 LT 15 BLK 10 HIGH SIERRA SUBD 1ST FILING	2		RE	
A27071	✓ HARPER, MICHAEL D & CYNTHIA A 1141 SIESTA AVE BILLINGS MT 59105-5401	03-1033-17-4-31-19-0000 HS1 SubDivision HS1 LT 17 BLK 17 HIGH SIERRA SUBD 1ST FILING	2		RE	
A27097	✓ HENNING, RANDY A & BETH R 1910 GLEN EAGLES BLVD BILLINGS MT 59105-3551	03-1033-16-3-01-19-0000 L19 SubDivision L19 LT 17 BLK 1 LAKE HILLS SUBD 19TH FILING	2		RE	
A26987	✓ LYNDES, JAY C 600 INDIAN TRL BILLINGS MT 59105-2702	03-1033-17-4-29-09-0000 HS1 SubDivision HS1 LT 5 BLK 10 HIGH SIERRA SUBD 1ST FILING	2		RE	
A26988	✓ LYNDES, JAY C 600 INDIAN TRL BILLINGS MT 59105-2702	03-1033-17-4-29-11-0000 HS1 SubDivision HS1 LT 6 BLK 10 HIGH SIERRA SUBD 1ST FILING	2		RE	

Assessor#	Owner/Mailing Address	Legal Description	Levy Dist	Sub Dist	Tax Type	Key #1
A26989	✓ LYNDES, JAY C 600 INDIAN TRL BILLINGS MT 59105-2702	03-1033-17-4-29-13-0000 HS1 SubDivision HS1 LT 7 BLK 10 HIGH SIERRA SUBD 1ST FILING	2		RE	
A26990	✓ LYNDES, JAY C 600 INDIAN TRL BILLINGS MT 59105-2702	03-1033-17-4-29-15-0000 HS1 SubDivision HS1 LT 8 BLK 10 HIGH SIERRA SUBD 1ST FILING	2		RE	
A26994	✓ LYNDES, JAY C 600 INDIAN TRL BILLINGS MT 59105-2702	03-1033-17-4-29-23-0000 HS1 SubDivision HS1 LT 12 BLK 10 HIGH SIERRA SUBD 1ST FILING	2		RE	
A26995	✓ LYNDES, JAY C 600 INDIAN TRL BILLINGS MT 59105-2702	03-1033-17-4-29-25-0000 HS1 SubDivision HS1 LT 13 BLK 10 HIGH SIERRA SUBD 1ST FILING	2		RE	
A26996	✓ LYNDES, JAY C 600 INDIAN TRL BILLINGS MT 59105-2702	03-1033-17-4-29-27-0000 HS1 SubDivision HS1 LT 14 BLK 10 HIGH SIERRA SUBD 1ST FILING	2		RE	
A27005	✓ LYNDES, JAY C 600 INDIAN TRL BILLINGS MT 59105-2702	03-1033-17-4-29-45-0000 HS1 SubDivision HS1 LT 23 BLK 10 HIGH SIERRA SUBD 1ST FILING	2		RE	
A27006	✓ LYNDES, JAY C 600 INDIAN TRL BILLINGS MT 59105-2702	03-1033-17-4-29-47-0000 HS1 SubDivision HS1 LT 24 BLK 10 HIGH SIERRA SUBD 1ST FILING	2		RE	
A27007	✓ LYNDES, JAY C 600 INDIAN TRL BILLINGS MT 59105-2702	03-1033-17-4-29-49-0000 HS1 SubDivision HS1 LT 25 BLK 10 HIGH SIERRA SUBD 1ST FILING	2		RE	
A26993	✓ LYNDES, JAY C 600 INDIAN TRL BILLINGS MT 59105-2702	03-1033-17-4-29-21-0000 HS1 SubDivision HS1 LT 11 BLK 10 HIGH SIERRA SUBD 1ST FILING	2		RE	
A27072	✓ NELSON, NANCY R ✓ MANSFIELD, MICHAEL I & 1125 SIESTA AVE BILLINGS MT 59105-5401	03-1033-17-4-31-17-0000 HS1 SubDivision HS1 LT 18 BLK 17 HIGH SIERRA FIRST FILING	2		RE	
A27093	✓ PENNINGER, HARLAN G & ✓ JACQUELINE R 1215 SIESTA AVE BILLINGS MT 59105-5419	03-1033-17-3-34-01-0000 HS1 SubDivision HS1 LT 12 BLK 24 HIGH SIERRA SUB 1ST	2		RE	
A27069	✓ PERRY, CINDY A 1175 SIESTA AVE BILLINGS MT 59105-5401	03-1033-17-4-31-23-0000 HS1 SubDivision HS1 LT 15 BLK 17 HIGH SIERRA SUBD 1ST FILING	2		RE	
A26862	✓ PHILO, MARSHA J & ✓ LANN R 1905 MOROCCO DR	03-1033-17-4-11-61-0000 HS1 SubDivision HS1	2		RE	

Assessor#	Owner/Mailing Address	Legal Description	Levy Sub Tax		
			Dist	Dist	Type Key #1
	BILLINGS MT 59105-5409	LT 62 BLK 1 HIGH SIERRA SUBD 1ST FILING			
A27077	✓ SCHULTZ, JOHN T & WANA 1043 SIESTA AVE BILLINGS MT 59105	03-1033-17-4-31-07-0000 HS1 SubDivision HS1	2		RE
A27073	✓ WAMSLEY, JODEE JAELENE WAMSLEY, RODERICK GREG & 1115 SIESTA AVE BILLINGS MT 59105	03-1033-17-4-31-15-0000 HS1 SubDivision HS1	2		RE
A27070	✓ WOLCOTT, KENDALL A & CORNIE M 1155 SIESTA AVENUE BILLINGS MT 59102	03-1033-17-4-31-21-0000 HS1 SubDivision HS1	2		RE
		LT 23 BLK 17 HIGH SIERRA SUBD 1ST FILING			
		LT 19 BLK 17 HIGH SIERRA SUBD 1ST FILING			
		LT 16 BLK 17 HIGH SIERRA SUBD 1ST FILING			

*Certified true
3/23/05 10/19/05
Dept. of Rev. Bau*

Ranges: TAX YEAR: (R) 2005 - 2005
ASSESSOR#: (L) A22002, A22218, A26868,
A27016, A27017, A27018, A27019,
A27020, A27021, A27022, A27032,
A27039, A27040, A27051, A27052,
A27090, A31315, A31316, A31317,
A31318, A31319, A31320, A31321
TAX TYPE: (A)
LEVY DISTRICT: (A)
SUB-LEVY DIST: (A)
SPECIAL DISTRICT: (A)

OPTIONS: SORT ORDER: N # OF COPIES: 1

Assessor#	Owner/Mailing Address	Legal Description	Levy Dist	Sub Dist	Tax Type	Key #1
A27018	CLINE, CURTIS B ✓ 3927 W WELLESLEY AVE SPOKANE WA 99205-1875	03-1033-16-2-01-01-0000 L17 SubDivision L17 LT 1 BLK 17 LAKE HILLS SUBD 17TH FILING	2		RE	
A27016	GANN, LLOYD R & MICHELLE B ✓ 1990 MOROCCO DR ✓ BILLINGS MT 59105-5408 ✓	03-1033-17-4-37-31-0000 HS1 SubDivision HS1 LT 1 BLK 11 HIGH SIERRA SUBD 1ST FILING	2		RE	
A26868	GURNEY, BRIAN D ✓ 1993 MOROCCO DR ✓ BILLINGS MT 59105-5409 ✓	03-1033-17-4-11-73-0000 HS1 SubDivision HS1 L:68 B:1 HIGH SIERRA SUB 1ST	2		RE	
A27032	HANSON, JASON J & NICOLE K ✓ 2007 MOROCCO DR ✓ BILLINGS MT 59105-5417 ✓	03-1033-17-1-09-03-0000 HS1 SubDivision HS1 LT 1 BLK 12 HIGH SIERRA SUBD 1ST FILING	2		RE	
A31317	HUSKEY, JEFFREY D ✓ 1173 SIERRA GRANDE BLVD ✓ BILLINGS MT 59105-5426 ✓	03-1033-17-1-21-05-0000 HS3 SubDivision HS3 LT 3 BLK 2 HIGH SIERRA SUB 3RD FILING AMD LT 1 BLK 2 HIGH SIERRA SUB 2ND FIL 8500 SF (OLD A30250) (05)	2		RE	
A31320	J & E CONSTRUCTION ✓ 1070 S 24TH ST W ✓ BILLINGS MT 59102-6406 ✓	03-1033-17-1-21-11-0000 HS3 SubDivision HS3 LT 6 BLK 2 HIGH SIERRA SUB 3RD FILING AMD LT 1 BLK 2 HIGH SIERRA SUB 2ND FIL 8500 SF (OLD A30250) (05)	2		RE	
A31321	J & E CONSTRUCTION ✓ 1070 S 24TH ST W ✓ BILLINGS MT 59102-6406 ✓	03-1033-17-1-21-13-0000 HS3 SubDivision HS3 LT 7 BLK 2 HIGH SIERRA SUB 3RD FILING AMD LT 1 BLK 2 HIGH SIERRA SUB 2ND FIL 8500 SF (OLD A30250) (05)	2		RE	
A31316	J & E CONSTRUCTION ✓ 1070 S 24TH ST W ✓ BILLINGS MT 59102-6406 ✓	03-1033-17-1-21-03-0000 HS3 SubDivision HS3 LT 2 BLK 2 HIGH SIERRA SUB 3RD FILING	2		RE	

Assessor#	Owner/Mailing Address	Legal Description	Levy Sub Tax	
			Dist	Dist Type Key #1
		AMD LT 1 BLK 2 HIGH SIERRA SUB 2ND FIL 8500 SF (OLD A30250) (05)		
A31318	J & E CONSTRUCTION ✓ 1070 S 24TH ST W BILLINGS MT 59102-6406	03-1033-17-1-21-07-0000 HS3 SubDivision HS3 LT 4 BLK 2 HIGH SIERRA SUB 3RD FILING AMD LT 1 BLK 2 HIGH SIERRA SUB 2ND FIL 8500 SF (OLD A30250) (05)	2	RE
A31319	J & E CONSTRUCTION ✓ 1070 S 24TH ST W BILLINGS MT 59102-6406	03-1033-17-1-21-09-0000 HS3 SubDivision HS3 LT 5 BLK 2 HIGH SIERRA SUB 3RD FILING AMD LT 1 BLK 2 HIGH SIERRA SUB 2ND FIL 8500 SF (OLD A30250) (05) HIGH SIERRA DEV/J & E CONST WD	2	RE
A22002	KINCAID LAND LLC ✓ 3208 RUGBY DR BILLINGS MT 59102-0752	03-1033-16-3-31-24-0000 L17 SubDivision L17 LT 21 BLK 1 LAKE HILLS SUBD 17TH FILING	2	RE
A27017	LYNDES, JAY C ✓ 600 INDIAN TRL BILLINGS MT 59105-2702	03-1033-17-4-37-29-0000 HS1 SubDivision HS1 LT 2 BLK 11 HIGH SIERRA SUBD 1ST FILING	2	RE
A27018	LYNDES, JAY C ✓ 600 INDIAN TRL BILLINGS MT 59105-2702	03-1033-17-4-37-27-0000 HS1 SubDivision HS1 LT 3 BLK 11 HIGH SIERRA SUBD 1ST FILING	2	RE
A27019	LYNDES, JAY C ✓ 600 INDIAN TRL BILLINGS MT 59105-2702	03-1033-17-4-37-25-0000 HS1 SubDivision HS1 LT 4 BLK 11 HIGH SIERRA SUBD 1ST FILING	2	RE
A27022	LYNDES, JAY C ✓ 600 INDIAN TRL BILLINGS MT 59105-2702	03-1033-17-4-37-19-0000 HS1 SubDivision HS1 LT 7 BLK 11 HIGH SIERRA SUBD 1ST FILING	2	RE
A27021	LYNDES, JAY C ✓ 600 INDIAN TRL BILLINGS MT 59105-2702	03-1033-17-4-37-21-0000 HS1 SubDivision HS1 LT 6 BLK 11 HIGH SIERRA SUBD 1ST FILING	2	RE
A27020	LYNDES, JAY C ✓ 600 INDIAN TRL BILLINGS MT 59105-2702	03-1033-17-4-37-23-0000 HS1 SubDivision HS1 LT 5 BLK 11 HIGH SIERRA SUBD 1ST FILING	2	RE
A27040	LYNDES, JAY C ✓ 600 INDIAN TRL BILLINGS MT 59105-2702	03-1033-17-1-07-03-0000 HS1 SubDivision HS1 LT 2 BLK 13 HIGH SIERRA SUBD 1ST FILING	2	RE
A27051	LYNDES, JAY C ✓ 600 INDIAN TRL BILLINGS MT 59105-2702	03-1033-17-1-07-25-0000 HS1 SubDivision HS1 LT 13 BLK 13 HIGH SIERRA SUBD 1ST FILING	2	RE

Assessor#	Owner/Mailing Address	Legal Description	Levy Sub Tax Dist Dist Type Key #1
A27052	LYNDES, JAY C ✓ 600 INDIAN TRL BILLINGS MT 59105-2702	03-1033-17-1-07-27-0000 HS1 SubDivision HS1 LT 14 BLK 13 HIGH SIERRA SUBD 1ST FILING	2 RE
A27090	LYNDES, JAY C ✓ 600 INDIAN TRL BILLINGS MT 59105-2702	03-1033-17-1-01-01-0000 HS1 SubDivision HS1 LT 14 BLK 19 HIGH SIERRA SUBD 1ST FILING	2 RE
A27039	POPE, KEVIN G & COURTNEY L ✓ ✓ 859 SIERRA GRANDE BLVD BILLINGS MT 59105-5427	03-1033-17-1-07-01-0000 HS1 SubDivision HS1 LT 1 BLK 13 HIGH SIERRA SUBD 1ST FILING	2 RE
A31315	PRDM, NICHOLAS L & KATIE J ✓ ✓ 1195 SIERRA GRANDE BLVD BILLINGS MT 59105-5426	03-1033-17-1-21-01-0000 HS3 SubDivision HS3 LT 1 BLK 2 HIGH SIERRA SUB 3RD FILING AMD LT 1 BLK 2 HIGH SIERRA 2ND FIL 9607 SF (OLD A30250) (05)	2 RE

*Certified thru
14/2/05 3/2
Dept. of Rev.
Bald*

Ranges: TAX YEAR: (R) 2005 - 2005
 ASSESSOR#: (L) A21999, A26865, A26866,
 A27000, A27001, A27002, A27003,
 A27008, A27009, A27010, A27011,
 A27013, A27013, A27014, A27015,
 A31330, A31331, A31332, A31333,
 A31334, A31353, A31354, A31355,
 A31356, A31357
 TAX TYPE: (A)
 LEVY DISTRICT: (A)
 SUB-LEVY DIST: (A)
 SPECIAL DISTRICT: (A)

OPTIONS: SORT ORDER: N # OF COPIES: 1

Assessor#	Owner/Mailing Address	Legal Description	Levy Dist	Sub Dist	Tax Type	Key #1
A21999 ✓	BERGERSON, DON & JODEE ✓ 1980 GLENDALES BLVD BILLINGS MT 59105-3551	03-1033-16-3-01-21-0000 L17 SubDivision L17 LT 19 BLK 1 LAKE HILLS SUBD 19TH FILING & LT 19A BLK 1 LAKE HILLS SUB 17TH 14,400 SF (COMBO A22000) (03)	2		RE	
A26865 ✓	BRETZ, CALTON L & MARY G ✓ 1957 MOROCCO DR BILLINGS MT 59105-5409	03-1033-17-4-11-67-0000 HS1 SubDivision HS1 LT 65 BLK 1 HIGH SIERRA SUBD 1ST FILING	2		RE	
A27008 ✓	AGREEMENT DATED JULY 3, 2000 ✓ BROADBENT, RONALD L TRUSTEE ✓ 201 QUIET WATER AVE BILLINGS MT 59105-2848	03-1033-17-4-29-51-0000 HS1 SubDivision HS1 LT 26 BLK 10 HIGH SIERRA SUBD 1ST FILING	2		RE	
A31357 ✓	DAWSON BUILDERS ✓ 4736 S WOODHAVEN WAY BILLINGS MT 59106-2494	03-1033-17-4-41-09-0000 HS3 SubDivision HS3 LT 5 BLK 4 HIGH SIERRA SUB 3RD FILING AMD LT 1 BLK 2 HIGH SIERRA SUB 2ND FIL 7459 SF (OLD A30250) (05)	2		RE	
A31331 ✓	DAWSON BUILDERS ✓ 4736 S WOODHAVEN WAY BILLINGS MT 59106-2494	03-1033-17-4-40-05-0000 HS3 SubDivision HS3 LT 3 BLK 3 HIGH SIERRA SUB 3RD FILING AMD LT 1 BLK 2 HIGH SIERRA SUB 2ND FIL 7412 SF (OLD A30250) (05)	2		RE	
A31333 ✓	DAWSON BUILDERS ✓ 4736 S WOODHAVEN WAY BILLINGS MT 59106-2494	03-1033-17-4-40-09-0000 HS3 SubDivision HS3 LT 5 BLK 3 HIGH SIERRA SUB 3RD FILING AMD LT 1 BLK 2 HIGH SIERRA SUB 2ND FIL 7412 SF (OLD A30250) (05)	2		RE	
A31353 ✓	DAWSON BUILDERS ✓ 4736 S WOODHAVEN WAY BILLINGS MT 59106-2494	03-1033-17-4-41-01-0000 HS3 SubDivision HS3 LT 1 BLK 4 HIGH SIERRA SUB 3RD FILING	2		RE	

Assessor#	Dwner/Mailing Address	Legal Description	Levy	Sub	Tax	Dist	Dist	Type	Key #1
A31354 ✓	DAWSON BUILDERS 4736 S WOODHAVEN WAY BILLINGS MT 59106-2494	AMD LT 1 BLK 2 HIGH SIERRA 2ND FIL 9653 SF (OLD A30250) (05) 03-1033-17-4-41-03-0000 HS3 SubDivision HS3 LT 2 BLK 4 HIGH SIERRA SUB 3RD FIL AMD LT 1 BLK 2 HIGH SIERRA SUB 2ND FIL 7406 SF (OLD A30250) (05)	2					RE	
A31356 ✓	DAWSON BUILDERS 4736 S WOODHAVEN WAY BILLINGS MT 59106-2494	03-1033-17-4-41-07-0000 HS3 SubDivision HS3 LT 4 BLK 4 HIGH SIERRA SUB 3RD FILING AMD LT 1 BLK 2 HIGH SIERRA SUB 2ND FIL 7406 SF (OLD A30250) (05)	2					RE	
A31355 ✓	FIRELAKE CORP 3208 RUGBY DR BILLINGS MT 59102-0752	03-1033-17-4-41-05-0000 HS3 SubDivision HS3 LT 3 BLK 4 HIGH SIERRA SUB 3RD FILING AMD LT 1 BLK 2 HIGH SIERRA SUB 2ND FIL 7406 SF (OLO A30250) (05)	2					RE	
A26866 ✓	HUSO, KELLY 1963 MOROCCO DR BILLINGS MT 59105-5409	03-1033-17-4-11-69-0000 HS1 SubDivision HS1 LT 66 BLK 1 HIGH SIERRA SUBD 1ST FILING	2					RE	
A27000 ✓	LYNDES, JAY C 600 INDIAN TRL BILLINGS MT 59105-2702	03-1033-17-4-29-35-0000 HS1 SubDivision HS1 LT 18 BLK 10 HIGH SIERRA SUBD 1ST FILING	2					RE	
A27001 ✓	LYNDES, JAY C 600 INDIAN TRL BILLINGS MT 59105-2702	03-1033-17-4-29-37-0000 HS1 SubDivision HS1 LT 19 BLK 10 HIGH SIERRA SUBD 1ST FILING	2					RE	
A27002 ✓	LYNDES, JAY C 600 INDIAN TRL BILLINGS MT 59105-2702	03-1033-17-4-29-39-0000 HS1 SubDivision HS1 LT 20 BLK 10 HIGH SIERRA SUBD 1ST FILING	2					RE	
A27003 ✓	LYNDES, JAY C 600 INDIAN TRL BILLINGS MT 59105-2702	03-1033-17-4-29-41-0000 HS1 SubDivision HS1 LT 21 BLK 10 HIGH SIERRA SUBD 1ST FILING	2					RE	
A27009 ✓	LYNDES, JAY C 600 INDIAN TRL BILLINGS MT 59105-2702	03-1033-17-4-29-53-0000 HS1 SubDivision HS1 LT 27 BLK 10 HIGH SIERRA SUBD 1ST FILING	2					RE	
A27010 ✓	LYNDES, JAY C 600 INDIAN TRL BILLINGS MT 59105-2702	03-1033-17-4-29-55-0000 HS1 SubDivision HS1 LT 28 BLK 10 HIGH SIERRA SUBD 1ST FILING	2					RE	
A27011 ✓	LYNDES, JAY C 600 INDIAN TRL BILLINGS MT 59105-2702	03-1033-17-4-29-57-0000 HS1 SubDivision HS1 LT 29 BLK 10 HIGH SIERRA SUBD 1ST FILING	2					RE	

Katco Inc
2827 Westwood
Billings, MT 5

Assessor#	Owner/Mailing Address	Legal Description	Levy	Sub	Tax
			Dist	Dist	Type Key #1
A27013 ✓	LYNDES, JAY C ✓ 600 INDIAN TRL BILLINGS MT 59105-2702	03-1033-17-4-29-61-0000 HS1 SubDivision HS1 LT 31 BLK 10 HIGH SIERRA SUBD 1ST FILING	2		RE
A27014 ✓	LYNDES, JAY C ✓ 600 INDIAN TRL BILLINGS MT 59105-2702	03-1033-17-4-29-63-0000 HS1 SubDivision HS1 LT 32 BLK 10 HIGH SIERRA SUBD 1ST FILING	2		RE
A31334 ✓	PIGG, MICHAEL T & NATALIE L ✓ 1131 EL RANCHO DR BILLINGS MT 59105-5424	03-1033-17-4-40-11-0000 HS3 SubDivision HS3 LT 6 BLK 3 HIGH SIERRA SUB 3RD FILING AMD LT 1 BLK 2 HIGH SIERRA SUB 2ND FIL 7412 SF (OLD A30250) (05)	2		RE
A31332 ✓	SWANSON, JEFFERY L & REBECCA N ✓ 1159 EL RANCHO DR BILLINGS MT 59105-5424	03-1033-17-4-40-07-0000 HS3 SubDivision HS3 LT 4 BLK 3 HIGH SIERRA SUB 3RD FILING AMD LT 1 BLK 2 HIGH SIERRA SUB 2ND FIL 7412 SF (OLD A30250) (05)	2		RE
A31330 ✓	TILLEY, RICHARD L & MELISSA L ✓ 1179 EL RANCHO DR BILLINGS MT 59105-5424	03-1033-17-4-40-03-0000 HS3 SubDivision HS3 LT 2 BLK 3 HIGH SIERRA SUB 3RD FILING AMD LT 1 BLK 2 HIGH SIERRA SUB 2ND FIL 7412 SF (OLD A30250) (05)	2		RE
A27015 ✓	WADE, ANNE-MARIE ✓ 840 EL RANCHO DR BILLINGS MT 59105-5412	03-1033-17-4-29-65-0000 HS1 SubDivision HS1 LT 33 BLK 10 HIGH SIERRA SUBD 1ST FILING	2		RE

Ranges: TAX YEAR: (R) 2005 - 2005
 ASSESSOR#: (L) A27012
 TAX TYPE: (A)
 LEVY DISTRICT: (A)
 SUB-LEVY DIST: (A)
 SPECIAL DISTRICT: (A)

OPTIONS: SORT ORDER: N # OF COPIES: 1

Assessor#	Owner/Mailing Address	Legal Description	Levy Dist	Sub Dist	Tax Type	Key #1
A27012	LYNDES, JAY C 600 INDIAN TRL BILLINGS MT 59105-2702	03-1033-17-4-29-59-0000 HS1 SubDivision HS1 LT 30 BLK 10 HIGH SIERRA SUBD 1ST FILING	2		RE	

*Certified true
10/10/05
Dept. of Rev.
Bau*

Ranges: TAX YEAR: (R) 2005 - 2005
ASSESSOR#: (L) A21983, A21984, A26843,
A26844, A26845, A26846, A26874,
A26875, A26876, A26877, A26883,
A26884, A26884A, A26885, A26886,
A26887, A26902, A26903, A26905,
A26906, A27107, A27108, A27109,
A27110, D05245
TAX TYPE: (A)
LEVY DISTRICT: (A)
SUB-LEVY DIST: (A)
SPECIAL DISTRICT: (A)

OPTIONS: SORT ORDER: N # OF COPIES: 1

Assessor#	Owner/Mailing Address	Legal Description	Levy Dist	Sub Dist	Tax Type	Key #1
A27109	ALLRED, CRAIG H & SHERI M 1708 HIGH SIERRA BLVD BILLINGS MT 59105-5413	03-1033-17-4-13-03-0000 HS1 SubDivision HS1 LT 13 BLK 26 HIGH SIERRA SUBD 1ST FILING	2		RE	
A26876	BITRON LLC 1790 HARVEST LN CAMARILLO CA 93012-4247	03-1033-17-4-05-15-0000 HS1 SubDivision HS1 LT 8 BLK 2 HIGH SIERRA SUBD 1ST FILING	2		RE	
D05245	BITRON LLC 1790 HARVEST LN CAMARILLO CA 93012-4247	03-1033-17-4-02-01-0000 TR 3 CDS 2017 2ND AMND TR 2A AMND	2		RE	
A26887	CAIN, ZACHARY D & ROSALIE 1669 FANTAN ST BILLINGS MT 59105-5422	03-1033-17-4-15-11-0000 HS1 SubDivision HS1 LT 6 BLK 3 HIGH SIERRA SUB 1ST	2		RE	
A27108	DONALD C DALLMEYER IRREV TRUST SCHOFF, DDNNA RAE TRUSTEE 1714 HIGH SIERRA BLVD BILLINGS MT 59105-5413	03-1033-17-4-13-05-0000 HS1 SubDivision HS1 LT 12 BLK 26 HIGH SIERRA SUBD 1ST FILING	2		RE	
A27110	DRAPER, C REED & ANNETTE 1702 HIGH SIERRA BLVD BILLINGS MT 59105-5413	03-1033-17-4-13-01-0000 HS1 SubDivision HS1 LT 14 BLK 26 HIGH SIERRA SUBD 1ST FILING	2		RE	
A26886	ROBIN FELTON REVOCABLE TRUST FELTON, ROBIN TRUSTEE 1614 MOROCCD DR BILLINGS MT 59105-5407	03-1033-17-4-15-09-0000 HS1 SubDivision HS1 LT 5 BLK 3 HIGH SIERRA SUBD 1ST FILING	2		RE	
A26874	JENSEN, CRAIG A & JENNIFER 1652 FANTAN ST BILLINGS MT 59105-5421	03-1033-17-4-05-11-0000 HS1 SubDivision HS1 LT 6 BLK 2 HIGH SIERRA SUBD 1ST FILING	2		RE	
A26846	LYNDES, JAY C 600 INDIAN TRL	03-1033-17-4-11-29-0000 HS1 SubDivision HS1	2		RE	

Assessor#	Owner/Mailing Address	Legal Description	Levy Dist	Sub Dist	Tax Type	Key #1
	BILLINGS MT 59105-2702	LT 46 BLK 1 HIGH SIERRA SUBD 1ST FILING				
A26883	LYNDES, JAY C ✓ 600 INDIAN TRL BILLINGS MT 59105-2702	03-1033-17-4-15-01-0000 HS1 SubDivision HS1 LT 1 BLK 3 HIGH SIERRA SUBD 1ST FILING	2		RE	
A26843	LYNDES, JAY C ✓ 600 INDIAN TRL BILLINGS MT 59105-2702	03-1033-17-4-11-23-0000 HS1 SubDivision HS1 LT 43 BLK 1 HIGH SIERRA SUBD 1ST FILING	2		RE	
A26844	LYNDES, JAY C ✓ 600 INDIAN TRL BILLINGS MT 59105-2702	03-1033-17-4-11-25-0000 HS1 SubDivision HS1 LT 44 BLK 1 HIGH SIERRA SUBD 1ST FILING	2		RE	
A26845	LYNDES, JAY C ✓ 600 INDIAN TRL BILLINGS MT 59105-2702	03-1033-17-4-11-27-0000 HS1 SubDivision HS1 LT 45 BLK 1 HIGH SIERRA SUBD 1ST FILING	2		RE	
<u>A26884A</u>	LYNDES, JAY C ✓ 600 INDIAN TRL BILLINGS MT 59105-2702	03-1033-17-4-15-05-0000 HS1 SubDivision HS1	2		RE	
A26884	LYNDES, JAY C ✓ 600 INDIAN TRL BILLINGS MT 59105-2702	03-1033-17-4-15-03-0000 HS1 SubDivision HS1 LT 2 BLK 3 HIGH SIERRA SUBD 1ST FILING	2		RE	
A26906	LYNDES, JAY C ✓ 600 INDIAN TRL BILLINGS MT 59105-2702	03-1033-17-4-17-01-0000 HS1 SubDivision HS1 LT 1 BLK 4 HIGH SIERRA SUBD 1ST FILING	2		RE	
A26905	LYNDES, JAY C ✓ 600 INDIAN TRL BILLINGS MT 59105-2702	03-1033-17-4-15-47-0000 HS1 SubDivision HS1 LT 24 BLK 3 HIGH SIERRA SUBD 1ST FILING	2		RE	
A26902	LYNDES, JAY C ✓ 600 INDIAN TRL BILLINGS MT 59105-2702	03-1033-17-4-15-41-0000 HS1 SubDivision HS1 LT 21 BLK 3 HIGH SIERRA SUBD 1ST FILING	2		RE	
A26885	LYNDES, JAY C ✓ 600 INDIAN TRL BILLINGS MT 59105-2702	03-1033-17-4-15-07-0000 HS1 SubDivision HS1 LT 4 BLK 3 HIGH SIERRA SUBD 1ST FILING	2		RE	
A26903	LYNDES, JAY C ✓ 600 INDIAN TRL BILLINGS MT 59105-2702	03-1033-17-4-15-43-0000 HS1 SubDivision HS1 LT 22 BLK 3 HIGH SIERRA SUBD 1ST FILING	2		RE	
A26877	NEW HOPE ENTERPRISES INC ✓ 3440 MASTERSON CIR BILLINGS MT 59106-9651	03-1033-17-4-05-17-0000 HS1 SubDivision HS1 LT 9 BLK 2 HIGH SIERRA SUBD 1ST FILING	2		RE	
A21984	RDN S HILL LIVING TRUST ✓ PO BOX 50685	03-1033-16-3-01-06-0000 LK1 SubDivision LK1	2		RE	

Assessor#	Owner/Mailing Address	Legal Description	Levy Sub Tax Dist Dist Type Key #1
	BILLINGS MT 59105-0636	LT 6 BLK 1 LAKE HILLS SUBD 1ST FILING	
A29983	RON S HILL LIVING TRUST ✓ PO BOX 50636 BILLINGS MT 59105-0636	03-1033-16-3-01-05-0000 LK1 SubDivision LK1 LT 5 BLK 1 LAKE HILLS SUBD 1ST FILING	2 RE
A27107	SMITH, LARRY GENE & LINDA LOUISE ✓ 118 CEDAR SPRINGS CIR ✓ DEBARY FL 32713-4806	03-1033-17-4-13-07-0000 HS1 SubDivision HS1 LT 11 BLK 26 HIGH SIERRA SUBD 1ST FILING	2 RE
A26875	WHITLEY, WESCOTT & MARGARET ✓ 1666 FANTAN ST ✓ BILLINGS MT 59105-5421	03-1033-17-4-05-13-0000 HS1 SubDivision HS1 LT 7 BLK 2 HIGH SIERRA SUBD 1ST FILING	2 RE

*Certified true
10/9/05
Dept. of Rev
Bair*

Ranges: TAX YEAR: (R) 2005 - 2005
ASSESSOR#: (L) A21980, A26807, A26808,
A26809, A26810, A26811, A26812,
A26813, A26814, A26815, A26816,
A26817, A26818, A26819, A26820,
A26821, A26822, A26823, A26824,
A26825, A26826, A26829, A26870,
A26880, A26881
TAX TYPE: (A)
LEVY DISTRICT: (A)
SUB-LEVY DIST: (A)
SPECIAL DISTRICT: (A)

OPTIONS: SORT ORDER: N # OF COPIES: 1

Assessor#	Owner/Mailing Address	Legal Description	Levy Dist	Sub Dist	Tax Type	Key #1
A26870	FERRAGUTI, ARNOLD & MARSHA 1616 FANTAN ST BILLINGS MT 59105-5421	03-1033-17-4-05-03-0000 HS1 SubDivision HS1 LT 2 BLK 2 HIGH SIERRA SUBD 1ST FILING	2		RE	
A26880	HENTGES, KORY E & KERRY A 1635 PICADOR PL BILLINGS MT 59105-5437	03-1033-17-4-05-23-0000 HS1 SubDivision HS1 LT 12 BLK 2 HIGH SIERRA SUBD 1ST FILING	2		RE	
A21980	JORDEN, EDWARD 50 MOORE LN BILLINGS MT 59101-3413	03-1033-16-3-01-02-0000 LK1 SubDivision LK1 LT 2 BLK 1 LAKE HILLS SUBD 1ST FILING	2		RE	
A26829	KUNKEL, CAL 3310 LAREDO PL BILLINGS MT 59102-0122	03-1033-17-4-07-57-0000 HS1 SubDivision HS1 LT 29A BLK 1 HIGH SIERRA SUBD 1ST FILING AMD LTS 27-31 BLK 1 (05)	2		RE	
A26818	LYNDES, JAY C 600 INDIAN TRL BILLINGS MT 59105-2702	03-1033-17-4-07-35-0000 HS1 SubDivision HS1 LT 18 BLK 1 HIGH SIERRA SUBD 1ST FILING	2		RE	
A26817	LYNDES, JAY C 600 INDIAN TRL BILLINGS MT 59105-2702	03-1033-17-4-07-33-0000 HS1 SubDivision HS1 LT 17 BLK 1 HIGH SIERRA SUBD 1ST FILING	2		RE	
A26816	LYNDES, JAY C 600 INDIAN TRL BILLINGS MT 59105-2702	03-1033-17-4-07-31-0000 HS1 SubDivision HS1 LT 16 BLK 1 HIGH SIERRA SUBD 1ST FILING	2		RE	
A26815	LYNDES, JAY C 600 INDIAN TRL BILLINGS MT 59105-2702	03-1033-17-4-07-29-0000 HS1 SubDivision HS1 LT 15 BLK 1 HIGH SIERRA SUBD 1ST FILING	2		RE	
A26814	LYNDES, JAY C 600 INDIAN TRL BILLINGS MT 59105-2702	03-1033-17-4-07-27-0000 HS1 SubDivision HS1 LT 14 BLK 1 HIGH SIERRA SUBD 1ST FILING	2		RE	

Assessor#	Owner/Mailing Address	Legal Description	Levy Sub Tax Dist Dist Type Key #1
A26826	TRACTOR & EQUIPMENT CO PO BOX 3562 SEATTLE WA 98124-3562	03-1033-17-4-07-51-0000 HS1 SubDivision HS1 LT 26 BLK 1 HIGH SIERRA SUBD 1ST FILING	2 RE
A26821	TRACTOR & EQUIPMENT CO PO BOX 3562 SEATTLE WA 98124-3562	03-1033-17-4-07-41-0000 HS1 SubDivision HS1 LT 21 BLK 1 HIGH SIERRA SUBD 1ST FILING	2 RE
A26822	TRACTOR & EQUIPMENT CO PO BOX 3562 SEATTLE WA 98124-3562	03-1033-17-4-07-43-0000 HS1 SubDivision HS1 LT 22 BLK 1 HIGH SIERRA SUBD 1ST FILING	2 RE

*Certified true
10/19/05 3/23/06
Dept. of Rev.
Paul C.*

Ranges: TAX YEAR: (R) 2005 - 2005
ASSESSOR#: (L) A21979, A26869, A26882, A27112
TAX TYPE: (A)
LEVY DISTRICT: (A)
SUB-LEVY DIST: (A)
SPECIAL DISTRICT: (A)

OPTIONS: SORT ORDER: N # OF COPIES: 1

Assessor#	Owner/Mailing Address	Legal Description	Levy Dist	Sub Dist	Tax Type	Key #1
A26882	BONINI ENTERPRISES LLC ✓ 289 CAPE COD DR BILLINGS MT 59102-6906	03-1033-17-4-05-27-0000 HS1 SubDivision HS1 LT 14 BLK 2 HIGH SIERRA SUBD 1ST FILING	2		RE	
A26869	JORDAN, GEORGE R & CHRISTINA J ✓ 1608 FANTAN ST ✓ BILLINGS MT 59105-5421	03-1033-17-4-05-01-0000 HS1 SubDivision HS1 L:1 B:2 HIGH SIERRA SUB 1ST	2		RE	
A21979	SHINY RIDE INC ✓ 420 DURANGO PL BILLINGS MT 59101-6869	03-1033-16-3-01-01-0000 LK1 SubDivision LK1 LT 1A RMND LT 1 BLK 1 LAKE HILLS SUBD 1ST FILING	2		RE	
A27112	YELLOWSTONE COUNTY ✓ PO BOX 35001 BILLINGS MT 59107-5001	03-1033-17-4-09-01-0000 HS1 SubDivision HS1 LT 1 BLK 44 HIGH SIERRA SUBD 1ST FILING	2		RE	

*Certified true
10/2/05 3/2
Dept. of Rev.
Paul C*

Ranges: TAX YEAR: (R) 2005 - 2005
ASSESSOR#: (L) A21985A, A21985B, A21986A,
A21986B, A21986C, A26847, A26848,
A26888, A26889, A26890, A26891,
A26898, A26899, A26900, A26901,
A26904, A26907, A26908, A26909,
A26920, A26920A, A27105, A27106
TAX TYPE: (A)
LEVY DISTRICT: (A)
SUB-LEVY DIST: (A)
SPECIAL DISTRICT: (A)

OPTIDNS: SORT ORDER: N # OF COPIES: 1

Assessor#	Owner/Mailing Address	Legal Description	Levy Dist	Sub Dist	Tax Type	Key #1
A26890	EDWARDS, MARTY W & CARLA L 990 SOLITA DR BILLINGS MT 59105-5423	03-1033-17-4-15-17-0000 HS1 SubDivision HS1 LT 9 BLK 3 HIGH SIERRA SUBD 1ST FILING	2		RE	
A21986B	GOGGINS, MICHAEL 1728 GLENEAGLES BLVD BILLINGS MT 59105-3556	03-1033-16-3-01-08-7002 LK1 SubDivision LK1 UNIT B ACUTE TOWNHOMES LT 8 BLK 1 LAKES HILLS 1ST FILING 30% INT IN COMMON ELEMENTS	2		RE	
A21986C	GUZMAN, LINDA L 1730 GLENEAGLES BLVD BILLINGS MT 59105-3556	03-1033-16-3-01-08-7003 LK1 SubDivision LK1 UNIT C ACUTE TOWNHOMES LT 8 BLK 1 LAKE HILLS 1ST FILING 35% INT IN COMMON ELEMENTS	2		RE	
A26888	HOCHHALTER, LDWELL E & TAMARA L 1675 FANTAN ST BILLINGS MT 59105-5422	03-1033-17-4-15-13-0000 HS1 SubDivision HS1 LT 7 BLK 3 HIGH SIERRA SUBD 1ST FILING	2		RE	
A26891	HOLMES, ANDREW R F & BARBARA 976 SOLITA DR BILLINGS MT 59105-5423	03-1033-17-4-15-19-0000 HS1 SubDivision HS1 LT 10 BLK 3 HIGH SIERRA SUBD 1ST FILING	2		RE	
A26898	ICOPINI, ERNIE PD BOX 426 HYSHAM MT 59038-0426	03-1033-17-4-15-33-0000 HS1 SubDivision HS1 LT 17 BLK 3 HIGH SIERRA SUBD 1ST FILING	2		RE	
A21985B	LAUER, TONY R & EVA M 1694 GLENEAGLES BLVD # B BILLINGS MT 59105-3567	03-1033-16-3-01-07-7002 LK1 SubDivision LK1 UNIT B DIAMOND TOWNHOMES LOCATED ON LT 1 BLK 1 LAKE HILLS SUB 1ST UNDIVIDED 1/2% INT COMMON ELEMENTS (03)	2		RE	
A21985A	LENOX, OLIVE W 1692 GLENEAGLES BLVD BILLINGS MT 59105	03-1033-16-3-01-07-7001 LK1 SubDivision LK1 UNIT A DIAMOND TOWNHOMES	2		RE	

Assessor#	Owner/Mailing Address	Legal Description	Levy Dist	Sub Dist	Tax Type	Key #1
LOCATED ON LT 7 BLK 1 LAKE HILLS SUB 1ST UNDIVIDED 1/2 INT CDMON ELEMENTS (03)						
A26848	LYNDES, JAY C ✓ 600 INDIAN TRL BILLINGS MT 59105-2702	03-1033-17-4-11-33-0000 HS1 SubDivision HS1 LT 48 BLK 1 HIGH SIERRA SUBD 1ST FILING	2		RE	
A26847	LYNDES, JAY C ✓ 600 INDIAN TRL BILLINGS MT 59105-2702	03-1033-17-4-11-31-0000 HS1 SubDivision HS1 LT 47 BLK 1 HIGH SIERRA SUBD 1ST FILING	2		RE	
A26909	LYNDES, JAY C ✓ 600 INDIAN TRL BILLINGS MT 59105-2702	03-1033-17-4-17-07-0000 HS1 SubDivision HS1 LT 4 BLK 4 HIGH SIERRA SUBD 1ST FILING	2		RE	
A26920	LYNDES, JAY C ✓ 600 INDIAN TRL BILLINGS MT 59105-2702	03-1033-17-4-17-29-0000 HS1 SubDivision HS1 LT 15 BLK 4 HIGH SIERRA SUBD 1ST FILING	2		RE	
A26900	LYNDES, JAY C ✓ 600 INDIAN TRL BILLINGS MT 59105-2702	03-1033-17-4-15-37-0000 HS1 SubDivision HS1 LT 19 BLK 3 HIGH SIERRA SUBD 1ST FILING	2		RE	
A26899	LYNDES, JAY C ✓ 600 INDIAN TRL BILLINGS MT 59105-2702	03-1033-17-4-15-35-0000 HS1 SubDivision HS1 LT 18 BLK 3 HIGH SIERRA SUBD 1ST FILING	2		RE	
A26908	LYNDES, JAY C ✓ 600 INDIAN TRL BILLINGS MT 59105-2702	03-1033-17-4-17-05-0000 HS1 SubDivision HS1 LT 3 BLK 4 HIGH SIERRA SUBD 1ST FILING	2		RE	
A26904	LYNDES, JAY C ✓ 600 INDIAN TRL BILLINGS MT 59105-2702	03-1033-17-4-15-45-0000 HS1 SubDivision HS1 LT 23 BLK 3 HIGH SIERRA SUBD 1ST FILING	2		RE	
A26907	LYNDES, JAY C ✓ 600 INDIAN TRL BILLINGS MT 59105-2702	03-1033-17-4-17-03-0000 HS1 SubDivision HS1 LT 2 BLK 4 HIGH SIERRA SUBD 1ST FILING	2		RE	
A26901	LYNDES, JAY C ✓ 600 INDIAN TRL BILLINGS MT 59105-2702	03-1033-17-4-15-39-0000 HS1 SubDivision HS1 LT 20 BLK 3 HIGH SIERRA SUBD 1ST FILING	2		RE	
<u>A26920A</u>	LYNDES, JAY C ✓ 600 INDIAN TRL BILLINGS MT 59105-2702	03-1033-17-4-17-31-0000 HS1 SubDivision HS1	2		RE	
A27105	MARTIN, BRADLEY A & SHANDRA M ✓ 1750 HIGH SIERRA BLVD ✓ BILLINGS MT 59105-5413	03-1033-17-4-13-11-0000 HS1 SubDivision HS1 LT 9 BLK 26 HIGH SIERRA SUB 1ST	2		RE	
A27106	SMITH, THAD & SIRI ✓ ✓	03-1033-17-4-13-09-0000	2		RE	

Assessor#	Owner/Mailing Address	Legal Description	Levy	Sub	Tax
			Dist	Dist	Type Key #1
	1738 HIGH SIERRA BLVD BILLINGS MT 59105-5413	HS1 SubDivision HS1 LT 10 BLK 26 HIGH SIERRA SUBD 1ST FILING			
A26889	WATSON, LARRY D & TAMMY J 1687 FANTAN ST BILLINGS MT 59105-5422	03-1033-17-4-15-15-0000 HS1 SubDivision HS1 LT 8 BLK 3 HIGH SIERRA SUBD 1ST FILING	2		RE
A21986A	WHEELER, LELAND W & JEAN D 1726 GLENEAGLES BLVD BILLINGS MT 59105-3556	03-1033-16-3-01-08-7001 Lk1 SubDivision Lk1 UNIT A AGATE TOWNHOMES LT 8 BLK 1 LAKES HILLS 1ST FILING 35% INT IN COMMON ELEMENTS	2		RE

*Certified thru
10/4/05
Dept. of Rev.
Bair*

Ranges: TAX YEAR: (R) 2005 - 2005
ASSESSOR#: (L) A21995, A21996, A26859,
A26860, A26861, A26959, A26960,
A26961, A26962, A26963, A26964,
A26965, A26966, A26967, A26971,
A26972, A26973, A26974, A26975,
A26991, A26992, A27094, A27096, A27113
TAX TYPE: (A)
LEVY DISTRICT: (A)
SUB-LEVY DIST: (A)
SPECIAL DISTRICT: (A)

OPTIONS: SORT ORDER: N # OF COPIES: 1

Assessor#	Owner/Mailing Address	Legal Description	Levy Dist	Sub Dist	Tax Type	Key #1
A26860	✓ ANGLE, ROBERT D & DEBRA C 1875 MOROCCO DR BILLINGS MT 59105-5410	03-1033-17-4-11-57-0000 HS1 SubDivision HS1 LT 60 BLK 1 HIGH SIERRA SUBD 1ST FILING	2		RE	
A27113	✓ BILLINGS HIGH SCHOOL DISTRICT # 2 415 N 30TH ST BILLINGS MT 59101-1252	03-1033-17-4-03-01-0000 HS1 SubDivision HS1 LT 1 BLK 45 HIGH SIERRA SUBD 1ST FILING	2		RE	
A26966	✓ BLISS, DONNA M 2424 LOCUST ST BILLINGS MT 59101-0554	03-1033-17-4-27-21-0000 HS1 SubDivision HS1 LT 12 BLK 8 HIGH SIERRA SUBD 1ST FILING	2		RE	
A26964	✓ BLISS, DONNA M 2424 LOCUST ST BILLINGS MT 59101-0554	03-1033-17-4-27-25-0000 HS1 SubDivision HS1 LT 10 BLK 8 HIGH SIERRA SUBD 1ST FILING	2		RE	
A27094	✓ JOHNSON, DAVID R & KATHLEEN E 1890 HIGH SIERRA BLVD BILLINGS MT 59105-5411	03-1033-17-3-30-05-0000 HS1 SubDivision HS1 LT 1 BLK 25 HIGH SIERRA SUB 1ST	2		RE	
A26959	✓ KIDGELL, KARSON K & WAMELA G 865 ADOBE DR BILLINGS MT 59105-5403	03-1033-17-4-27-05-0000 HS1 SubDivision HS1 LT 5 BLK 8 HIGH SIERRA SUBD 1ST FILING	2		RE	
A26859	✓ KUYKENDALL, RONNIE G 1865 MORDCCO DR BILLINGS MT 59105-5410	03-1033-17-4-11-55-0000 HS1 SubDivision HS1 LT 59 BLK 1 HIGH SIERRA SUBD 1ST FILING	2		RE	
A26971	✓ LYNDES, JAY C 600 INDIAN TRL BILLINGS MT 59105-2702	03-1033-17-4-25-17-0000 HS1 SubDivision HS1 LT 2 BLK 9 HIGH SIERRA SUBD 1ST FILING	2		RE	
A26972	✓ LYNDES, JAY C 600 INDIAN TRL BILLINGS MT 59105-2702	03-1033-17-4-25-15-0000 HS1 SubDivision HS1 LT 3 BLK 9 HIGH SIERRA SUBD 1ST FILING	2		RE	
A26973	✓ LYNDES, JAY C	03-1033-17-4-25-13-0000	2		RE	

Assessor#	Owner/Mailing Address	Legal Description	Levy	Sub	Tax
			Dist	Dist	Type Key #1
	600 INDIAN TRL BILLINGS MT 59105-2702	HS1 SubDivision HS1 LT 4 BLK 9 HIGH SIERRA SUBD 1ST FILING			
A26974	✓ LYNDES, JAY C 600 INDIAN TRL BILLINGS MT 59105-2702	03-1033-17-4-25-11-0000 HS1 SubDivision HS1 LT 5 BLK 9 HIGH SIERRA SUBD 1ST FILING	2		RE
A26991	✓ LYNDES, JAY C 600 INDIAN TRL BILLINGS MT 59105-2702	03-1033-17-4-29-17-0000 HS1 SubDivision HS1 LT 9 BLK 10 HIGH SIERRA SUBD 1ST FILING	2		RE
A26992	✓ LYNDES, JAY C 600 INDIAN TRL BILLINGS MT 59105-2702	03-1033-17-4-29-19-0000 HS1 SubDivision HS1 LT 10 BLK 10 HIGH SIERRA SUBD 1ST FILING	2		RE
A26967	✓ LYNDES, JAY C 600 INDIAN TRL BILLINGS MT 59105-2702	03-1033-17-4-27-19-0000 HS1 SubDivision HS1 LT 13 BLK 8 HIGH SIERRA SUBD 1ST FILING	2		RE
A27096	✓ GEORGE R MADDEN TRUST MADDEN, GEORGE R TRUSTEE 1880 HIGH SIERRA BLVD BILLINGS MT 59105-5411	03-1033-17-3-30-03-0000 HS1 SubDivision HS1 LT 15 BLK 25 HIGH SIERRA SUBD 1ST FILING	2		RE
A26975	✓ MEYER, DANA P & LISA M 1895 FANTAN ST BILLINGS MT 59105-5425	03-1033-17-4-25-09-0000 HS1 SubDivision HS1 LT 6 BLK 9 HIGH SIERRA SUBD 1ST FILING	2		RE
A21895	✓ MYERS, WILLIAM E & JACQUELINE A 1870 GLENEAGLES BLVD BILLINGS MT 59105	03-1033-16-3-01-17-0000 L19 SubDivision L19 LT 15 BLK 1 LAKE HILLS SUBD 19TH FILING	2		RE
A26962	✓ PASSON, GREGORY J & ASHLEY B 842 TIERRA DR BILLINGS MT 59105-5414	03-1033-17-4-27-29-0000 HS1 SubDivision HS1 LT 8 BLK 8 HIGH SIERRA SUBD 1ST FILING	2		RE
A26861	✓ PETERS, LARRY D & DONNA R 1885 MOROCCO DR BILLINGS MT 59105-5410	03-1033-17-4-11-59-0000 HS1 SubDivision HS1 LT 61 BLK 1 HIGH SIERRA SUB 1ST FILING	2		RE
A26965	✓ POLETTE, THOMAS L & JULIANN C 1409 LONGHORN WAY BILLINGS MT 59105-4650	03-1033-17-4-27-23-0000 HS1 SubDivision HS1 LT 11 BLK 8 HIGH SIERRA SUBD 1ST FILING	2		RE
A26963	✓ POLETTE, THOMAS L & JULIANN C 1409 LONGHORN WAY BILLINGS MT 59105-4650	03-1033-17-4-27-27-0000 HS1 SubDivision HS1 LT 9 BLK 8 HIGH SIERRA SUBD 1ST FILING	2		RE
A21896	✓ SCHNEIDER ENTERPRISES 2009 BRASSY DR LAS VEGAS NV 89142-2033	03-1033-16-3-01-18-0000 L19 SubDivision L19 LT 16 BLK 1 LAKE HILLS SUBD 19TH FILING	2		RE

Assessor#	Owner/Mailing Address	Legal Description	Levy Sub Tax		
			Dist	Dist	Type Key #1
A26961	✓ GUNNINGHAM, GERYL VANCE, C CHRISTOPHER & 841 ADOBE DR BILLINGS MT 59105-5403	03-1033-17-4-27-01-0000 HS1 SubDivision HS1 LT 7 BLK 8 HIGH SIERRA SUBD 1ST FILING	2		RE
A26960	✓ WELZENBACH, KARL M & JUDY A 859 ADOBE DR BILLINGS MT 59105-5403	03-1033-17-4-27-03-0000 HS1 SubDivision HS1 LT 6 BLK 8 HIGH SIERRA SUBD 1ST FILING	2		RE

TA Reports - Parcel Master List

Certified true
10/19/05 3/23
Dept. of Rev.
Baile

Ranges: TAX YEAR: (R) 2005 - 2005
ASSESSOR#: (L) A21981, A21982, A26801,
A26802, A26803, A26804, A26805,
A26806, A26832, A26833, A26834,
A26835, A26836, A26837, A26838,
A26839, A26840, A26841, A26842,
A26871, A26872, A26873, A26878,
A26879, A27111
TAX TYPE: (A)
LEVY DISTRICT: (A)
SUB-LEVY DIST: (A)
SPECIAL DISTRICT: (A)

OPTIONS: SORT ORDER: N # OF COPIES: 1

Assessor#	Owner/Mailing Address	Legal Description	Levy Sub Tax Dist Dist Type Key #1
A26879	✓ BONINI, JOSEPH A 3448 TAHOE DRIVE BILLINGS MT 59102	03-1033-17-4-05-21-0000 HS1 SubDivision HS1 LT 11 BLK 2 HIGH SIERRA SUBD 1ST FILING	2 RE
A26871	✓ BOTNEN, ROBERT D & SUSAN L 1624 FANTAN ST BILLINGS MT 59105-5421	03-1033-17-4-05-05-0000 HS1 SubDivision HS1 LT 3 BLK 2 HIGH SIERRA SUBD 1ST FILING	2 RE
A26872	✓ JENSEN, DAVID E & MELISSA K 1632 FANTAN ST BILLINGS MT 59105-5423	03-1033-17-4-05-07-0000 HS1 SubDivision HS1 LT 4 BLK 2 HIGH SIERRA SUBD 1ST FILING	2 RE
A27111	✓ JOHNSON, RICHARD A & JANA R 2722 CUSTER AVE BILLINGS MT 59102-4520	03-1033-17-3-10-01-0000 HS1 SubDivision HS1 LT 3 BLK 27 HIGH SIERRA SUBD 1ST FILING	2 RE
A21981	✓ JORDEN, EDWARD 50 MOORE LN BILLINGS MT 59101-3413	03-1033-16-3-01-03-0000 LK1 SubDivision LK1 LT 3 BLK 1 LAKE HILLS SUB 1ST	2 RE
A26836	✓ LYNDES, JAY C 600 INDIAN TRL BILLINGS MT 59105-2702	03-1033-17-4-11-09-0000 HS1 SubDivision HS1 LT 36 BLK 1 HIGH SIERRA SUBD 1ST FILING	2 RE
A26835	✓ LYNDES, JAY C 600 INDIAN TRL BILLINGS MT 59105-2702	03-1033-17-4-11-07-0000 HS1 SubDivision HS1 LT 35 BLK 1 HIGH SIERRA SUBD 1ST FILING	2 RE
A26834	✓ LYNDES, JAY C 600 INDIAN TRL BILLINGS MT 59105-2702	03-1033-17-4-11-05-0000 HS1 SubDivision HS1 LT 34 BLK 1 HIGH SIERRA SUBD 1ST FILING	2 RE
A26833	✓ LYNDES, JAY C 600 INDIAN TRL BILLINGS MT 59105-2702	03-1033-17-4-11-03-0000 HS1 SubDivision HS1 LT 33 BLK 1 HIGH SIERRA SUBD 1ST FILING	2 RE

Assessor#	Owner/Mailing Address	Legal Description	Levy	Sub	Tax
			Dist	Dist	Type Key #1
A26837	✓ LYNDES, JAY C 600 INDIAN TRL BILLINGS MT 59105-2702	03-1033-17-4-11-11-0000 HS1 SubDivision HS1 LT 37 BLK 1 HIGH SIERRA SUBD 1ST FILING	2		RE
A26838	✓ LYNDES, JAY C 600 INDIAN TRL BILLINGS MT 59105-2702	03-1033-17-4-11-13-0000 HS1 SubDivision HS1 LT 38 BLK 1 HIGH SIERRA SUBD 1ST FILING	2		RE
A26839	✓ LYNDES, JAY C 600 INDIAN TRL BILLINGS MT 59105-2702	03-1033-17-4-11-15-0000 HS1 SubDivision HS1 LT 39 BLK 1 HIGH SIERRA SUBD 1ST FILING	2		RE
A26840	✓ LYNDES, JAY C 600 INDIAN TRL BILLINGS MT 59105-2702	03-1033-17-4-11-17-0000 HS1 SubDivision HS1 LT 40 BLK 1 HIGH SIERRA SUBD 1ST FILING	2		RE
A26841	✓ LYNDES, JAY C 600 INDIAN TRL BILLINGS MT 59105-2702	03-1033-17-4-11-19-0000 HS1 SubDivision HS1 LT 41 BLK 1 HIGH SIERRA SUBD 1ST FILING	2		RE
A26842	✓ LYNDES, JAY C 600 INDIAN TRL BILLINGS MT 59105-2702	03-1033-17-4-11-21-0000 HS1 SubDivision HS1 LT 42 BLK 1 HIGH SIERRA SUBD 1ST FILING	2		RE
A26801	✓ LYNDES, JAY C 600 INDIAN TRL BILLINGS MT 59105-2702	03-1033-17-4-07-01-0000 HS1 SubDivision HS1 LT 1 BLK 1 HIGH SIERRA SUBD 1ST FILING	2		RE
A26802	✓ LYNDES, JAY C 600 INDIAN TRL BILLINGS MT 59105-2702	03-1033-17-4-07-03-0000 HS1 SubDivision HS1 LT 2 BLK 1 HIGH SIERRA SUBD 1ST FILING	2		RE
A26803	✓ LYNDES, JAY C 600 INDIAN TRL BILLINGS MT 59105-2702	03-1033-17-4-07-05-0000 HS1 SubDivision HS1 LT 3 BLK 1 HIGH SIERRA SUBD 1ST FILING	2		RE
A26804	✓ LYNDES, JAY C 600 INDIAN TRL BILLINGS MT 59105-2702	03-1033-17-4-07-07-0000 HS1 SubDivision HS1 LT 4 BLK 1 HIGH SIERRA SUBD 1ST FILING	2		RE
A26805	✓ LYNDES, JAY C 600 INDIAN TRL BILLINGS MT 59105-2702	03-1033-17-4-07-09-0000 HS1 SubDivision HS1 LT 5 BLK 1 HIGH SIERRA SUBD 1ST FILING	2		RE
A21982	✓ N D I PROPERTIES LLC PO BOX 50955 BILLINGS MT 59105-0900	03-1033-16-3-01-04-0000 LK1 SubDivision LK1 LT 4 BLK 1 LAKE HILLS SUBD 1ST FILING	2		RE
A26873	✓ OF GOD, INC NORTH CENTRAL REGION CHURCH PO BOX 7460 BISMARCK ND 58507-7460	03-1033-17-4-05-09-0000 HS1 SubDivision HS1 LT 5 BLK 2 HIGH SIERRA SUBD 1ST FILING	2		RE

Assessor#	Owner/Mailing Address	Legal Description	Levy Sub Tax Dist Dist Type Key #1
A26806	✓ RISTDVSKI, ZORAN PETRE 35318 MAUREEN DR STERLING HTS MI 48310-4765	03-1033-17-4-07-11-0000 HS1 SubDivision HS1 LT 6 BLK 1 HIGH SIERRA SUBD 1ST FILING	2 RE
A26878	✓ ROSALES, MARK S & ✓ LORI A 1649 PICADOR PL BILLINGS MT 59105-5437	03-1033-17-4-05-19-0000 HS1 SubDivision HS1 LT 10 BLK 2 HIGH SIERRA SUBD 1ST FILING	2 RE
A26832	✓ SHANNON, MICHAEL P F & ✓ KATHY 1611 MOROCCO DR BILLINGS MT 59105-5406	03-1033-17-4-1I-01-0000 HS1 SubDivision HS1 LT 32 BLK 1 HIGH SIERRA SUBD 1ST FILING	2 RE

Ranges: TAX YEAR: (R) 2005 - 2005
 ASSESSOR#: (L) A21990A, A21990B, A21991A,
 A26852, A26853, A26854, A26912,
 A26913, A26914, A26915, A26916,
 A26932, A26933, A26934, A26935,
 A26937, A26938, A26939, A26953,
 A26954, A27100, A27101, A27102
 TAX TYPE: (A)
 LEVY DISTRICT: (A)
 SUB-LEVY DIST: (A)
 SPECIAL DISTRICT: (A)

*Certified thru
 10/10/05 3:23
 Dept. of Rec
 Bail*

OPTIONS: SORT ORDER: N # OF COPIES: 1

Assessor#	Owner/Mailing Address	Legal Description	Levy Dist	Sub Dist	Tax Type	Key #1
A26938	AMUNDSEN, BRAD D & SUSAN K 921 SOLITA DR BILLINGS MT 59105-5429	03-1033-17-4-19-03-0000 HS1 SubDivision HS1 LT 8 BLK 6 HIGH SIERRA SUBD 1ST FILING	2		RE	
A27101	BACON, JUDY M 1804 HIGH SIERRA BLVD BILLINGS MT 59105-5411	03-1033-17-4-13-19-0000 HS1 SubDivision HS1 LT 5 BLK 26 HIGH SIERRA SUB 1ST	2		RE	
A21990A	BOUGHN, JOSEPH K & JOYCE E 1768 GLENEAGLES BLVD BILLINGS MT 59105-3556	03-1033-16-3-01-12-7001 LK3 SubDivision LK3 UNIT A OPAL TOWNHOMES (04) UNDIV 50% INT COMMON ELEMENTS LT 11 BLK 4 LAKE HILLS SUB 3RD FILING	2		RE	
A27102	CLARK, QUINCY E & SARAH R 1792 HIGH SIERRA BLVD BILLINGS MT 59105-5413	03-1033-17-4-13-17-0000 HS1 SubDivision HS1 LT 6 BLK 26 HIGH SIERRA SUBD 1ST FILING	2		RE	
A21991A	COOK, KAREN F 1812 GLENEAGLES BLVD BILLINGS MT 59105-3561	03-1033-16-3-01-13-7001 LK3 SubDivision LK3 UNIT A PEARL TOWNHOMES (04) UNDIV 50% INT COMMON ELEMENTS LT 12 BLK 1 LAKE HILLS SUB 3RD FILING	2		RE	
A26854	GRUNOW, MATTHEW M CULVER, KASIE & 1805 MOROCCO DR BILLINGS MT 59105-5410	03-1033-17-4-11-45-0000 HS1 SubDivision HS1 LT 54 BLK 1 HIGH SIERRA SUBD 1ST FILING	2		RE	
A26933	FLAGLER, BERNIE L & EUNICE Y 960 ADOBE DR BILLINGS MT 59105-5404	03-1033-17-4-19-17-0000 HS1 SubDivision HS1 LT 3 BLK 6 HIGH SIERRA SUBD 1ST FILING	2		RE	
A26853	GIPE, JUSTIN W & LEIGH E 1785 MOROCCO DR BILLINGS MT 59105	03-1033-17-4-11-43-0000 HS1 SubDivision HS1 LT 53 BLK 1 HIGH SIERRA SUBD 1ST FILING	2		RE	

*Fogle, LYLE G
 RE Fogle, Debora
 Same address*

Assessor#	Owner/Mailing Address	Legal Description	Levy Dist	Sub Dist	Tax Type	Key #1
	BILLINGS MT 59105-5404 ✓	LT 5 BLK 6 HIGH SIERRA SUBD 1ST FILING				
A26939	SMITH, DARIN J & KRISTIE L 939 SOLITA DR	03-1033-17-4-19-05-0000 HS1 SubDivision HS1	2		RE	
	BILLINGS MT 59105-5429	LT 9 BLK 6 HIGH SIERRA SUBD 1ST FILING				
A26934	SULLIVAN, JAMES J III ✓ 942 ADOBE DR	03-1033-17-4-19-19-0000 HS1 SubDivision HS1	2		RE	
	BILLINGS MT 59105-5404	LT 4 BLK 6 HIGH SIERRA SUBD 1ST FILING				

*Certified true
10/28/05 3/2
Dept. of Rev.
Baul C*

Ranges: TAX YEAR: (R) 2005 - 2005
ASSESSOR#: (L) A21988A, A21988B, A21989A,
A21989B, A26849, A26850, A26851,
A26892, A26893, A26894, A26895,
A26896, A26897, A26910, A26911,
A26917, A26918, A26919, A26931,
A26940, A26941, A26942, A27103, A27104
TAX TYPE: (A)
LEVY DISTRICT: (A)
SUB-LEVY DIST: (A)
SPECIAL DISTRICT: (A)

OPTIONS: SORT ORDER: N # OF COPIES: 1

Assessor#	Owner/Mailing Address	Legal Description	Levy Dist	Sub Dist	Tax Type	Key #1
A27104	✓ ANDERSEN, JASON D & MARGO K 1768 HIGH SIERRA BLVD BILLINGS MT 59105-5413	03-1033-17-4-13-13-0000 HS1 SubDivision HS1 LT 8 BLK 26 HIGH SIERRA SUBD 1ST FILING	2		RE	
A26897	✓ AGREEMENT DATED JULY 3, 2000 ✓ BROADBENT, RONALD L TRUSTEE 201 QUIET WATER AVE BILLINGS MT 59105-2848	03-1033-17-4-15-31-0000 HS1 SubDivision HS1 LT 16 BLK 3 HIGH SIERRA SUBD 1ST FILING	2		RE	
A21989A	✓ DOLNEY, THEODORE M & DARLENE R 1744 GLENEGLES BLVD BILLINGS MT 59105-3556	03-1033-16-3-01-11-7001 LK3 SubDivision LK3 UNIT A JADE TOWNHOMES (04) 50% INT COMMON ELEMENTS LT 10 BLK 1 LAKE HILLS SUB 3RD FILING	2		RE	
A26942	✓ EDWARDS, TOBY S & GIDGET L 993 SOLITA DR BILLINGS MT 59105-5429	03-1033-17-4-19-11-0000 HS1 SubDivision HS1 LT 12 BLK 6 HIGH SIERRA SUBD 1ST FILING	2		RE	
A21989B	✓ HOFACKER, MYRTLE E 1746 GLENEGLES BLVD BILLINGS MT 59105-3556	03-1033-16-3-01-11-7002 LK3 SubDivision LK3 UNIT B JADE TOWNHOMES (04) 50% INT COMMON ELEMENTS LT 10 BLK 1 LAKE HILLS SUB 3RD FILING	2		RE	
A26851	✓ LYNDES, JAY C 600 INDIAN TRL BILLINGS MT 59105-2702	03-1033-17-4-11-39-0000 HS1 SubDivision HS1 LT 51 BLK 1 HIGH SIERRA SUBD 1ST FILING	2		RE	
A26850	✓ LYNDES, JAY C 600 INDIAN TRL BILLINGS MT 59105-2702	03-1033-17-4-11-37-0000 HS1 SubDivision HS1 LT 50 BLK 1 HIGH SIERRA SUBD 1ST FILING	2		RE	
A26893	✓ LYNDES, JAY C 600 INDIAN TRL BILLINGS MT 59105-2702	03-1033-17-4-15-23-0000 HS1 SubDivision HS1 LT 12 BLK 3 HIGH SIERRA SUBD 1ST FILING	2		RE	

Assessor#	Owner/Mailing Address	Legal Description	Levy Dist	Sub Dist	Tax Type	Key #1
A26895	✓ LYNDES, JAY C 600 INDIAN TRL BILLINGS MT 59105-2702	03-1033-17-4-15-27-0000 HS1 SubDivision HS1 LT 14 BLK 3 HIGH SIERRA SUBD 1ST FILING	2		RE	
A26896	✓ LYNDES, JAY C 600 INDIAN TRL BILLINGS MT 59105-2702	03-1033-17-4-15-29-0000 HS1 SubDivision HS1 LT 15 BLK 3 HIGH SIERRA SUBD 1ST FILING	2		RE	
A26849	✓ LYNDES, JAY C 600 INDIAN TRL BILLINGS MT 59105-2702	03-1033-17-4-11-35-0000 HS1 SubDivision HS1 LT 49 BLK 1 HIGH SIERRA SUBD 1ST FILING	2		RE	
A26919	✓ LYNDES, JAY C 600 INDIAN TRL BILLINGS MT 59105-2702	03-1033-17-4-17-27-0000 HS1 SubDivision HS1 LT 14 BLK 4 HIGH SIERRA SUBD 1ST FILING	2		RE	
A26918	✓ LYNDES, JAY C 600 INDIAN TRL BILLINGS MT 59105-2702	03-1033-17-4-17-25-0000 HS1 SubDivision HS1 LT 13 BLK 4 HIGH SIERRA SUBD 1ST FILING	2		RE	
A26910	✓ LYNDES, JAY C 600 INDIAN TRL BILLINGS MT 59105-2702	03-1033-17-4-17-09-0000 HS1 SubDivision HS1 LT 5 BLK 4 HIGH SIERRA SUBD 1ST FILING	2		RE	
A26917	✓ LYNDES, JAY C 600 INDIAN TRL BILLINGS MT 59105-2702	03-1033-17-4-17-23-0000 HS1 SubDivision HS1 LT 12 BLK 4 HIGH SIERRA SUBD 1ST FILING	2		RE	
A26911	✓ LYNDES, JAY C 600 INDIAN TRL BILLINGS MT 59105-2702	03-1033-17-4-17-11-0000 HS1 SubDivision HS1 LT 6 BLK 4 HIGH SIERRA SUBD 1ST FILING	2		RE	
A26931	✓ MDNICAL, GREG E & LEILANI M 990 ADOBE DR BILLINGS MT 59105-5404	03-1033-17-4-19-13-0000 HS1 SubDivision HS1 LT 1 BLK 6 HIGH SIERRA SUBD 1ST FILING	2		RE	
A26894	✓ MOORE, ROBERT D & JENNIFER L 928 SOLITA DR BILLINGS MT 59105-5423	03-1033-17-4-15-25-0000 HS1 SubDivision HS1 LT 13 BLK 3 HIGH SIERRA SUBD 1ST FILING	2		RE	
A26892	✓ ROSIN, MYRON JAY & LORI A 960 SOLITA DR BILLINGS MT 59105-5423	03-1033-17-4-15-21-0000 HS1 SubDivision HS1 LT 11 BLK 3 HIGH SIERRA SUBD 1ST FILING	2		RE	
A21888A	✓ SEEMAN, CURTIS W & PATRICIA A 1736 GLENEGGLES BLVD BILLINGS MT 59105-3556	03-1033-16-3-01-10-7001 LK1 SubDivision LK1 UNIT A GARNET TOWNHOMES (04) 50% INT COMMON ELEMENTS LT 9 BLK 1 LAKE HILLS SUB 1ST FILING & LT 9A BLK 1 LAKE HILLS SUB 3RD FILING	2		RE	
A21888B	✓ SKEWIS, RICHARD J & LINDA B	03-1033-16-3-01-10-7002	2		RE	

Assessor#	Owner/Mailing Address	Legal Description	Levy Sub Tax	Dist Dist Type Key #1
	1738 GLEBEAGLES BLVD BILLINGS MT 59105-3556	LK1 SubDivision LK1 UNIT B GARNET TOWNHOMES (04) 50% INT COMMON ELEMENTS LT 9 BLK 1 LAKE HILLS SUB 1ST FILING & LT 9A BLK 1 LAKE HILLS SUB 3RD FILING		
A26941	✓ SNIZEK, ROBERT F 965 SOLITA DR BILLINGS MT 59105-5429	03-1033-17-4-19-09-0000 HS1 SubDivision HS1 LT 11 BLK 6 HIGH SIERRA SUBD 1ST FILING	2	RE
A27103	✓ SOELTER, DEIDRE A 1780 HIGH SIERRA BLVD BILLINGS MT 59105	03-1033-17-4-13-15-0000 HS1 SubDivision HS1 LT 7 BLK 26 HIGH SIERRA SUBD 1ST FILING	2	RE
A26940	✓ SPECHT, JERRY W & ANN E ✓ 959 SOLITA DR BILLINGS MT 59105-5429	03-1033-17-4-19-07-0000 HS1 SubDivision HS1 LT 10 BLK 6 HIGH SIERRA SUBD 1ST FILING	2	RE

TA Reports - Parcel Master List

*Certified thru
10/19/05 3/2
Dept. of Rev
Paul C*

Ranges: TAX YEAR: (R) 2005 - 2005
 ASSESSOR#: (L) A21991B, A21992A, A21992B,
 A26855, A26856, A26921, A26922,
 A26923, A26924, A26924A, A26929,
 A26930, A26936, A26943, A26944,
 A26945, A26946, A26950, A26951,
 A26952, A26979, A27097, A27098, A27099

TAX TYPE: (A)
 LEVY DISTRICT: (A)
 SUB-LEVY DIST: (A)
 SPECIAL DISTRICT: (A)

OPTIONS: SORT ORDER: N # OF COPIES: 1

Assessor#	Owner/Mailing Address	Legal Description	Levy Dist	Sub Dist	Tax Type	Key #1
A26946	BLISS, DONNA M ✓ 2424 LOCUST ST BILLINGS MT 59101-0554	03-1033-17-4-21-19-0000 HS1 SubDivision HS1 LT 4 BLK 7 HIGH SIERRA SUBD 1ST FILING	2		RE	
A26944	BLISS, DONNA M ✓ 2424 LOCUST ST BILLINGS MT 59101-0554	03-1033-17-4-21-15-0000 HS1 SubDivision HS1 LT 2 BLK 7 HIGH SIERRA SUBD 1ST FILING	2		RE	
A21992A	BOYD, GARY A & HAVLIK, CAROL E ✓ PO BOX 60 LUSK WY 82225-0060	03-1033-16-3-01-14-7001 LK3 SubDivision LK3 UNIT A RUBY TOWNHOMES (04) 1/2 INT COMMON ELEMENTS LOC AT LT 11 BLK 1 LAKE HILLS SUB 3RD	2		RE	
A26936	BRIGGS, STUART E & PAMELA D ✓ 908 ADOBE DR BILLINGS MT 59105-5404	03-1033-17-4-19-23-0000 HS1 SubDivision HS1 LT 6 BLK 6 HIGH SIERRA SUBD 1ST FILING	2		RE	
A26921	BROWN, MICHAEL & JULIE ✓ 897 SOLITA DRIVE BILLINGS MT 59105-2702	03-1033-17-4-23-09-0000 HS1 SubDivision HS1 LT 1 BLK 5 HIGH SIERRA SUBD 1ST FILING	2		RE	
A21992B	CARSTENS, IRENE R ✓ 1822 GLEN EAGLES BLVD BILLINGS MT 59105-3561	03-1033-16-3-01-14-7002 LK3 SubDivision LK3 UNIT B RUBY TOWNHOMES (04) 1/2 INT COMMON ELEMENTS LOC AT LT 13 BLK 1 LAKE HILLS SUB 3RD	2		RE	
A26929	CHAMBERLAIN, ADAM & KAMI ✓ 888 ADOBE DR BILLINGS MT 59105-5400	03-1033-17-4-23-13-0000 HS1 SubDivision HS1 LT 10 BLK 5 HIGH SIERRA SUBD 1ST FILING	2		RE	
A27098	DENNY, TINA MARIE ✓ 1848 HIGH SIERRA BLVD BILLINGS MT 59105	03-1033-17-4-13-25-0000 HS1 SubDivision HS1 LT 2 BLK 26 HIGH SIERRA SUB 1ST	2		RE	
A27099	GUERRERO, JOSE A & RANDI LEE ✓ BILLINGS MT 59105	03-1033-17-4-13-23-0000	2		RE	

Assessor#	Owner/Mailing Address	Legal Description	Levy Dist	Sub Dist	Tax Type	Key #1
	1836 HIGH SIERRA BLVD BILLINGS MT 59105	HS1 SubDivision HS1 LT 3 BLK 26 HIGH SIERRA SUBD 1ST				
A26930	HILL, STEPHANIE ANN ✓ 898 ADOBE DR BILLINGS MT 59105-5400	03-1033-17-4-23-11-0000 HS1 SubDivision HS1 LT 11 BLK 5 HIGH SIERRA SUBD 1ST FILING	2		RE	
A26950	IZATT, RUSSELL E & CATHY L ✓ 925 ADOBE DR BILLINGS MT 59105-5405	03-1033-17-4-21-03-0000 HS1 SubDivision HS1 LT 8 BLK 7 HIGH SIERRA SUBD 1ST FILING	2		RE	
A27097	KELLUM, CURT ✓ 1860 HIGH SIERRA BLVD BILLINGS MT 59105-5411	03-1033-17-4-13-27-0000 HS1 SubDivision HS1 LT 1 BLK 26 HIGH SIERRA SUBD 1ST FILING	2		RE	
A26856	LOZADA, DAVID & KATHLEEN J ✓ 1825 MOROCCO DR BILLINGS MT 59105-5410	03-1033-17-4-11-49-0000 HS1 SubDivision HS1 LT 56 BLK 1 HIGH SIERRA SUBD 1ST FILING	2		RE	
A26922	LYNDES, JAY C ✓ 600 INDIAN TRL BILLINGS MT 59105-2702	03-1033-17-4-23-07-0000 HS1 SubDivision HS1 LT 2 BLK 5 HIGH SIERRA SUBD 1ST FILING	2		RE	
A26924	LYNDES, JAY C ✓ 600 INDIAN TRL BILLINGS MT 59105-2702	03-1033-17-4-23-03-0000 HS1 SubDivision HS1 LT 4 BLK 5 HIGH SIERRA SUBD 1ST FILING	2		RE	
A26923	LYNDES, JAY C ✓ 600 INDIAN TRL BILLINGS MT 59105-2702	03-1033-17-4-23-05-0000 HS1 SubDivision HS1 LT 3 BLK 5 HIGH SIERRA SUBD 1ST FILING	2		RE	
<u>A26924A</u>	LYNDES, JAY C ✓ 600 INDIAN TRL BILLINGS MT 59105-2702	03-1033-17-4-23-01-0000 HS1 SubDivision HS1	2		RE	
A26943	MCGENNIS, DAVE & SANDRA ✓ 1785 FANTAN ST BILLINGS MT 59105-5420	03-1033-17-4-21-13-0000 HS1 SubDivision HS1 LT 1 BLK 7 HIGH SIERRA SUBD 1ST FILING	2		RE	
A26952	MONICAL, GREG & LEILANI ✓ 957 ADOBE DR BILLINGS MT 59105-5405	03-1033-17-4-21-07-0000 HS1 SubDivision HS1 LT 10 BLK 7 HIGH SIERRA SUBD 1ST FILING	2		RE	
A26945	POLETTE, THOMAS L & JULIANN C ✓ 1409 LONGHORN WAY BILLINGS MT 59105-4650	03-1033-17-4-21-17-0000 HS1 SubDivision HS1 LT 3 BLK 7 HIGH SIERRA SUBD 1ST FILING	2		RE	
A26979	POPE, RICHARD R & JEANA ✓ 1825 FANTAN ST BILLINGS MT 59105-5425	03-1033-17-4-25-01-0000 HS1 SubDivision HS1 LT 10 BLK 9 HIGH SIERRA SUBD 1ST FILING	2		RE	
A26855	PREWITT, VAN & SHERI	03-1033-17-4-11-47-0000	2		RE	

Herman, David
889 Solita
Billings MT 59105

Assessor#	Owner/Mailing Address	Legal Description	Levy Sub Tax Dist Dist Type Key #1
	1815 MOROCCO DR BILLINGS MT 59105-5410	HS1 SubDivision HS1 LT 55 BLK 1 HIGH SIERRA SUBD 1ST FILING	
A21921B	TOWNSLEY WILLIAM E & NINA M 1814 GLENEAGLES BLVD BILLINGS MT 59105-3561	03-1033-16-3-01-13-7002 LK3 SubDivision LK3 UNIT B PEARL TOWNHOMES (04) UNDIV 50% INT COMMON ELEMENTS LT 12 BLK 1 LAKE HILLS SUB 3RD FILING	2 RE
A26951	VANDENBERG, DIRK B & JEAN A 941 ADOBE DR BILLINGS MT 59105-5405	03-1033-17-4-21-05-0000 HS1 SubDivision HS1 LT 9 BLK 7 HIGH SIERRA SUBD 1ST FILING	2 RE

Ranges: TAX YEAR: (R) 2005 - 2005
ASSESSOR#: (L) A21991A
TAX TYPE: (A)
LEVY DISTRICT: (A)
SUB-LEVY DIST: (A)
SPECIAL DISTRICT: (A)

OPTIONS: SORT ORDER: N # OF COPIES: 1

Assessor#	Owner/Mailing Address	Legal Description	Levy Dist	Sub Dist	Tax Type	Key #1
A21991A	COOK, KAREN F ✓ 1812 GLEN EAGLES BLVD BILLINGS MT 59105-3561	03-1033-26-3-01-13-7001 LK3 SubDivision LK3 UNIT A PEARL TOWNHOMES (04) UNDIV 50% INT COMMON ELEMENTS LT 12 BLK 1 LAKE HILLS SUB 3RD FILING	2		RE	

Ranges: TAX YEAR: (R) 2005 - 2005
 ASSESSOR#: (L) A21992, A21994, A26857,
 A26858, A26925, A26926, A26927,
 A26928, A26947, A26948, A26949,
 A26955, A26956, A26957, A26958,
 A26968, A26969, A26970, A26976,
 A26977, A26978, A26980, A26981,
 A26982, A27095
 TAX TYPE: (A)
 LEVY DISTRICT: (A)
 SUB-LEVY DIST: (A)
 SPECIAL DISTRICT: (A)

*Certified true
 10/19/05 3/23/06
 Dept. of Rev.
 Paul C.*

OPTIONS: SORT ORDER: N # OF COPIES: 1

Assessor#	Owner/Mailing Address	Legal Description	Levy Dist	Sub Dist	Tax Type	Key #1
A26857	CONRAD, THOMAS L ✓ BUSCHO, CHERYL L & ✓ 1835 MOROCCO DR BILLINGS MT 59105-5410	03-1033-17-4-11-51-0000 HS1 SubDivision HS1 LT 57 BLK 1 HIGH SIERRA SUBD 1ST FILING	2		RE	
A21994 ✓	CARLSON, TODD A & JENNIFER L ✓ 1860 GLORIEAGLES BLVD BILLINGS MT 59105-3561	03-1033-16-3-01-16-0000 L19 SubDivision L19 LT 14 5 14A-BLK 1 LAKE HILLS SUBD 19TH	2		RE	
A26958 ✓	GASSER, SCOTT E & HEIDI A ✓ 871 ADOBE DR BILLINGS MT 59105-5403	03-1033-17-4-27-07-0000 HS1 SubDivision HS1 LT 4 BLK 8 HIGH SIERRA SUBD 1ST FILING	2		RE	
A26957 ✓	HALBERT, MICHAEL & CHERYL A ✓ 879 ADOBE DR BILLINGS MT 59105-5403	03-1033-17-4-27-09-0000 HS1 SubDivision HS1 LT 3 BLK 8 HIGH SIERRA SUBD 1ST FILING	2		RE	
A26926 ✓	KAUTZ, DENNIS W ✓ 864 ADOBE DR BILLINGS MT 59105-5400	03-1033-17-4-23-19-0000 HS1 SubDivision HS1 LT 7 BLK 5 HIGH SIERRA SUBD 1ST FILING	2		RE	
A26858 ✓	KOSTELECKY, BRIAN & ELAINE ✓ 1855 MOROCCO DR BILLINGS MT 59105-5410	03-1033-17-4-11-53-0000 HS1 SubDivision HS1 LT 58 BLK 1 HIGH SIERRA SUBD 1ST FILING	2		RE	
A26948 ✓	LYNDES, JAY C ✓ 600 INDIAN TRL BILLINGS MT 59105-2702	03-1033-17-4-21-23-0000 HS1 SubDivision HS1 LT 6 BLK 7 HIGH SIERRA SUBD 1ST FILING	2		RE	
A26968 ✓	LYNDES, JAY C ✓ 600 INDIAN TRL BILLINGS MT 59105-2702	03-1033-17-4-27-17-0000 HS1 SubDivision HS1 LT 14 BLK 8 HIGH SIERRA SUBD 1ST FILING	2		RE	
A26969 ✓	LYNDES, JAY C ✓ 600 INDIAN TRL BILLINGS MT 59105-2702	03-1033-17-4-27-15-0000 HS1 SubDivision HS1 LT 15 BLK 8 HIGH SIERRA SUBD 1ST FILING	2		RE	

Assessor#	Owner/Mailing Address	Legal Description	Levy Dist	Sub Dist	Tax Type	Key #1
A26970 ✓	LYNDES, JAY C ✓ 600 INDIAN TRL BILLINGS MT 59105-2702	03-1033-17-4-25-19-0000 HS1 SubDivision HS1 LT 1 BLK 9 HIGH SIERRA SUBD 1ST FILING	2		RE	
A26980 ✓	LYNDES, JAY C ✓ 600 INDIAN TRL BILLINGS MT 59105-2702	03-1033-17-4-25-25-0000 HS1 SubDivision HS1 LT 11 BLK 9 HIGH SIERRA SUBD 1ST FILING	2		RE	
A26981 ✓	LYNDES, JAY C ✓ 600 INDIAN TRL BILLINGS MT 59105-2702	03-1033-17-4-25-23-0000 HS1 SubDivision HS1 LT 12 BLK 9 HIGH SIERRA SUBD 1ST FILING	2		RE	
A26982 ✓	LYNDES, JAY C ✓ 600 INDIAN TRL BILLINGS MT 59105-2702	03-1033-17-4-25-21-0000 HS1 SubDivision HS1 LT 13 BLK 9 HIGH SIERRA SUBD 1ST FILING	2		RE	
A26928 ✓	MILLER, SHALE N & KERRI L ✓ 880 ADOBE DR BILLINGS MT 59105-5400	03-1033-17-4-23-15-0000 HS1 SubDivision HS1 LT 9 BLK 5 HIGH SIERRA SUBD 1ST FILING	2		RE	
A26947 ✓	POLETTE, THOMAS L & JULIANN C ✓ 1409 LONGHORN WAY BILLINGS MT 59105-4650	03-1033-17-4-21-21-0000 HS1 SubDivision HS1 LT 5 BLK 7 HIGH SIERRA SUBD 1ST FILING	2		RE	
A26925 ✓	SCHMIEDING, KENNETH J & JULIE R ✓ 856 ADOBE DR BILLINGS MT 59105-5400	03-1033-17-4-23-21-0000 HS1 SubDivision HS1 LT 6 BLK 5 HIGH SIERRA SUBD 1ST FILING	2		RE	
A26978 ✓	STOCKTON, LARRY D & ARDIS K ✓ 1849 FANTAN ST BILLINGS MT 59105-5425	03-1033-17-4-25-03-0000 HS1 SubDivision HS1 LT 9 BLK 9 HIGH SIERRA SUBD 1ST FILING	2		RE	
A26955 ✓	COWAN, ANNA M ✓ VANDERHORST, ELIZABETH R & 897 ADOBE DR BILLINGS MT 59105-5403	03-1033-17-4-27-13-0000 HS1 SubDivision HS1 LT 1 BLK 8 HIGH SIERRA SUBD 1ST FILING	2		RE	
A26949 ✓	VERPLOEGEN, JAMES P ✓ 909 ADOBE DR BILLINGS MT 59105-5405	03-1033-17-4-21-01-0000 HS1 SubDivision HS1 LT 7 BLK 7 HIGH SIERRA SUBD 1ST FILING	2		RE	
A26927 ✓	WALK, GREGORY E & KRISTY J ✓ 872 ADOBE DR BILLINGS MT 59105-5400	03-1033-17-4-23-17-0000 HS1 SubDivision HS1 LT 8 BLK 5 HIGH SIERRA SUBD 1ST FILING	2		RE	
A26977 ✓	WARDELL, MARILYN BRIGGS TRUSTEES ✓ WARDELL, LESLIE JONES & ✓ 1859 FANTAN ST BILLINGS MT 59105-5425	03-1033-17-4-25-05-0000 HS1 SubDivision HS1 LT 8 BLK 9 HIGH SIERRA SUBD 1ST FILING	2		RE	
A27095 ✓	WATSON, LARRY ✓	03-1033-17-3-30-01-0000	2		RE	

Assessor#	Owner/Mailing Address	Legal Description	Levy Sub Tax Dist Dist Type Key #1
	PO BOX 35500-327 BILLINGS MT 59107	HS1 SubDivision HS1 LT 14 BLK 25 HIGH SIERRA SUB 1ST	
A26976 ✓	WILLIAMS, LORRAINE E ✓ 1869 FANTAN ST BILLINGS MT 59105-5425	03-1033-17-4-25-07-0000 HS1 SubDivision HS1 LT 7 BLK 9 HIGH SIERRA SUBD 1ST FILING	2 RE
A26956 ✓	WILSON, TODD R & LAURIE M ✓ 885 ADOBE DR ✓ BILLINGS MT 59105-5403	03-1033-17-4-27-11-0000 HS1 SubDivision HS1 LT 2 BLK 8 HIGH SIERRA 1ST	2 RE

Ranges: TAX YEAR: (R) 2005 - 2005
ASSESSOR#: (L) A21992A, A21992B
TAX TYPE: (A)
LEVY DISTRICT: (A)
SUB-LEVY DIST: (A)
SPECIAL DISTRICT: (A)

OPTIONS: SORT ORDER: N # OF COPIES: 1

Assessor#	Owner/Mailing Address	Legal Description	Levy Dist	Sub Dist	Tax Type	Key #1
A21992A	BOYD, GARY A & HAVLIK, CAROL E PO BOX 90 LUSK WY 82225-0060	03-1033-16-3-01-14-7001 LK3 Subdivision LK3 UNIT A RUEY TOWNHOMES (04) 1/2 INT COMMON ELEMENTS LOC AT LT 13 BLK 1 LAKE HILLS SUB 3RD	2		RE	
A21992B	CARSTENS, IRENE R 1822 GLENEAGLES BLVD BILLINGS MT 59105-3561 <i>(Duplicate)</i>	03-1033-16-3-01-14-7002 LK3 Subdivision LK3 UNIT B RUEY TOWNHOMES (04) 1/2 INT COMMON ELEMENTS LOC AT LT 13 BLK 1 LAKE HILLS SUB 3RD	2		RE	

EXHIBIT "D"

ESTIMATE OF PROBABLE COST
 EXTENDED SPECIAL IMPROVEMENTS MAINTENANCE DISTRICT NO. 4005
 HIGH SIERRA SUBDIVISION, FIRST FILING MAINTENANCE DISTRICT
 EXPANSION TO INCLUDE HIGH SIERRA SUBDIVISION, THIRD - FOURTH FILINGS

- The City of Billings Department of Parks, Recreation, and Public Lands estimates the maintenance of the improvements for the first year to be **\$33,793** with the addition of the High Sierra Subdivision 3rd and 4th Filings.

The assessment for the first years is as follows:

CITY OF BILLINGS - PARK MAINTENANCE DISTRICT 4005 ESTIMATE OF ANNUAL MAINTENANCE COSTS					
PMD Number: <u>4005</u>		PMD 4005 Description: <u>HIGH SIERRA SUBDIVISION, 1ST, 3RD - 4TH FILINGS - TOTAL</u>			
Date: <u>May 3, 2005</u>					
BA SUB	SUB ELE	SUB OBJ	ACCOUNT DESCRIPTION	TOTAL 4005 MAINTENANCE CDSTS	EST. 3RD-4TH FILINGS PROP. SHARE COSTS
			Creation documents, reports, and exhibits:		\$1,950.00
			Operations and Supplies:		
	34	10	Electricity	\$ 1,850.00	\$296.00
		20	Water Service	\$ 21,110.00	\$3,377.60
		50	Ground Maintenance	\$ 2,100.00	\$336.00
	39	65	Other Service/Finance Charges	\$ 1,243.00	\$198.88
		66	Parks Charge for Services	\$ 4,510.00	\$721.60
		90	Other Contract Services	\$ 100.00	\$16.00
	54	10	Special Assessments	\$ 930.00	\$148.80
			Total Operations and Supplies, Etc.	\$ 33,793.00	\$5,406.88
			Total 3rd - 4th Filings Proportionate Share of High Sierra Subdivision, 1st Filing PMD 4005		\$7,356.88
			Total Park and landscape area to be maintained (Square Feet)	403,000	
			Total Assessment Area of expanded District (Square Feet)	7,413,864	
			Area of 3rd - 4th Filings Expansion Added to PMD	1,215,859	
			Assessment (Per Square Foot)	\$ 0.0054522	