

RESOLUTION 05 - 18269

A RESOLUTION CREATING SPECIAL
IMPROVEMENT MAINTENANCE DISTRICT No. 4026 IN UINTA PARK
SUBDIVISION, FOR THE PURPOSE OF MAINTENANCE OF PARK
IMPROVEMENTS

WHEREAS, the City Council of Billings, Montana, hereby finds, determines and declares that:

1. The public interest and convenience require the creation of the above named district.
2. That said district is of more than local or ordinary public benefit.
3. All lands are benefited and no lands that are not benefited have been included within the district. All lands within the district will be enhanced in value to the extent of the assessments to be levied upon such lands, and all lands included within the district should be assessed accordingly to pay the costs and expenses of the district.

NOW, THEREFORE, BE IT RESOLVED BY THE CITY COUNCIL OF THE CITY OF BILLINGS:

1. *Jurisdiction and Creation.* Special Improvement Maintenance District Number 4026 is of more than local or ordinary public benefit. The Council has acquired jurisdiction to order the proposed improvement, and it does hereby create Special Improvement Maintenance District Number 4026. All lands included within Special Improvement Maintenance District Number 4026 are benefited and no lands that are not benefited have been included in said district.
2. *General Character of Improvement and Maintenance.* The general character of the improvements are a wetland area which will also serve as a storm detention facility, Bike Net trail system, nature and exercise trail, sand play area, and open space grass area located in the Public Park of Uinta Park Subdivision as shown on Exhibit "A" attached hereto. The placement of a water detention berm outside of the storm detention facility will be installed under P- 498. The purpose of said district is to provide perpetual maintenance of the storm detention facility and for the long term care of the park improvements.
3. *Boundaries.* The Boundaries of the district are described and designated on Exhibit "B" attached hereto.
4. *Ownership.* The ownership records of all properties within the said district are described and designated in Exhibit "C" attached hereto.
5. *Maintenance Estimate:* The estimated cost of the proposed maintenance for the first year will be \$11,518.00 as described in the Maintenance Estimate attached hereto in Exhibit "D".
6. *Assessment Method:* All of the costs and expenses of the district will be assessed against the entire district, and each lot or parcel of land within the district will be assessed equally. Assessments for each lot during the first year will be approximately \$68.16/Lot. In accordance with 7-1-1479 MCA, the assessment for each lot in each ensuing year will be set by the City Council by resolution.
7. *Payment of Assessment.* The assessments for all maintenance and costs of the district shall be paid in equal annual installments, provided that payment of one-half of said annual assessment may be deferred to May 31 of the year following the assessment. All money derived from the collection of said assessments otherwise shall constitute a fund to be known as Fund of Special Improvement Maintenance District Number 4026.

8. *Bonds for Improvement.* There will be no bonds sold for this district as it is for maintenance only.
9. *Engineering.* The park improvements shall be installed under Private Contract P-498. All design and engineering has been completed under P- 498.
10. *District Accounts.* The Director of Finance is hereby authorized and directed to establish the necessary accounts to govern the receiving of all revenues and the expenditures of the same district.

APPROVED by the City Council of the City of Billings, Montana, this 23rd day of May, 2005.

CITY OF BILLINGS

By: 

Charles F. Tooley Mayor

Mayor Pro Tem
in the absence
of the Mayor

ATTEST:

By: 
Marita Herold, CMC/AAE City Clerk



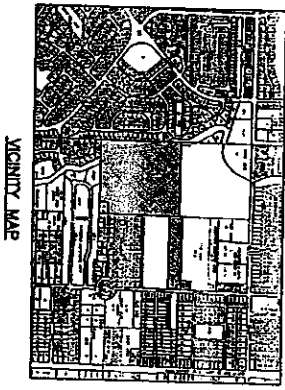
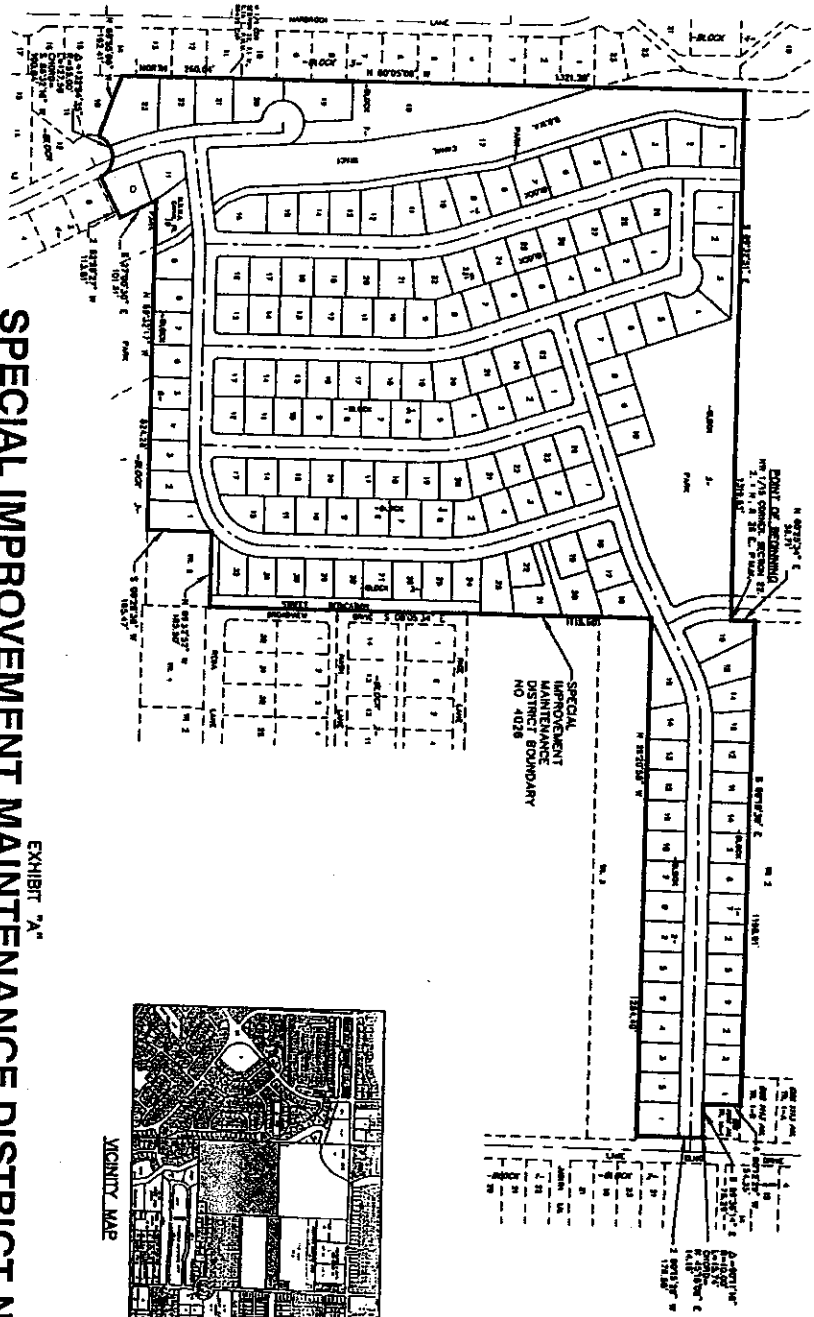

EXHIBIT "A"
SPECIAL IMPROVEMENT MAINTENANCE DISTRICT NO. 4026
JUNTA PARK SUBDIVISION
 BEING TRACT 1, CERTIFICATE OF SURVEY 1972, TRACT 2A-1, CERTIFICATE OF SURVEY 2866 AMENDED,
 AND LOTS 7, 8 & 9, BLOCK 4, HOWARD HEIGHTS SUBDIVISION
 SITUATED IN THE NW1/4 AND SW1/4 OF SECTION 22, T. 1 N., R. 26 E., P.M.M.,
 YELLOWSTONE COUNTY, MONTANA

PREPARED BY : ENGINEERING, INC.
 SCALE : 1" = 300'

MARCH, 2004
 BILLINGS, MONTANA



EXHIBIT "B"

BOUNDARY DESCRIPTION SPECIAL IMPROVEMENT MAINTENANCE DISTRICT No. 4026 P - 498, UINTA PARK SUBDIVISION PARK MAINTENANCE DISTRICT

Meets and Bounds Description:

Beginning at a point which is the northwest 1/16 corner of Section 22, T.1 N., R. 26 E., P.M.M.; thence, from said point of beginning, N 00°25'34" E a distance of 59.71 feet; thence S 89°18'30" E a distance of 1198.91 feet; thence S 00°12'29" W a distance of 94.35 feet; thence S 89°36'14" E a distance of 76.29 feet; thence along a curve to the left with a radius of 10.00 feet and a distance of 15.74 feet (cord bearing N 45°18'08" E, cord length 14.16 feet); thence S 00°12'29" W a distance of 176.58 feet; thence N 89°20'58" W a distance of 1284.40 feet; thence S 00°05'34" E a distance of 1119.60 feet; thence N 89°32'52" W a distance of 185.50 feet; thence S 00°28'38" W a distance of 165.47 feet; thence N 89°32'17" W a distance of 824.28 feet; thence S 27°00'30" E a distance of 101.31 feet; thence S 62°59'27" W a distance of 113.81 feet; thence along a curve to the left with a radius of 55.00 feet and a distance of 127.58 feet (cord bearing S 86°32'16" W, cord length 100.84 feet); thence N 69°55'00" W a distance of 162.41 feet; thence NORTH a distance of 260.04 feet to the W ¼ corner of said Section 22; thence N 00°05'00" W a distance of 1321.28 feet; thence S 89°32'51" E a distance of 1319.53 feet to the point of beginning.

EXHIBIT "C"

**OWNERSHIP RECORDS
SPECIAL IMPROVEMENT MAINTENANCE DISTRICT No. 4026
P- 498, UINTA PARK SUBDIVISION
PARK MAINTENANCE DISTRICT**

Date: February 2, 2005

Customer Name: Engineering, Inc.
Attn: Kjersten Olsen
Address: 1300 North Transteck Way
Billings, MT 59102

RE: OWNERSHIP REPORT
Our File #: 3-90433

At your request, we have search our tract indices derived from the records of Yellowstone County Montana, to determine the record owners and contract purchasers if any, of the hereinafter described real property; as of January, 24, 2005 at 7:30 a m , we report as follows on the attached parcels 1-172.

This is not a title report and no examination of the title to the premises herein described has been made. For this reason, no liability is assumed hereunder, and the Company will not be responsible for errors or omissions contained herein

Sincerely,
AMERICAN TITLE & ESCROW
BY:

COPY

Tammy Wallery
Title Officer

Enclosure/tw

OWNERSHIP REPORT

RECORD OWNER APPEARS TO BE: Jan A. Sorensen

TAX CODE: A30798

MAILING ADDRESS: 381 Uinta Park Dr
Billings, MT 59105

DESCRIPTION:

Lot 1, Block 1, of Uinta Park Subdivision, in the City of Billings, Yellowstone County, Montana, according to the official plat on file in the office of the Clerk and Recorder of said County, under Document #3234621.

OWNERSHIP REPORT

RECORD OWNER APPEARS TO BE: John W. Fraker and Debia J. Fraker

TAX CODE: A30799

MAILING ADDRESS: 373 Uinta Park Drive
Billings, MT 59105

DESCRIPTION:

Lot 2, Block 1, of Uinta Park Subdivision, in the City of Billings, Yellowstone County, Montana, according to the official plat on file in the office of the Clerk and Recorder of said County, under Document #3234621.

OWNERSHIP REPORT

RECORD OWNER APPEARS TO BE: Joanne R. Byars

TAX CODE: A30803

MAILING ADDRESS: 315 Uinta Park Dr
Billings, MT 59105

DESCRIPTION:

Lot 6, Block 1, of Uinta Park Subdivision, in the City of Billings, Yellowstone County, Montana, according to the official plat on file in the office of the Clerk and Recorder of said County, under Document #3234621

OWNERSHIP REPORT

RECORD OWNER APPEARS TO BE: Nicholas W. Baker and Jessica L. Baker

TAX CODE: A30806

MAILING ADDRESS: 289 Uinta Park Dr
Billings, MT 59105

DESCRIPTION:

Lot 9, Block 1, of Uinta Park Subdivision, in the City of Billings, Yellowstone County, Montana, according to the official plat on file in the office of the Clerk and Recorder of said County, under Document #3234621

OWNERSHIP REPORT

RECORD OWNER APPEARS TO BE: Scott Hicks

TAX CODE: A30809
A30811
A30858

MAILING ADDRESS: 1250 15th St West
Billings, MT 59102

253 Uinta Park Dr
Billings, MT 59105

229 Uinta Park Dr
Billings, MT 59105

3020 S 67th St W
Billings, MT 59106

1328 Mirror Lake Ln
Billings, MT 59105

DESCRIPTION:

Parcel A:

Lots 12 and 14, Block 1, of Uinta Park Subdivision, in the City of Billings, Yellowstone County, Montana, according to the official plat on file in the office of the Clerk and Recorder of said County, under Document #3234621.

Parcel B:

Lot 2, Block 4, of Uinta Park Subdivision, in the City of Billings, Yellowstone County, Montana, according to the official plat on file in the office of the Clerk and Recorder of said County, under Document #3234621.

OWNERSHIP REPORT

RECORD OWNER APPEARS TO BE: Jason Hageman and Genia A Hageman

TAX CODE: A30812

MAILING ADDRESS: 217 Uinta Park Dr
Billings, MT 59105

DESCRIPTION:

Lot 15, Block 1, of Uinta Park Subdivision, in the City of Billings, Yellowstone County, Montana, according to the official plat on file in the office of the Clerk and Recorder of said County, under Document #3234621

OWNERSHIP REPORT

RECORD OWNER APPEARS TO BE: Allan Mader and Lori Mader

TAX CODE: A30813

MAILING ADDRESS: 3420 Granger Ave S Apt 19
Billings, MT 59102

207 Uinta Park Dr
Billings, MT 59105

DESCRIPTION:

Lot 16, Block 1, of Uinta Park Subdivision, in the City of Billings, Yellowstone County, Montana, according to the official plat on file in the office of the Clerk and Recorder of said County, under Document #3234621.

OWNERSHIP REPORT

RECORD OWNER APPEARS TO BE: Dena Edmunds and Uriah Edmunds

TAX CODE: A30814

MAILING ADDRESS: 394 Uinta Park Dr
Billings, MT 59105

DESCRIPTION:

Lot 1, Block 2, of Uinta Park Subdivision, in the City of Billings, Yellowstone County, Montana, according to the official plat on file in the office of the Clerk and Recorder of said County, under Document #3234621.

OWNERSHIP REPORT

RECORD OWNER APPEARS TO BE: Randy L. Werdal and Rita R. Werdal

TAX CODE: A30816

MAILING ADDRESS: 378 Uinta Park Dr
Billings, MT 59105

DESCRIPTION:

Lot 3, Block 2, of Uinta Park Subdivision, in the City of Billings, Yellowstone County, Montana, according to the official plat on file in the office of the Clerk and Recorder of said County, under Document #3234621.

OWNERSHIP REPORT

RECORD OWNER APPEARS TO BE: Kim Bailey

TAX CODE: A30817

MAILING ADDRESS: 362 Uinta Park Dr
Billings, MT 59105

DESCRIPTION:

Lot 4, Block 2, of Uinta Park Subdivision, in the City of Billings, Yellowstone County, Montana, according to the official plat on file in the office of the Clerk and Recorder of said County, under Document #3234621.

OWNERSHIP REPORT

RECORD OWNER APPEARS TO BE: Deirdre Wilson

TAX CODE: A30818

MAILING ADDRESS: 350 Uinta Park Dr
Billings, MT 59105

DESCRIPTION:

Lot 5, Block 2, of Uinta Park Subdivision, in the City of Billings, Yellowstone County, Montana, according to the official plat on file in the office of the Clerk and Recorder of said County, under Document #3234621.

OWNERSHIP REPORT

RECORD OWNER APPEARS TO BE: Patrick Gravage and Sheila Gravage

TAX CODE: A30819

MAILING ADDRESS: 332 Uinta Park Dr
Billings, MT 59105

DESCRIPTION:

Lot 6, Block 2, of Uinta Park Subdivision, in the City of Billings, Yellowstone County, Montana, according to the official plat on file in the office of the Clerk and Recorder of said County, under Document #3234621.

OWNERSHIP REPORT

RECORD OWNER APPEARS TO BE: Lora J. Pederson

TAX CODE: A30821

MAILING ADDRESS: 1656 Lakes Hills Dr
Billings, MT 59105

308 Uinta Park D1
Billings, MT 59105

DESCRIPTION:

Lot 8, Block 2, of Uinta Park Subdivision, in the City of Billings, Yellowstone County, Montana, according to the official plat on file in the office of the Clerk and Recorder of said County, under Document #3234621.

OWNERSHIP REPORT

RECORD OWNER APPEARS TO BE: Susan K Hiller

TAX CODE: A30822

MAILING ADDRESS: 294 Uinta Park Dr
Billings, MT 59105

DESCRIPTION:

Lot 9, Block 2, of Uinta Park Subdivision, in the City of Billings, Yellowstone County, Montana, according to the official plat on file in the office of the Clerk and Recorder of said County, under Document #3234621.

OWNERSHIP REPORT

RECORD OWNER APPEARS TO BE: Jason S Ritchie and Mary E Ritchie

TAX CODE: A30823

MAILING ADDRESS: 282 Uinta Park Dr
Billings, MT 59105

DESCRIPTION:

Lot 10, Block 2, of Uinta Park Subdivision, in the City of Billings, Yellowstone County, Montana, according to the official plat on file in the office of the Clerk and Recorder of said County, under Document #3234621.

OWNERSHIP REPORT

RECORD OWNER APPEARS TO BE: Donald D. Hochhalter and Glenda L. Hochhalter

TAX CODE: A30824

MAILING ADDRESS: 276 Uinta Park Dr
Billings, MT 59105

DESCRIPTION:

Lot 11, Block 2, of Uinta Park Subdivision, in the City of Billings, Yellowstone County, Montana, according to the official plat on file in the office of the Clerk and Recorder of said County, under Document #3234621.

OWNERSHIP REPORT

RECORD OWNER APPEARS TO BE: Scott J. Pederson and Paula J. Pederson

TAX CODE: A30825

MAILING ADDRESS: 268 Uinta Park Dr
Billings, MT 59105

DESCRIPTION:

Lot 12, Block 2, of Uinta Park Subdivision, in the City of Billings, Yellowstone County, Montana, according to the official plat on file in the office of the Clerk and Recorder of said County, under Document #3234621.

OWNERSHIP REPORT

RECORD OWNER APPEARS TO BE: Connie M Raynock and Paul T Raynock, Jr.

TAX CODE: A30827

MAILING ADDRESS: 3739 Cambridge Dr
Billings, MT 59101

234 Uinta Park Dr
Billings, MT 59105

DESCRIPTION:

Lot 14, Block 2, of Uinta Park Subdivision, in the City of Billings, Yellowstone County, Montana, according to the official plat on file in the office of the Clerk and Recorder of said County, under Document #3234621.

OWNERSHIP REPORT

RECORD OWNER APPEARS TO BE: Dee Erickson

TAX CODE: A30829

MAILING ADDRESS: 188 Uinta Park Dr
Billings, MT 59105

DESCRIPTION:

Lot 16, Block 2, of Uinta Park Subdivision, in the City of Billings, Yellowstone County, Montana, according to the official plat on file in the office of the Clerk and Recorder of said County, under Document #3234621.

OWNERSHIP REPORT

RECORD OWNER APPEARS TO BE: Brandon Fluery and Nicole Fluery

TAX CODE: A30831

MAILING ADDRESS: 750 Mottingham Cir Apt 6
Billings, MT 59105

1331 Mirror Lake Ln
Billings, MT 59105

DESCRIPTION:

Lot 18, Block 2, of Uinta Park Subdivision, in the City of Billings, Yellowstone County, Montana, according to the official plat on file in the office of the Clerk and Recorder of said County, under Document #3234621.

OWNERSHIP REPORT

RECORD OWNER APPEARS TO BE: Art Schanz and Rachel Schanz

TAX CODE: A30832

MAILING ADDRESS: 4193 Ryan Ave
Billings, MT 59101

1325 Mirror Lake Ln
Billings, MT 59105

DESCRIPTION:

Lot 19, Block 2, of Uinta Park Subdivision, in the City of Billings, Yellowstone County, Montana, according to the official plat on file in the office of the Clerk and Recorder of said County, under Document #3234621.

OWNERSHIP REPORT

RECORD OWNER APPEARS TO BE: Kevin A Barlow and Amy Barlow

TAX CODE: A30835

MAILING ADDRESS: 1315 Mirror Lake Ln
Billings, MT 59105

DESCRIPTION:

Lot 22, Block 2, of Uinta Park Subdivision, in the City of Billings, Yellowstone County, Montana, according to the official plat on file in the office of the Clerk and Recorder of said County, under Document #3234621

OWNERSHIP REPORT

RECORD OWNER APPEARS TO BE: Paul M Tocco and Denise R. Tocco

TAX CODE: A30836

MAILING ADDRESS: 1309 Mirror Lake Ln
Billings, MT 59105

DESCRIPTION:

Lot 23, Block 2, of Uinta Park Subdivision, in the City of Billings, Yellowstone County, Montana, according to the official plat on file in the office of the Clerk and Recorder of said County, under Document #3234621.

OWNERSHIP REPORT

RECORD OWNER APPEARS TO BE: Robert D'Elseaux

TAX CODE: A30837

MAILING ADDRESS: 343 Waterton Way
Billings, MT 59102

1293 Mirror Lake Ln
Billings, MT 59105

DESCRIPTION:

Lot 24, Block 2, of Uinta Park Subdivision, in the City of Billings, Yellowstone County, Montana, according to the official plat on file in the office of the Clerk and Recorder of said County, under Document #3234621

OWNERSHIP REPORT

RECORD OWNER APPEARS TO BE: Michael A. Carter and Lisa Carter

TAX CODE: A30838

MAILING ADDRESS: 1281 Mirror Lake Ln
Billings, MT 59105

1281 Mirror Lake Ln
Billings, MT 59106

DESCRIPTION:

Lot 25, Block 2, of Uinta Park Subdivision, in the City of Billings, Yellowstone County, Montana, according to the official plat on file in the office of the Clerk and Recorder of said County, under Document #3234621.

OWNERSHIP REPORT

RECORD OWNER APPEARS TO BE: Michael D Hakala and Angela L. Hakala

TAX CODE: A30839

MAILING ADDRESS: 1277 Mirror Lake Ln
Billings, MT 59105

DESCRIPTION:

Lot 26, Block 2, of Uinta Park Subdivision, in the City of Billings, Yellowstone County, Montana, according to the official plat on file in the office of the Clerk and Recorder of said County, under Document #3234621.

OWNERSHIP REPORT

RECORD OWNER APPEARS TO BE: Shelley Ostermiller and Roger Ostermiller

TAX CODE: A30840

MAILING ADDRESS: 1155 Bitterroot Dr
Billings, MT 59105

1265 Mirror Lake Ln
Billings, MT 59105

DESCRIPTION:

Lot 27, Block 2, of Uinta Park Subdivision, in the City of Billings, Yellowstone County, Montana, according to the official plat on file in the office of the Clerk and Recorder of said County, under Document #3234621.

OWNERSHIP REPORT

RECORD OWNER APPEARS TO BE: Kenneth E. Shaw

TAX CODE: A30857

MAILING ADDRESS: 1336 Mirror Lake Ln
Billings, MT 59105

DESCRIPTION:

Lot 1, Block 4, of Uinta Park Subdivision, in the City of Billings, Yellowstone County, Montana, according to the official plat on file in the office of the Clerk and Recorder of said County, under Document #3234621

OWNERSHIP REPORT

RECORD OWNER APPEARS TO BE: Roger J Hermanson

TAX CODE: A30859

MAILING ADDRESS: 1320 Mirror Lake Ln
Billings, MT 59105

DESCRIPTION:

Lot 3, Block 4, of Uinta Park Subdivision, in the City of Billings, Yellowstone County, Montana, according to the official plat on file in the office of the Clerk and Recorder of said County, under Document #3234621.

OWNERSHIP REPORT

RECORD OWNER APPEARS TO BE: D. Joshua Wynia and Kimberly F Wynia

TAX CODE: A30862

MAILING ADDRESS: 1284 Mirror Lake Ln
Billings, MT 59105

DESCRIPTION:

Lot 6, Block 4, of Uinta Park Subdivision, in the City of Billings, Yellowstone County, Montana, according to the official plat on file in the office of the Clerk and Recorder of said County, under Document #3234621.

OWNERSHIP REPORT

RECORD OWNER APPEARS TO BE: Charles F. Fyfe and Michelle L. Fyfe

TAX CODE: A30863

MAILING ADDRESS: 1276 Minor Lake Ln
Billings, MT 59105

DESCRIPTION:

Lot 7, Block 4, of Uinta Park Subdivision, in the City of Billings, Yellowstone County, Montana, according to the official plat on file in the office of the Clerk and Recorder of said County, under Document #3234621.

OWNERSHIP REPORT

RECORD OWNER APPEARS TO BE: Matthew N. Rock and Candace L. Rock

TAX CODE: A30864

MAILING ADDRESS: 1262 Mirror Lake Ln
Billings, MT 59105

DESCRIPTION:

Lot 8, Block 4, of Uinta Park Subdivision, in the City of Billings, Yellowstone County, Montana, according to the official plat on file in the office of the Clerk and Recorder of said County, under Document #3234621

OWNERSHIP REPORT

RECORD OWNER APPEARS TO BE: Billings Bench Water Association

TAX CODE: A30949
A31242

MAILING ADDRESS: 1111 Main St
Billings, MT 59105

DESCRIPTION:

Block 7: Lot 17

Block 8: Lot 10

of Uinta Park Subdivision, in the City of Billings, Yellowstone County, Montana, according to the official plat on file in the office of the Clerk and Recorder of said County, under Document #3234621.

OWNERSHIP REPORT

RECORD OWNER APPEARS TO BE: City of Billings

TAX CODE: A30846
A31245
A31246

MAILING ADDRESS: Parks Department
P.O. Box 1178
Billings, MT 59103

DESCRIPTION:

Block 3: Park

Block 7: Park

Block 8: Park

of Uinta Park Subdivision, in the City of Billings, Yellowstone County, Montana, according to the official plat on file in the office of the Clerk and Recorder of said County, under Document #3234621.

OWNERSHIP REPORT

RECORD OWNER APPEARS TO BE: C Jay Larson, Natalie K Larson and Carol Larson

TAX CODE: A30955
A31243
A31244

MAILING ADDRESS: 1101 Ropcke Dr
Murray, UT 84123

1859 W 4655 S
Salt Lake City, UT 84119

1178 Calendula Cir
Billings, MT 59105

1159 Calendula Cir
Billings, MT 59105

DESCRIPTION:

Block 7: Lot 23
Block 8: Lots 11 and 12
of Uinta Park Subdivision, in the City of Billings, Yellowstone County, Montana, according to the official plat on file in the office of the Clerk and Recorder of said County, under Document #3234621.

OWNERSHIP REPORT

RECORD OWNER APPEARS TO BE: Bob Pentecost Construction, Inc

TAX CODE: A30808
A30810
A30860
A30861

MAILING ADDRESS: Box 22212
Billings, MT 59104

265 Uinta Park Dr
Billings, MT 59015

241 Uinta Park Dr
Billings, MT 59105

1314 Mirror Lake Ln
Billings, MT 59105

1296 Mirror Lake Ln
Billings, MT 59105

DESCRIPTION:

Block 1: Lots 11 and 13

Block 4: Lots 4 and 5

of Uinta Park Subdivision, in the City of Billings, Yellowstone County, Montana, according to the official plat on file in the office of the Clerk and Recorder of said County, under Document #3234621

OWNERSHIP REPORT

RECORD OWNER APPEARS TO BE: Oakland Home Builders Corp

TAX CODE: A30800, A30801, A30802, A30804, A30805, A30807, A30815, A30820, A30826, A30828, A30830, A30841, A30842, A30843, A30865, A30866, A30867

MAILING ADDRESS:

175 N 27th St Ste 940
Billings, MT 59101

345 Uinta Park Dr
Billings, MT 59105

327 Uinta Park Dr
Billings, MT 59105

357 Uinta Park Dr
Billings, MT 59105

295 Uinta Park Dr
Billings, MT 59105

277 Uinta Park Dr
Billings, MT 59105

303 Uinta Park Dr
Billings, MT 59105

320 Uinta Park Dr
Billings, MT 59105

250 Uinta Park Dr
Billings, MT 59105

386 Uinta Park Dr
Billings, MT 59105

170 Uinta Park Dr
Billings, MT 59105

1253 Mirror Lake Ln
Billings, MT 59105

212 Uinta Park Dr
Billings, MT 59105

1227 Mirror Lake Ln
Billings, MT 59105

1250 Mirror Lake Ln
Billings, MT 59105

1241 Mirror Lake Ln
Billings, MT 59105

1238 Mirror Lake Ln
Billings, MT 59105

1222 Mirror Lake Ln
Billings, MT 59105

DESCRIPTION:

Block 1: Lots 3, 4, 5, 7, 8 and 10

Block 2: Lots 2, 7, 13, 15, 17, 28, 29 and 30

Block 4: Lots 9, 10 and 11

of Uinta Park Subdivision, in the City of Billings, Yellowstone County, Montana, according to the official plat on file in the office of the Clerk and Recorder of said County, under Document #3234621.

OWNERSHIP REPORT

RECORD OWNER APPEARS TO BE: Clyde H Larsen & Sons Construction

TAX CODE: A30833, A30834, A30844, A30845, A30847, A30848, A30849, A30850, A30851, A30852, A30853, A30854, A30855, A30856, A30868, A30869, A30870, A30871, A30872, A30873, A30874, A30875, A30876, A30877, A30878, A30879, A30880, A30881, A30882, A30883, A30884, A30885, A30886, A30887, A30888, A30889, A30890, A30891, A30892, A30893, A30894, A30895, A30896, A30897, A30898, A30899, A30900, A30901, A30902, A30903, A30904, A30905, A30906, A30907, A30908, A30909, A30910, A30911, A30912, A30913, A30914, A30915, A30916, A30917, A30918, A30919, A30920, A30921, A30922, A30923, A30924, A30925, A30926, A30927, A30928, A30929, A30930, A30931, A30932, A30933, A30934, A30935, A30936, A30937, A30938, A30939, A30940, A30941, A30942, A30943, A30944, A30945, A30946, A30947, A30948, A30950, A30951, A30952, A30953, A30954, A30956, A30957, A30958, A30959, A30960, A30961, A31239, A31240, and A31241

MAILING ADDRESS:

1101 Ropeke Dr Murray, UT 84123	1321 Mirror Lake Ln Billings, MT 59105	1317 Mirror Lake Ln Billings, MT 59105
1213 Minor Lake Ln Billings, MT 59105	1205 Mirror Lake Ln Billings, MT 59105	1383 Twin Lakes Dr Billings, MT 59105
1375 Twin Lakes Dr Billings, MT 59105	1367 Twin Lakes Dr Billings, MT 59105	1355 Twin Lakes Dr Billings, MT 59105
1343 Twin Lakes Dr Billings, MT 59105	111 Uinta Park Dr Billings, MT 59105	125 Uinta Park Dr Billings, MT 59105
137 Uinta Park Dr Billings, MT 59105	1210 Mirror Lake Ln Billings, MT 59105	1217 Crystal Lake Ln Billings, MT 59105
1229 Crystal Lake Ln Billings, MT 59105	1243 Crystal Lake Ln Billings, MT 59105	1255 Crystal Lake Ln Billings, MT 59105
1267 Crystal Lake Ln Billings, MT 59105	1279 Crystal Lake Ln Billings, MT 59105	1295 Crystal Lake Ln Billings, MT 59105
1314 Crystal Lake Ln Billings, MT 59105	1323 Crystal Lake Ln Billings, MT 59105	1333 Crystal Lake Ln Billings, MT 59105
1326 Crystal Lake Ln Billings, MT 59105	1318 Crystal Lake Ln Billings, MT 59105	1298 Crystal Lake Ln Billings, MT 59105
1282 Crystal Lake Ln Billings, MT 59105	1276 Crystal Lake Ln Billings, MT 59105	1264 Crystal Lake Ln Billings, MT 59105
1252 Crystal Lake Ln Billings, MT 59105	1240 Crystal Lake Ln Billings, MT 59105	1226 Crystal Lake Ln Billings, MT 59105
1218 Crystal Lake Ln Billings, MT 59105	1219 Twin Lakes Dr Billings, MT 59105	1233 Twin Lakes Dr Billings, MT 59105

1241 Twin Lakes Dr Billings, MT 59105	1257 Twin Lakes Dr Billings, MT 59105	1265 Twin Lakes Dr Billings, MT 59105
1277 Twin Lakes Dr Billings, MT 59105	1289 Twin Lakes Dr Billings, MT 59105	1309 Twin Lakes Dr Billings, MT 59105
1317 Twin Lakes Dr Billings, MT 59105	1370 Twin Lakes Dr Billings, MT 59105	1352 Twin Lakes Dr Billings, MT 59105
1340 Twin Lakes Dr Billings, MT 59105	1334 Twin Lakes Dr Billings, MT 59105	1328 Twin Lakes Dr Billings, MT 59105
1322 Twin Lakes Dr Billings, MT 59105	1312 Twin Lakes Dr Billings, MT 59105	1294 Twin Lakes Dr Billings, MT 59105
1282 Twin Lakes Dr Billings, MT 59105	1266 Twin Lakes Dr Billings, MT 59105	1252 Twin Lakes Dr Billings, MT 59105
1244 Twin Lakes Dr Billings, MT 59105	1232 Twin Lakes Dr Billings, MT 59105	1220 Twin Lakes Dr Billings, MT 59105
1215 Watson Peak Rd Billings, MT 59105	1227 Watson Peak Rd Billings, MT 59105	1239 Watson Peak Rd Billings, MT 59105
1251 Watson Peak Rd Billings, MT 59105	1267 Watson Peak Rd Billings, MT 59105	1279 Watson Peak Rd Billings, MT 59105
1287 Watson Peak Rd Billings, MT 59105	1303 Watson Peak Rd Billings, MT 59105	1315 Watson Peak Rd Billings, MT 59105
1329 Watson Peak Rd Billings, MT 59105	1337 Watson Peak Rd Billings, MT 59105	1351 Watson Peak Rd Billings, MT 59105
1392 Watson Peak Rd Billings, MT 59105	1380 Watson Peak Rd Billings, MT 59105	1368 Watson Peak Rd Billings, MT 59105
1356 Watson Peak Rd Billings, MT 59105	1344 Watson Peak Rd Billings, MT 59105	1332 Watson Peak Rd Billings, MT 59105
1320 Watson Peak Rd Billings, MT 59105	1308 Watson Peak Rd Billings, MT 59105	1296 Watson Peak Rd Billings, MT 59105
1284 Watson Peak Rd Billings, MT 59105	1272 Watson Peak Rd Billings, MT 59105	1260 Watson Peak Rd Billings, MT 59105
1248 Watson Peak Rd Billings, MT 59105	1236 Watson Peak Rd Billings, MT 59105	1224 Watson Peak Rd Billings, MT 59105
1260 Calendula Cir Billings, MT 59105	1248 Calendula Cir Billings, MT 59105	1234 Calendula Cir Billings, MT 59105

1222 Calendula Cir
Billings, MT 59105

1190 Calendula Cir
Billings, MT 59105

182 Butterfly Lake Ln
Billings, MT 59105

166 Butterfly Lake Ln
Billings, MT 59105

150 Butterfly Lake Ln
Billings, MT 59105

134 Butterfly Lake Ln
Billings, MT 59105

118 Butterfly Lake Ln
Billings, MT 59105

102 Butterfly Lake Ln
Billings, MT 59105

96 Butterfly Lake Ln
Billings, MT 59105

84 Butterfly Lake Ln
Billings, MT 59105

72 Butterfly Lake Ln
Billings, MT 59105

Mirror Lake Ln
Billings, MT 59105

DESCRIPTION:

Block 2: Lots 20, 21, 31 and 32

Block 3: Lots 1, 2, 3, 4, 5, 6, 7, 8, 9 and 10

Block 4: 12, 13, 14, 15, 16, 17, 18, 19, 20, 21, 22, 23 and 24

Block 5: Lots 1, 2, 3, 4, 5, 6, 7, 8, 9, 10, 11, 12, 13, 14, 15, 16, 17, 18, 19, 20, 21, 22 and 23

Block 6: Lots 1, 2, 3, 4, 5, 6, 7, 8, 9, 10, 11, 12, 13, 14, 15, 16, 17, 18, 19, 20, 21, 22, 23, 24, 25, 26, 27, 28 and 29

Block 7: Lots 1, 2, 3, 4, 5, 6, 7, 8, 9, 10, 11, 12, 13, 14, 15, 16, 18, 19, 20, 21 and 22

Block 8: Lots 1, 2, 3, 4, 5, 6, 7, 8 and 9

of Uinta Park Subdivision, in the City of Billings, Yellowstone County, Montana, according to the official plat on file in the office of the Clerk and Recorder of said County, under Document #3234621.

End of Report

EXHIBIT "D"

ESTIMATE OF PROBABLE COST
 EXTENDED SPECIAL IMPROVEMENTS MAINTENANCE DISTRICT
 UINTA PARK SUBDIVISION PARK MAINTENANCE DISTRICT NO. 4026

1. The City of Billings Department of Parks, Recreation, and Public Lands estimates the maintenance of the improvements for the first year to be \$11,518.
2. The assessment for the first year is as follows:

CITY OF BILLINGS - PARK MAINTENANCE DISTRICT NO. 4026 ESTIMATE OF ANNUAL MAINTENANCE COSTS				
PMD Number: 4026		PMD Description: Uinta Park Subdivision		
Date: <u>February 28, 2005</u>				
BA SUB	ELE	SUB OBJ	ACCOUNT DESCRIPTION	ESTIMATED MAINTENANCE COSTS
	34	10	Operations and Supplies	
		20	Electricity	\$259.00
		50	City Water	\$3,500.00
		50	Ground Maintenance	\$1,600.00
	39	65	Other Service/Finance Charges	\$400.00
		90	Parks Charge for Services	\$4,809.00
	54	10	Special Assessments	\$450.00
			Total Operations and Supplies, Etc.	\$11,018.00
			Capital E/I Reserve	\$500.00
			Total Uinta Park Subdivision PMD O & M Annual Cost Estimate	\$11,518.00
			Park area to be maintained (Square Feet)	165,968
			Equal Assessment Per Lot (Number of Lots)	169
			1st year Assessment (Per Lot)	\$68.153846