

ORDINANCE NO. 01-5177

AN ORDINANCE OF THE CITY OF BILLINGS, AMENDING BILLINGS MUNICIPAL CODE, CHAPTER 11, ELECTIONS, IN PARTICULAR, SECTION 11-102(c), WARD BOUNDARIES; AND CHANGING THE WARD BOUNDARIES ESTABLISHED THEREIN BY ADDING CERTAIN NEWLY ANNEXED REAL PROPERTY TO WARD III, PROVIDING FOR CERTIFICATION AND REPEALING OF ALL ORDINANCES AND RESOLUTIONS INCONSISTENT THEREWITH.

BE IT RESOLVED BY THE CITY COUNCIL OF THE CITY OF BILLINGS, MONTANA:

1. AMENDMENT. Pursuant to Billings Municipal Code, Section 1.16.030, and the State Law, Billings Municipal Code, Section 1.16.030 Ward Boundaries, is hereby amended by adding to the following designated Ward the following described real property:

WARD III:

Tract 1, C/S 2099 and T1S-R25E-S13: NWSWSWNW EXCEPT C/S 2206, C/S 2252, C/S 2155, Corrected C/S 1907, C/S 1445, C/S 2548, C/S 2099 and that part reserved for the main canal of Billings land and Irrigation Co. by WD recorded in Book V, Page 107.

(#01-16)

2. CERTIFICATION. Pursuant to M.C.A. Section 13-3-103, the above change and alteration is hereby certified to the election administrator by the City Council, and the City Administrator or his designee is hereby directed to certify the changes and alterations and to deliver a map showing the boundaries of the ward, the streets, avenues and alleys by name, and the ward by number, to the election administrator not more than ten (10) days after the effective date of this ordinance.

3. REPEALER. All other ordinances, sections of the Billings Municipal Code and ordinances inconsistent herewith are hereby repealed.

PASSED by the City Council on the first reading this 13th day of November, 2001.

PASSED, ADOPTED AND APPROVED on second reading this 26th day of November, 2001.



THE CITY OF BILLINGS:

BY: Charles F. Tooley
Charles F. Tooley, MAYOR

ATTEST:

BY: Susan Shubler
Marita Herold, CMC CITY CLERK ~~Deputy City Clerk~~

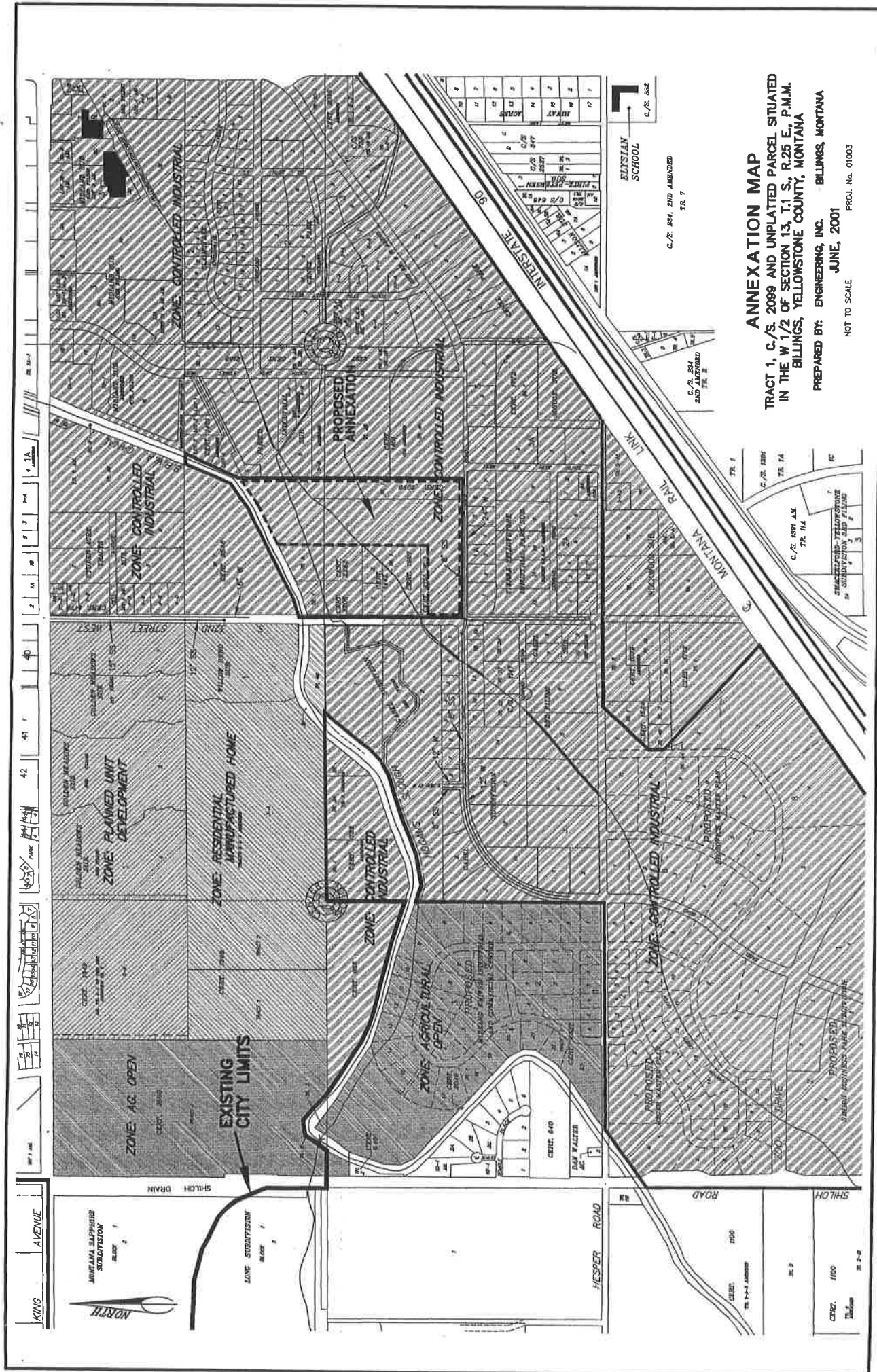

ANNEXATION MAP
TRACT 1, C./S. 2099 AND UNPLATTED PARCEL SITUATED
IN THE W 1/2 OF SECTION 13, T.1 S., R.25 E., P.M.M.
BILLINGS, YELLOWSTONE COUNTY, MONTANA

PREPARED BY: **ENGINEERING, INC.** BILLINGS, MONTANA
JUNE, 2001

NOT TO SCALE
 PROJ. No. 01003

KING AVENUE



MONTANA SAPPERS SUBDIVISION

SHILOH DRAIN

ZONE SUBSTITUTION

HESPER ROAD

ROAD

SHILOH

41 42 43 44 45 46 47 48 49 50 51 52 53 54 55 56 57 58 59 60 61 62 63 64 65 66 67 68 69 70 71 72 73 74 75 76 77 78 79 80 81 82 83 84 85 86 87 88 89 90 91 92 93 94 95 96 97 98 99 100

101 102 103 104 105 106 107 108 109 110 111 112 113 114 115 116 117 118 119 120 121 122 123 124 125 126 127 128 129 130 131 132 133 134 135 136 137 138 139 140 141 142 143 144 145 146 147 148 149 150 151 152 153 154 155 156 157 158 159 160 161 162 163 164 165 166 167 168 169 170 171 172 173 174 175 176 177 178 179 180 181 182 183 184 185 186 187 188 189 190 191 192 193 194 195 196 197 198 199 200

ELSTIAN SCHOOL
 C./S. 852

C./S. 204 AND AMENDED
 TR. 7

C./S. 204 AND AMENDED
 TR. 7

C./S. 1881 A/E
 TR. 1/A

C./S. 1881 A/E
 TR. 1/A

C./S. 1881 A/E
 TR. 1/A

C./S. 1881 A/E
 TR. 1/A

C./S. 1881 A/E
 TR. 1/A

C./S. 1881 A/E
 TR. 1/A

C./S. 1881 A/E
 TR. 1/A

C./S. 1881 A/E
 TR. 1/A

C./S. 1881 A/E
 TR. 1/A

C./S. 1881 A/E
 TR. 1/A

C./S. 1881 A/E
 TR. 1/A

C./S. 1881 A/E
 TR. 1/A

C./S. 1881 A/E
 TR. 1/A

C./S. 1881 A/E
 TR. 1/A

C./S. 1881 A/E
 TR. 1/A

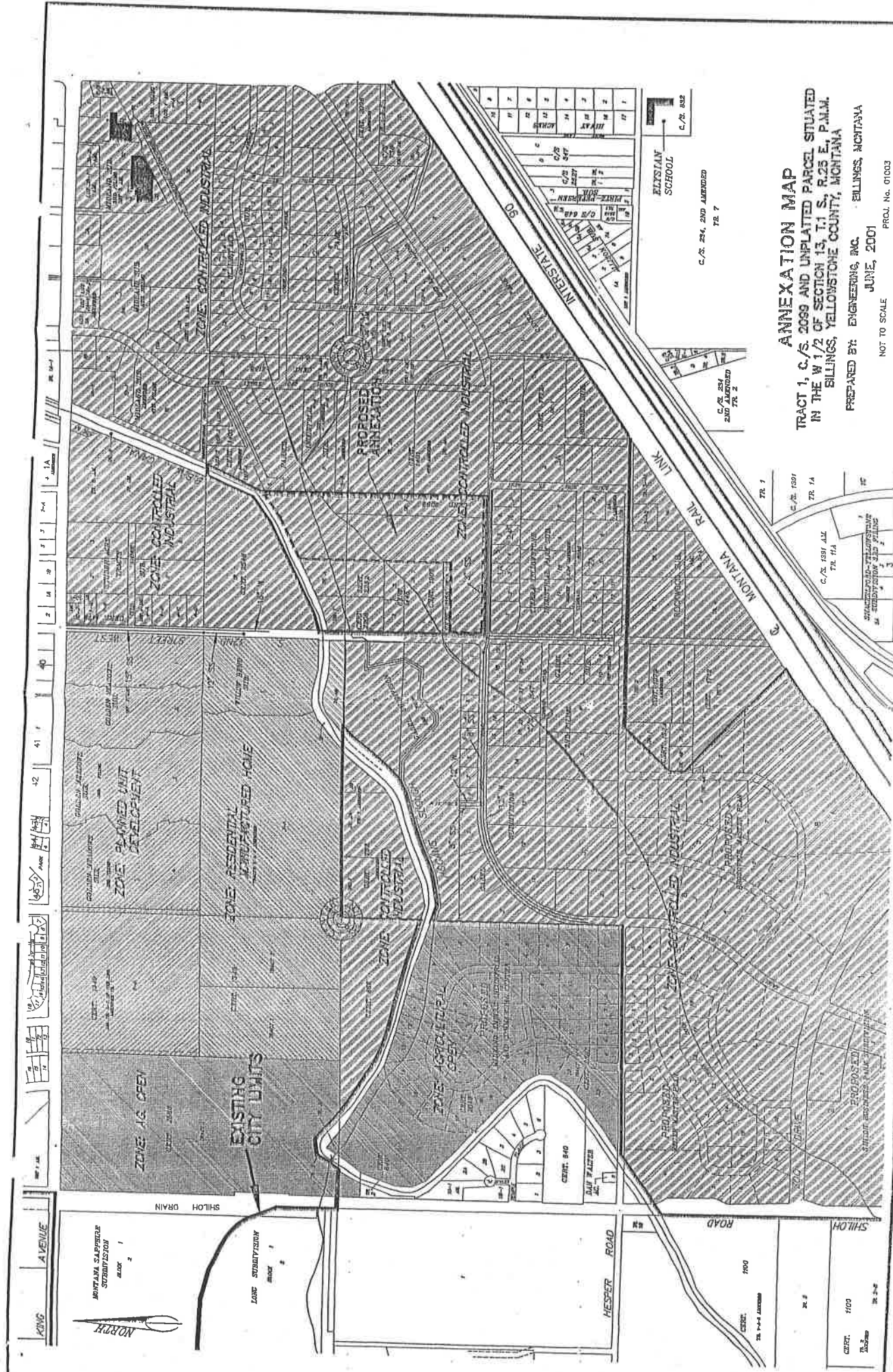

ANNEXATION MAP
 TRACT 1, C/S 2099 AND UNPLATTED PARCEL SITUATED
 IN THE W 1/2 OF SECTION 13, T.1 S., R.25 E., P.M.M.
 BILLINGS, YELLOWSTONE COUNTY, MONTANA
 PREPARED BY: ENGINEERING, INC. BILLINGS, MONTANA
 JUNE, 2001

NOT TO SCALE
 PROJ. No. 01003

ELYSIAN SCHOOL
 C.S. 832

C.S. 284, 2ND AMENDED
 TR. 7

C.S. 1891
 2ND AMENDED
 TR. 2

TR. 1

C.S. 1891
 TR. 1A

C.S. 1891 ALE
 TR. 1A

PROPOSED
 MOUNTAIN CREEK SUBDIVISION
 IN SUBDIVISION 213 BILLINGS

KING AVENUE

MONTANA GAS SERVICE
 SUBDIVISION
 400' 1
 2

SHILOH DRAIN

LONG SUBDIVISION
 BLOCK 1

HESSER ROAD

ROAD

SHILOH

CEMET. 1100
 TR. 2-4-5 AMENDED
 TR. 2-4