

# SILMD 311

## RESOLUTION NO. 13-19251

A RESOLUTION OF INTENTION TO CREATE SPECIAL IMPROVEMENT LIGHTING MAINTENANCE DISTRICT NO. 311 OF THE CITY OF BILLINGS, MONTANA, FOR THE PURPOSE OF PROVIDING ENERGY AND MAINTENANCE FOR STREET LIGHTS, DESIGNATING THE NUMBER OF SAID DISTRICT, DESCRIBING THE BOUNDARIES THEREOF, STATING THE GENERAL CHARACTER OF THE IMPROVEMENTS TO BE MADE, ESTABLISHING THE ESTIMATE OF THE COST OF MAINTAINING SUCH LIGHTS AND SUPPLYING ELECTRICAL CURRENT THEREFOR FOR THE FIRST YEAR, THE PROPORTION OF THE COST TO BE ASSESSED AGAINST THE ABUTTING PROPERTY, AND THE METHOD OF ASSESSMENT OF SAID COST.

WHEREAS, the City Council of Billings, Montana, has determined that the public interest and convenience require the creation of a Special Improvement Lighting Maintenance District as hereinafter provided;

NOW THEREFORE, BE IT RESOLVED BY THE CITY COUNCIL OF THE CITY OF BILLINGS, MONTANA:

### SECTION 1:

That the public interest and convenience require, and it is deemed necessary, to create a Special Improvement Lighting Maintenance District for the purpose providing energy and maintenance for new street lights for lighting in said district; and the intention of said City Council to create such a district, hereinafter more particularly described, is hereby declared.

### SECTION 2:

That said district shall be known and designated as "Special Improvement Lighting Maintenance District No. 311" hereinafter called the District, and the boundaries of the District are hereby declared to include lots, parcels and pieces of land abutting Rimrock Road between Shiloh Road and Forsythia Boulevard, excluding Parcel A23219; but including Parcels A24344; A24345; A23233; A27125 through A27140; A23220A through A23220C; A23223; A23223A through A23223L; and A23221; as shown on the map designated as Exhibit "A" attached hereto, and as described in Exhibit "B" which is attached hereto.

### SECTION 3:

That the City of Billings, Montana, hereby finds, determines and declares that each of the lots, blocks, pieces and parcels of land situated within the boundaries of the District, will be especially benefited and affected by said improvements, and that all of the property included within the District is hereby declared to be the property to be assessed for the cost and expense of obtaining the electrical energy for and maintenance of said street lights.

### SECTION 4:

That the general character of the improvements to be made for the District is hereby declared to be as follows: The provision of energy and maintenance for street lighting facilities consisting of forty (40) 144-watt LED luminaries. The City of Billings shall own and install the streetlights and all associated appurtenant structures and materials.

### SECTION 5:

The City of Billings intends to establish the contract rate for supplying electrical energy in accordance with the rate schedule approved by the Montana Public Service Commission. Said rate is currently estimated at \$5.75 per unit, per month, and that NorthWestern Energy Company shall provide energy to the lighting fixtures. That the City of Billings shall provide normal maintenance to lighting fixtures, poles, cables and other incidental equipment, and shall at all times own said lighting fixtures, poles, cables and other incidental equipment.

SECTION 6:

The estimate of the cost of the District per year, including City administrative costs, is the sum of \$6,575.36; that the entire cost of said District shall be paid by the owners of the property within said District, with each lot, parcel or piece of land within the District to be assessed for that portion of the whole cost which it's assessable lot frontage bears to the assessable lot frontage of the entire District, exclusive of streets, avenues, alleys and public places. The estimated cost of the District per year for property owners is on the basis of approximately \$0.5617 per linear foot.

SECTION 7:

That the entire cost of the District shall be paid by an annual assessment against the property in the District; that annually, pursuant to MCA 7-12-4332, the City Council shall adopt a resolution estimating the cost of maintaining said lights including a reserve, and furnishing electrical current and assessing all of said property within said District for the annual costs; that all monies derived from the collection of such assessments shall be paid into a fund to be known as "Special Lighting Maintenance District No. 311 Maintenance Fund," and warrants shall be drawn on said fund for the payment of such costs of maintaining such lights and supplying electrical current therefore.

SECTION 8:

That on the 22<sup>nd</sup> day of April, 2013, at 6:30 o'clock p.m., at the Council Chambers of the City Hall in said City, the City Council intends to create such Special Improvement Lighting Maintenance District No. 311 and will hear objections and protests against the proposed improvements and the extent and creation of such District to be assessed, or any matter pertaining thereto, at said time and place, by any person, firm, or corporation who has filed a written protest with the City Clerk of the City of Billings within fifteen (15) days after the date on which the Notice of the passage of this Resolution of Intention is published in "The Billings Times".

SECTION 9:

That the City Clerk is hereby authorized and directed to publish a copy of the Notice of the passage of this Resolution in "The Billings Times", a weekly newspaper published and circulated in the City of Billings, Montana, and to send a copy of said Notice to the owners of all the lots, blocks, pieces or parcels of land included within the boundaries of said Special Improvement Lighting Maintenance District No. 311. Said notice is to be published and mailed on the same date.

PASSED by the City Council and APPROVED this 25<sup>th</sup> day of March, 2013.

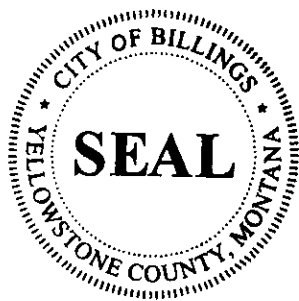

CITY OF BILLINGS

By Thomas W. Hanel  
Thomas W. Hanel, Mayor

ATTEST:

By Cari Martin  
Cari Martin, City Clerk

# SILMD 311 EXHIBIT A

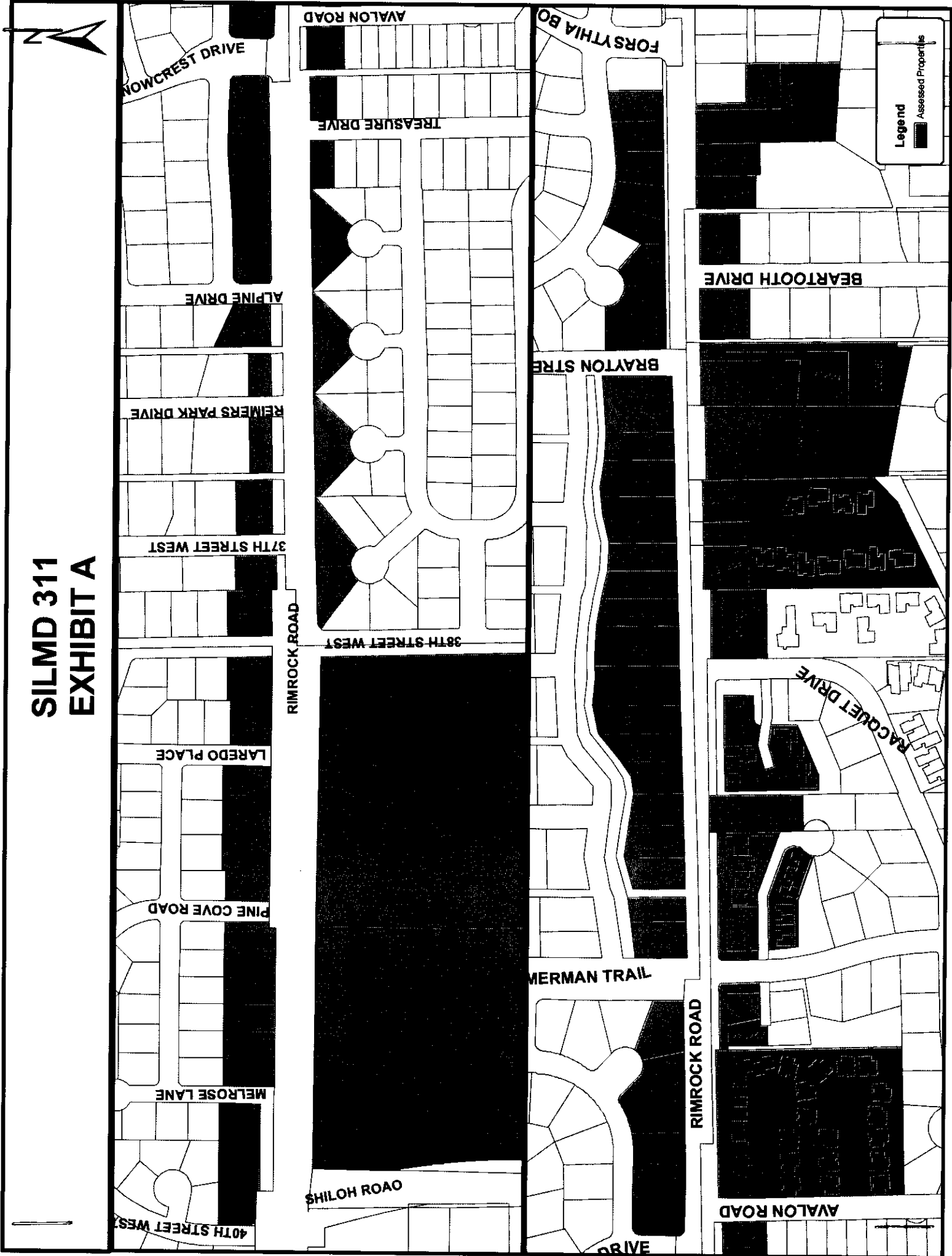

TaxID	OwnerName	PhysicalAddress	Lot	Block	LegalDescription	Lot Frontage	Assessment
A02624	ANDERSON, MICHAEL R & LUANNE	2825 TREASURE DR	10	2	BAILEY SUBD, S34, T01 N, R25 E, BLOCK 2, Lot 10, LT 10 (LESS S30')	126.80	\$ 71.23
A02915	BERNSTEIN, WADE R & DAWN	2840 BEARTOOTH DR	1	2	BEARTOOTH SUBD, S34, T01 N, R25 E, BLOCK 2, Lot 1 - 4	126.85	\$ 71.25
A02924	PEHLER, ALBERT H & SUSAN D	2825 BEARTOOTH DR	1	3	BEARTOOTH SUBD, S34, T01 N, R25 E, BLOCK 3, Lot 1 - 4	126.86	\$ 71.26
A06461	KOEPFER, SAMUEL J	3301 RIMROCK RD	1	9	DURLAND HEIGHTS SUBD, S27, T01 N, R25 E, BLOCK 9, Lot 1, LT 1 BLK 9 DURLAND HEIGHTS SUBD 30' ABDN FARNAM ST ADJ TO	100.00	\$ 56.17
A06462	GREEN, GEORGE G & VIRGINIA E	3307 RIMROCK RD	2	9	DURLAND HEIGHTS SUBD, S27, T01 N, R25 E, BLOCK 9, Lot 2	70.00	\$ 39.32
A06463	VULETICH, DANIEL	3313 RIMROCK RD	3	9	DURLAND HEIGHTS SUBD, S27, T01 N, R25 E, BLOCK 9, Lot 3	70.00	\$ 39.32
A06464	HARPER, CHARLES	3319 RIMROCK RD	4	9	DURLAND HEIGHTS SUBD, S27, T01 N, R25 E, BLOCK 9, Lot 4	80.00	\$ 44.94
A06465	DESCOJO, ANTHONY N	3327 RIMROCK RD	5	9	DURLAND HEIGHTS SUBD, S27, T01 N, R25 E, BLOCK 9, Lot 5	80.00	\$ 44.94
A06466	BENNETT, CHRISTOPHER E	3331 RIMROCK RD	6	9	DURLAND HEIGHTS SUBD, S27, T01 N, R25 E, BLOCK 9, Lot 6	80.00	\$ 44.94
A06467	SWANZ, DUANE, & DAVE	3337 RIMROCK RD	7	9	DURLAND HEIGHTS SUBD, S27, T01 N, R25 E, BLOCK 9, Lot 7	80.00	\$ 44.94
A06468	MCCARTHY, MERRILL SHAWN	3409 RIMROCK RD	8	9	DURLAND HEIGHTS SUBD, S27, T01 N, R25 E, BLOCK 9, Lot 8, E70.25 FT LT 8	70.25	\$ 39.46
A06469	SCHMALL, SARA	3411 RIMROCK RD	8	9	DURLAND HEIGHTS SUBD, S27, T01 N, R25 E, BLOCK 9, Lot 8, W80 FT LT 8	80.00	\$ 44.94
A06470	STONEBRAKER, WINDY RENEE'	3205 RIMROCK RD	1	10	DURLAND HEIGHTS SUBD, S27, T01 N, R25 E, BLOCK 10, Lot 1 - 2	140.00	\$ 78.64
A06471	LENHARDT, CHERYL L	3209 RIMROCK RD	3	10	DURLAND HEIGHTS SUBD, S27, T01 N, R25 E, BLOCK 10, Lot 1 - 2	70.00	\$ 39.32
A06472	SKIDMORE, MARLON E & DONNA J	3215 RIMROCK RD	4	10	DURLAND HEIGHTS SUBD, S27, T01 N, R25 E, BLOCK 10, Lot 3	100.00	\$ 56.17
A06473	STANDISH, VERNON D & JOAN R TRUS	3235 RIMROCK RD	5	10	DURLAND HEIGHTS SUBD, S27, T01 N, R25 E, BLOCK 10, Lot 4, & E30 FT LT 5	110.00	\$ 61.79
A06474	MARTINEZ, BRANDEN C & LORI B	3237 RIMROCK RD	7	10	DURLAND HEIGHTS SUBD, S27, T01 N, R25 E, BLOCK 10, Lot 5 - 6, LOT 6 AND W 40 FT OF 5	79.50	\$ 44.66
A06474A	TRAYER, AMANDA RAE	3241 RIMROCK RD	8	10	DURLAND HEIGHTS SUBD, S27, T01 N, R25 E, BLOCK 10, Lot 7 - 8, & E9.5 FT LT 8	60.50	\$ 33.98
A06475	LANES, GREGORY L & VIRGINIA W	3245 RIMROCK RD	9	10	DURLAND HEIGHTS SUBD, S27, T01 N, R25 E, BLOCK 10, Lot 8, LESS E 9 1/2 FT	70.00	\$ 39.32
A06476	COOKE, CLIFFORD C & LESLIE M	3255 RIMROCK RD	10	10	DURLAND HEIGHTS SUBD, S27, T01 N, R25 E, BLOCK 10, Lot 9	100.00	\$ 56.17
A12533A	UNRUH, JASON DOUGLAS & JANEEN L	3737 RIMROCK RD	1		PAISADES PARK SUBD 3RD FILING, S27, T01 N, R25 E, Lot 1, & 30 FT ABDN FARNAM ST ADJ TO LT 10	67.50	\$ 37.92
A12533B	HALTER, ALLEN J & DEBRA A	3739 RIMROCK RD	2		PAISADES PARK SUBD 3RD FILING, S27, T01 N, R25 E, Lot 2, & 510' ADJ ALLEY	67.50	\$ 37.92
A12943	RUFF, DEREK L & KELLY M	3619 DONNA DR	3		POLY VISTA SUBD, S34, T01 N, R25 E, Lot 3, BLK 1 & 2 AMND	150.00	\$ 84.26
A12943A	MCGRAIL, LARRY J II & ASSUNTA M	3623 DONNA DR	4		POLY VISTA SUBD, S34, T01 N, R25 E, Lot 4, BLK 1 & 2 AMND	150.00	\$ 84.26
A12946	MADILL, WILLIAM F	3643 DONNA DR	9A		POLY VISTA SUBD, S34, T01 N, R25 E, Lot 9A, AMND (98)	150.00	\$ 84.26
A12946A	JUROVICH, GEORGE H & KATHY L	3647 DONNA DR	10		POLY VISTA SUBD, S34, T01 N, R25 E, Lot 10, AMND BL 1 & 2 (95)	150.00	\$ 84.26
A12949	PICARD, SHAY C & TIFAN D	3719 DONNA DR	15		POLY VISTA SUBD, S34, T01 N, R25 E, Lot 15, BLK 1 & 2 AMND	150.00	\$ 84.26
A12949A	WILLIAMS, DALE W & DANIELLE R	3723 DONNA DR	16A		POLY VISTA SUBD, S34, T01 N, R25 E, Lot 16A, AMD LTS 16-18 (05)	150.00	\$ 84.26
A12951	LAIS DEVELOPMENT, INC	3775 DONNA DR	3	1	POLY VISTA ESTATES SUBD, S34, T01 N, R25 E, BLOCK 1, Lot 3	204.11	\$ 114.65
A12951A	BUSCHER, DENNIS J & LINDA	3789 DONNA DR	4	1	POLY VISTA ESTATES SUBD, S34, T01 N, R25 E, BLOCK 1, Lot 4	184.01	\$ 103.36
A12955A	JOHNSON, JENNIFER L & NEIL	2820 TREASURE DR	15	1	POLY VISTA SUBD, S34, T01 N, R25 E, BLOCK 1, Lot 15, & 10' X 68.36' VAC ALLEY	134.08	\$ 75.31
A13161	MAXWELL, CHARLES R & CAROL J	3633 RIMROCK RD	1A	1	REIMERS PARK SUBD, S27, T01 N, R25 E, BLOCK 1, Lot 1A	125.00	\$ 70.21
A13174	NASH AND STELLA PAZ LIVING TRUST,	2903 REIMERS PARK DR	16A	1	REIMERS PARK SUBD, S27, T01 N, R25 E, BLOCK 1, Lot 16A, AMND	125.00	\$ 70.21
A13175	EMMANUEL BAPTIST CHURCH	REIMERS PARK DR	1A	2	REIMERS PARK SUBD, S27, T01 N, R25 E, BLOCK 2, Lot 1A, AMND LT 1	164.00	\$ 92.12
A13185A	GUNVILLE, EDWARD L & MYRTLE	3695 RIMROCK RD	16	2	REIMERS PARK SUBD, S27, T01 N, R25 E, BLOCK 2, Lot 16, N 105' LT 16 (95)	160.00	\$ 89.87
A13203	STONE, SABRA S	3735 RIMROCK RD	1		REIMERS SUBD, S27, T01 N, R25 E, Lot 1, & S10 FT ADJ ALLEY (LESS HWY)	102.00	\$ 57.29
A13844	HARPER, AMIRA	3212 RIMROCK RD	1		SAUNDERS SUBD 2ND FILING, S34, T01 N, R25 E, Lot 1	176.31	\$ 99.04
A13982	PANGBURN, EDNA	3332 RIMROCK RD	8		SKY VIEW SUBD 1ST FILING, S34, T01 N, R25 E, Lot 8	91.54	\$ 51.42
A16829	KOBER, JONATHAN D & DIANE M	3546 RIMROCK RD	1	2	SWARTZ-MCGEORGE SUBD, S34, T01 N, R25 E, BLOCK 2, Lot 1, S110'	63.39	\$ 35.61
A16830	ALARCON, HERBERT J & SONIA C	3558 RIMROCK RD	2	2	SWARTZ-MCGEORGE SUBD, S34, T01 N, R25 E, BLOCK 2, Lot 2, S110'	63.39	\$ 35.61
A17084A	LIFEWAY CHURCH OF BILLINGS	RIMROCK RD	7		TIFFANY SUBD, S34, T01 N, R25 E, Lot 7 - 8, LESS N210' & LT 8 LESS E45' OF N210'	85.00	\$ 47.75
A17085	FORD, ALAN L	3054 RIMROCK RD	7		TIFFANY SUBD, S34, T01 N, R25 E, Lot 7 - 8, 585' N210' LT 7 & E45' N210' LT 8	15.00	\$ 8.43
A17086	LIFEWAY CHURCH OF BILLINGS	3112 RIMROCK RD	9		TIFFANY SUBD, S34, T01 N, R25 E, Lot 9 - 10, N160' LT 9 ALSO E8.65' OF N160' LT 10	80.00	\$ 44.94
A17088	LIFEWAY CHURCH OF BILLINGS	3118 RIMROCK RD	10		TIFFANY SUBD, S34, T01 N, R25 E, Lot 10, N150' LESS E8.65'	91.35	\$ 51.31
A20259	HOLLY D HUENNEKENS TRUST	3230 RIMROCK RD	10	3	SKY VIEW SUBD 2ND FILING, S34, T01 N, R25 E, BLOCK 3, Lot 10	110.00	\$ 61.79
A20384	JAEGER, BLAKE & JENNIFER	3414 FLAGSTONE DR	4	1	CASTLEWOOD SUBD 3RD FILING, S27, T01 N, R25 E, BLOCK 1, Lot 4	115.00	\$ 64.60

TaxID	OwnerName	PhysicalAddress	Lot	Block	LegalDescription	Lot Frontage	Assessment
A20385	PALMER, SHAWN R	3418 FLAGSTONE DR	5	1	CASTLEWOOD SUBD 3RD FILING, S27, T01 N, R25 E, BLOCK 1, Lot 5	129.30	\$ 72.63
A20386	EICHELE, ARTHUR JAMES & MICHELLE	3422 FLAGSTONE DR	6	1	CASTLEWOOD SUBD 3RD FILING, S27, T01 N, R25 E, BLOCK 1, Lot 6	70.00	\$ 39.32
A20387	WINPFHEIMER, STEVE & KATHY	3428 FLAGSTONE DR	7	1	CASTLEWOOD SUBD 3RD FILING, S27, T01 N, R25 E, BLOCK 1, Lot 7, LT 7 BLK 1 CASTLEWOOD SUBD 3RD FILING	95.00	\$ 53.36
A20388	HAWK, J WILLIAM & JANET S	3504 FLAGSTONE DR	8	1	CASTLEWOOD SUBD 3RD FILING, S27, T01 N, R25 E, BLOCK 1, Lot 8	85.00	\$ 47.75
A20389	GLENN, PATRICIA J	2911 SNOWCREST DR	9	1	CASTLEWOOD SUBD 3RD FILING, S27, T01 N, R25 E, BLOCK 1, Lot 9	97.51	\$ 54.77
A21237	VESTA VENTURES, LLP	3304 RIMROCK RD	11	3	SKY VIEW SUBD 3RD, S34, T01 N, R25 E, BLOCK 3, Lot 11	174.30	\$ 97.91
A21555	PARKER, ANDREW	3106 MARGUERITE BLVD	2	1	WILSHIRE HEIGHTS SUBD 7TH, S27, T01 N, R25 E, BLOCK 1, Lot 2	75.00	\$ 42.13
A21556	CRONIN, CAROL J	3110 MARGUERITE BLVD	3	1	WILSHIRE HEIGHTS SUBD 7TH, S27, T01 N, R25 E, BLOCK 1, Lot 3	76.00	\$ 42.69
A21557	ROWCLIFFE, DONALD C & MARVEL S	3114 MARGUERITE BLVD	4	1	WILSHIRE HEIGHTS SUBD 7TH, S27, T01 N, R25 E, BLOCK 1, Lot 4	87.00	\$ 48.87
A21558	WILKINS, DARRIN B & KERRI J	3138 MARGUERITE BLVD	5	1	WILSHIRE HEIGHTS SUBD 7TH, S27, T01 N, R25 E, BLOCK 1, Lot 5	87.00	\$ 48.87
A21559	KELLER, TREL J & SAMIE L	3120 MARGUERITE BLVD	6	1	WILSHIRE HEIGHTS SUBD 7TH, S27, T01 N, R25 E, BLOCK 1, Lot 6	57.25	\$ 32.16
A21561	BURKHARDT, VINCE	3124 DATURA DR	8	1	WILSHIRE HEIGHTS SUBD 7TH, S27, T01 N, R25 E, BLOCK 1, Lot 8	105.00	\$ 58.98
A21562	MERCER, R DOUGLAS	3126 DATURA DR	9	1	WILSHIRE HEIGHTS SUBD 7TH, S27, T01 N, R25 E, BLOCK 1, Lot 9	134.00	\$ 75.27
A21563	ASH, PENNEY M	3128 DATURA DR	10	1	WILSHIRE HEIGHTS SUBD 7TH, S27, T01 N, R25 E, BLOCK 1, Lot 10	26.17	\$ 14.70
A23220A	PATTERSON, KENNETH D & CAMERON	3349 RACQUET DR	02A	001	E M TOWNHOMES, S34, T01 N, R25 E, UNIT 1, 8.05% COMMON AREA INTEREST, LOC @ LTS 2A, 5A, 5B BLK 1 RACQUET CLUB HE	9.26	\$ 5.20
A23220B	SOBERING, DARRYL & RENEE M	3347 RACQUET DR	02A	001	E M TOWNHOMES, S34, T01 N, R25 E, UNIT 2, 8.05% COMMON AREA INTEREST, LOC @ LTS 2A, 5A, 5B BLK 1 RACQUET CLUB HE	9.26	\$ 5.20
A23220C	HELMUTH, TRISTA	3345 RACQUET DR	02A	001	E M TOWNHOMES, S34, T01 N, R25 E, UNIT 3, 8.05% COMMON AREA INTEREST, LOC @ LTS 2A, 5A, 5B BLK 1 RACQUET CLUB HE	9.26	\$ 5.20
A23221	ROGER F DALLNER TRUST	3305 RACQUET DR	3	1	RACQUET CLUB HEIGHTS, S34, T01 N, R25 E, BLOCK 1, Lot 3	125.00	\$ 70.21
A23222	SEBREE, ANDREW	3343 RACQUET DR	02A	001	E M TOWNHOMES, S34, T01 N, R25 E, UNIT 4, 8.05% COMMON AREA INTEREST, LOC @ LTS 2A, 5A, 5B BLK 1 RACQUET CLUB HE	9.26	\$ 5.20
A23223A	HALVORSEN, MATTHEW L & KENDRA	3341 RACQUET DR	02A	001	E M TOWNHOMES, S34, T01 N, R25 E, UNIT 5, 8.05% COMMON AREA INTEREST, LOC @ LTS 2A, 5A, 5B BLK 1 RACQUET CLUB HE	9.26	\$ 5.20
A23223B	YECOMAN, DANIEL ROBERT	3339 RACQUET DR	02A	001	E M TOWNHOMES, S34, T01 N, R25 E, UNIT 6, 8.05% COMMON AREA INTEREST, LOC @ LTS 2A, 5A, 5B BLK 1 RACQUET CLUB HE	9.26	\$ 5.20
A23223E	SCHINDELE, J PATRICK & MICHELE	3363 RACQUET DR	02A	001	E M TOWNHOMES, S34, T01 N, R25 E, UNIT 7A, 6.46% COMMON AREA INTEREST, LOC @ LTS 2A, 5A, 5B BLK 1 RACQUET CLUB HE	7.43	\$ 4.17
A23223F	SCHINDELE, J PATRICK	3359 RACQUET DR	02A	001	E M TOWNHOMES, S34, T01 N, R25 E, UNIT 7B, 6.46% COMMON AREA INTEREST, LOC @ LTS 2A, 5A, 5B BLK 1 RACQUET CLUB HE	7.43	\$ 4.17
A23223G	SCHINDELE, J PATRICK & MICHELE	3365 RACQUET DR	02A	001	E M TOWNHOMES, S34, T01 N, R25 E, UNIT 7C, 6.46% COMMON AREA INTEREST, LOC @ LTS 2A, 5A, 5B BLK 1 RACQUET CLUB HE	7.43	\$ 4.17
A23223H	SCHINDELE, J PATRICK	3361 RACQUET DR	02A	001	E M TOWNHOMES, S34, T01 N, R25 E, UNIT 7D, 6.46% COMMON AREA INTEREST, LOC @ LTS 2A, 5A, 5B BLK 1 RACQUET CLUB HE	7.43	\$ 4.17
A23223I	ROGER F DALLNER TRUST	3551 RACQUET DR	02A	001	E M TOWNHOMES, S34, T01 N, R25 E, UNIT 8A, 6.46% COMMON AREA INTEREST, LOC @ LTS 2A, 5A, 5B BLK 1 RACQUET CLUB HE	7.43	\$ 4.17
A23223J	ROGER F DALLNER TRUST	3353 RACQUET DR	02A	001	E M TOWNHOMES, S34, T01 N, R25 E, UNIT 8B, 6.46% COMMON AREA INTEREST, LOC @ LTS 2A, 5A, 5B BLK 1 RACQUET CLUB HE	7.43	\$ 4.17
A23223K	ROGER F DALLNER TRUST	3355 RACQUET DR	02A	001	E M TOWNHOMES, S34, T01 N, R25 E, UNIT 8C, 6.46% COMMON AREA INTEREST, LOC @ LTS 2A, 5A, 5B BLK 1 RACQUET CLUB HE	7.43	\$ 4.17
A23223L	ROGER F DALLNER TRUST	3357 RACQUET DR	02A	001	E M TOWNHOMES, S34, T01 N, R25 E, UNIT 8D, 6.46% COMMON AREA INTEREST, LOC @ LTS 2A, 5A, 5B BLK 1 RACQUET CLUB HE	7.43	\$ 4.17
A23232B	CITY OF BILLINGS	RIMROCK RD	1	4	RACQUET CLUB HEIGHTS, S34, T01 N, R25 E, BLOCK 4, Lot 1	318.05	\$ 178.65
A23233	CARSTENS, CHRIS M & MARLENE M	3457 ARLENE CIR	2	4	RACQUET CLUB HEIGHTS, S34, T01 N, R25 E, BLOCK 4, Lot 2	110.00	\$ 61.79
A24343A	CITY OF BILLINGS	RIMROCK RD	1	5	RACQUET CLUB HEIGHTS 2ND, S34, T01 N, R25 E, BLOCK 5, Lot 1	166.90	\$ 93.75
A24344	WRIGHT, MARK D	2840 ZIMMERMAN TRL	2	5	RACQUET CLUB HEIGHTS 2ND, S34, T01 N, R25 E, BLOCK 5, Lot 2	55.00	\$ 30.89
A24345	WRIGHT, MARK D	2850 ZIMMERMAN TRL	3	5	RACQUET CLUB HEIGHTS 2ND, S34, T01 N, R25 E, BLOCK 5, Lot 3, 2ND RES #05-18264	78.54	\$ 44.12
A27125	LILLE, SHARON L	3405 ARLENE CIR	003	004	SMOKETREE TOWNHOMES, S34, T01 N, R25 E, BUILDING C, UNIT 1, 6.25% COMMON AREA INTEREST, LOC @ LTS 3, 5-6 BLK 4 R4	10.95	\$ 6.15
A27126	WALLACE & KAY BUCKINGHAM LIVING	3405 ARLENE CIR	003	004	SMOKETREE TOWNHOMES, S34, T01 N, R25 E, BUILDING C, UNIT 2, 6.25% COMMON AREA INTEREST, LOC @ LTS 3, 5-6 BLK 4 R4	10.95	\$ 6.15
A27127	TRAUTE H SCHMIDT 1996 LIVING TRUST	3405 ARLENE CIR	003	004	SMOKETREE TOWNHOMES, S34, T01 N, R25 E, BUILDING C, UNIT 3, 6.25% COMMON AREA INTEREST, LOC @ LTS 3, 5-6 BLK 4 R4	10.95	\$ 6.15
A27128	TEHLE, MICHAEL H & CHERYL K	3405 ARLENE CIR	003	004	SMOKETREE TOWNHOMES, S34, T01 N, R25 E, BUILDING C, UNIT 4, 6.25% COMMON AREA INTEREST, LOC @ LTS 3, 5-6 BLK 4 R4	10.95	\$ 6.15
A27129	SULLIVAN, JANE M	3405 ARLENE CIR	003	004	SMOKETREE TOWNHOMES, S34, T01 N, R25 E, BUILDING C, UNIT 5, 6.25% COMMON AREA INTEREST, LOC @ LTS 3, 5-6 BLK 4 R4	10.95	\$ 6.15
A27130	HARP, DEREK H	3405 ARLENE CIR	003	004	SMOKETREE TOWNHOMES, S34, T01 N, R25 E, BUILDING C, UNIT 6, 6.25% COMMON AREA INTEREST, LOC @ LTS 3, 5-6 BLK 4 R4	10.95	\$ 6.15
A27131	SMITH, ERIK D	3405 ARLENE CIR	003	004	SMOKETREE TOWNHOMES, S34, T01 N, R25 E, BUILDING C, UNIT 7, 6.25% COMMON AREA INTEREST, LOC @ LTS 3, 5-6 BLK 4 R4	10.95	\$ 6.15
A27132	ROSELEIP, BOBB L	3405 ARLENE CIR	003	004	SMOKETREE TOWNHOMES, S34, T01 N, R25 E, BUILDING C, UNIT 8, 6.25% COMMON AREA INTEREST, LOC @ LTS 3, 5-6 BLK 4 R4	10.95	\$ 6.15
A27133	MALLOY, LORENAINE D	3448 ARLENE CIR	003	004	SMOKETREE TOWNHOMES, S34, T01 N, R25 E, BUILDING B, UNIT 1, 6.25% COMMON AREA INTEREST, LOC @ LTS 3, 5-6 BLK 4 R4	10.95	\$ 6.15
A27134	WRIGHT, CYNTHIA K	3448 ARLENE CIR	003	004	SMOKETREE TOWNHOMES, S34, T01 N, R25 E, BUILDING B, UNIT 2, 6.25% COMMON AREA INTEREST, LOC @ LTS 3, 5-6 BLK 4 R4	10.95	\$ 6.15
A27135	FAWCETT, WILLIAM L	3448 ARLENE CIR	003	004	SMOKETREE TOWNHOMES, S34, T01 N, R25 E, BUILDING B, UNIT 3, 6.25% COMMON AREA INTEREST, LOC @ LTS 3, 5-6 BLK 4 R4	10.95	\$ 6.15
A27136	WALL, RON	3448 ARLENE CIR	003	004	SMOKETREE TOWNHOMES, S34, T01 N, R25 E, BUILDING B, UNIT 4, 6.25% COMMON AREA INTEREST, LOC @ LTS 3, 5-6 BLK 4 R4	10.95	\$ 6.15

TaxID	OwnerName	PhysicalAddress	Lot	Block	LegalDescription	Lot Frontage	Assessment
A27137	FOUHY, JENNIFER M	3450 ARLENE CIR	003	004	SMOKETREE TOWNHOMES, S34, T01 N, R25 E, BUILDING A, UNIT 3450, 6.25% COMMON AREA INTEREST, LOC @ LTS 3, 5-6 BLK	10.95	\$ 6.15
A27138	LIGGETT, CHARLOTTE A	3452 ARLENE CIR	003	004	SMOKETREE TOWNHOMES, S34, T01 N, R25 E, BUILDING A, UNIT 3452, 6.25% COMMON AREA INTEREST, LOC @ LTS 3, 5-6 BLK	10.95	\$ 6.15
A27139	KNIPEKAMP, ERIN A & RANDY	3454 ARLENE CIR	003	004	SMOKETREE TOWNHOMES, S34, T01 N, R25 E, BUILDING A, UNIT 3454, 6.25% COMMON AREA INTEREST, LOC @ LTS 3, 5-6 BLK	10.95	\$ 6.15
A27140	LIPPMAN, BRYAN	3456 ARLENE CIR	003	004	SMOKETREE TOWNHOMES, S34, T01 N, R25 E, BUILDING A, UNIT 3456, 6.25% COMMON AREA INTEREST, LOC @ LTS 3, 5-6 BLK	10.95	\$ 6.15
A27247	DAHNIKE, DONALD & LINDA	3608 FLAGSTONE DR	1	7	CASTLEWOOD SUBD 4TH FILING, S27, T01 N, R25 E, BLOCK 7, Lot 1	119.65	\$ 67.21
A27248	EVONNE BROWN REVOCABLE TRUST	3612 FLAGSTONE DR	2	7	CASTLEWOOD SUBD 4TH FILING, S27, T01 N, R25 E, BLOCK 7, Lot 2	121.75	\$ 68.39
A27249	DIEHL, DAVID & JULIE	3618 FLAGSTONE DR	3	7	CASTLEWOOD SUBD 4TH FILING, S27, T01 N, R25 E, BLOCK 7, Lot 3	121.75	\$ 68.39
A27250	WOOD, BARRY H	3620 FLAGSTONE DR	4	7	CASTLEWOOD SUBD 4TH FILING, S27, T01 N, R25 E, BLOCK 7, Lot 4	121.75	\$ 68.39
A27251	SULSER, DENNIS P & VALERIE LYNN	3624 FLAGSTONE DR	5	7	CASTLEWOOD SUBD 4TH FILING, S27, T01 N, R25 E, BLOCK 7, Lot 5	119.61	\$ 67.19
A34210A	MOSELEY, PAUL H & JEANNE S	3495 SCOUT TRL			TRAILSHEDD HOMES (09), S34, T01 N, R25 E, UNIT 1, 3.225% COMMON AREA INTEREST, (1/31%) LT 1 BLK 1 TRAILSHEDD SUB (0)	11.95	\$ 6.71
A34210B	ENGEL, JEFFREY T	3491 SCOUT TRL			TRAILSHEDD HOMES (09), S34, T01 N, R25 E, UNIT 2, 3.225% COMMON AREA INTEREST, (1/31%) LT 1 BLK 1 TRAILSHEDD SUB (0)	11.95	\$ 6.71
A34210C	ENGEL, JEFFREY T	3487 SCOUT TRL			TRAILSHEDD HOMES (09), S34, T01 N, R25 E, UNIT 3, 3.225% COMMON AREA INTEREST, (1/31%) LT 1 BLK 1 TRAILSHEDD SUB (0)	11.95	\$ 6.71
A34210D	FARRAR, DEBRA S	3483 SCOUT TRL			TRAILSHEDD HOMES (09), S34, T01 N, R25 E, UNIT 4, 3.225% COMMON AREA INTEREST, (1/31%) LT 1 BLK 1 TRAILSHEDD SUB (0)	11.95	\$ 6.71
A34210E	BB PROPERTY HOLDINGS LLC	SCOUT TRL			TRAILSHEDD HOMES (09), S34, T01 N, R25 E, UNIT 5, 3.225% COMMON AREA INTEREST, (1/31%) LT 1 BLK 1 TRAILSHEDD SUB (0)	11.95	\$ 6.71
A34210G	BB PROPERTY HOLDINGS LLC	SCOUT TRL			TRAILSHEDD HOMES (09), S34, T01 N, R25 E, UNIT 6, 3.225% COMMON AREA INTEREST, (1/31%) LT 1 BLK 1 TRAILSHEDD SUB (0)	11.95	\$ 6.71
A34210H	BB PROPERTY HOLDINGS LLC	SCOUT TRL			TRAILSHEDD HOMES (09), S34, T01 N, R25 E, UNIT 7, 3.225% COMMON AREA INTEREST, (1/31%) LT 1 BLK 1 TRAILSHEDD SUB (0)	11.95	\$ 6.71
A34210I	BB PROPERTY HOLDINGS LLC	SCOUT TRL			TRAILSHEDD HOMES (09), S34, T01 N, R25 E, UNIT 8, 3.225% COMMON AREA INTEREST, (1/31%) LT 1 BLK 1 TRAILSHEDD SUB (0)	11.95	\$ 6.71
A34210J	BB PROPERTY HOLDINGS LLC	SCOUT TRL			TRAILSHEDD HOMES (09), S34, T01 N, R25 E, UNIT 9, 3.225% COMMON AREA INTEREST, (1/31%) LT 1 BLK 1 TRAILSHEDD SUB (0)	11.95	\$ 6.71
A34210K	BB PROPERTY HOLDINGS LLC	SCOUT TRL			TRAILSHEDD HOMES (09), S34, T01 N, R25 E, UNIT 10, 3.225% COMMON AREA INTEREST, (1/31%) LT 1 BLK 1 TRAILSHEDD SUB (0)	11.95	\$ 6.71
A34210L	BB PROPERTY HOLDINGS LLC	SCOUT TRL			TRAILSHEDD HOMES (09), S34, T01 N, R25 E, UNIT 11, 3.225% COMMON AREA INTEREST, (1/31%) LT 1 BLK 1 TRAILSHEDD SUB (0)	11.95	\$ 6.71
A34210M	BB PROPERTY HOLDINGS LLC	SCOUT TRL			TRAILSHEDD HOMES (09), S34, T01 N, R25 E, UNIT 12, 3.225% COMMON AREA INTEREST, (1/31%) LT 1 BLK 1 TRAILSHEDD SUB (0)	11.95	\$ 6.71
A34210N	BB PROPERTY HOLDINGS LLC	SCOUT TRL			TRAILSHEDD HOMES (09), S34, T01 N, R25 E, UNIT 13, 3.225% COMMON AREA INTEREST, (1/31%) LT 1 BLK 1 TRAILSHEDD SUB (0)	11.95	\$ 6.71
A34210O	BB PROPERTY HOLDINGS LLC	SCOUT TRL			TRAILSHEDD HOMES (09), S34, T01 N, R25 E, UNIT 14, 3.225% COMMON AREA INTEREST, (1/31%) LT 1 BLK 1 TRAILSHEDD SUB (0)	11.95	\$ 6.71
A34210P	BB PROPERTY HOLDINGS LLC	SCOUT TRL			TRAILSHEDD HOMES (09), S34, T01 N, R25 E, UNIT 15, 3.225% COMMON AREA INTEREST, (1/31%) LT 1 BLK 1 TRAILSHEDD SUB (0)	11.95	\$ 6.71
A34210Q	BB PROPERTY HOLDINGS LLC	SCOUT TRL			TRAILSHEDD HOMES (09), S34, T01 N, R25 E, UNIT 16, 3.225% COMMON AREA INTEREST, (1/31%) LT 1 BLK 1 TRAILSHEDD SUB (0)	11.95	\$ 6.71
A34210R	BB PROPERTY HOLDINGS LLC	SCOUT TRL			TRAILSHEDD HOMES (09), S34, T01 N, R25 E, UNIT 17, 3.225% COMMON AREA INTEREST, (1/31%) LT 1 BLK 1 TRAILSHEDD SUB (0)	11.95	\$ 6.71
A34210S	BB PROPERTY HOLDINGS LLC	SCOUT TRL			TRAILSHEDD HOMES (09), S34, T01 N, R25 E, UNIT 18, 3.225% COMMON AREA INTEREST, (1/31%) LT 1 BLK 1 TRAILSHEDD SUB (0)	11.95	\$ 6.71
A34210T	ROWEN, JULIE A	3490 SCOUT TRL			TRAILSHEDD HOMES (09), S34, T01 N, R25 E, UNIT 19, 3.225% COMMON AREA INTEREST, (1/31%) LT 1 BLK 1 TRAILSHEDD SUB (0)	11.95	\$ 6.71
A34211A	BB PROPERTY HOLDINGS LLC	SETTLERS TRL			TRAILSHEDD HOMES (09), S34, T01 N, R25 E, UNIT 20, 3.225% COMMON AREA INTEREST, (1/31%) LT 1 BLK 1 TRAILSHEDD SUB (0)	11.95	\$ 6.71
A34211B	BB PROPERTY HOLDINGS LLC	SETTLERS TRL			TRAILSHEDD HOMES (09), S34, T01 N, R25 E, UNIT 21, 3.225% COMMON AREA INTEREST, (1/31%) LT 1 BLK 1 TRAILSHEDD SUB (0)	11.95	\$ 6.71
A34211C	BB PROPERTY HOLDINGS LLC	SETTLERS TRL			TRAILSHEDD HOMES (09), S34, T01 N, R25 E, UNIT 22, 3.225% COMMON AREA INTEREST, (1/31%) LT 1 BLK 1 TRAILSHEDD SUB (0)	11.95	\$ 6.71
A34211D	BB PROPERTY HOLDINGS LLC	SETTLERS TRL			TRAILSHEDD HOMES (09), S34, T01 N, R25 E, UNIT 23, 3.225% COMMON AREA INTEREST, (1/31%) LT 1 BLK 1 TRAILSHEDD SUB (0)	11.95	\$ 6.71
A34211E	BB PROPERTY HOLDINGS LLC	SETTLERS TRL			TRAILSHEDD HOMES (09), S34, T01 N, R25 E, UNIT 24, 3.225% COMMON AREA INTEREST, (1/31%) LT 1 BLK 1 TRAILSHEDD SUB (0)	11.95	\$ 6.71
A34211F	BB PROPERTY HOLDINGS LLC	SETTLERS TRL			TRAILSHEDD HOMES (09), S34, T01 N, R25 E, UNIT 25, 3.225% COMMON AREA INTEREST, (1/31%) LT 1 BLK 1 TRAILSHEDD SUB (0)	11.95	\$ 6.71
A34211G	BB PROPERTY HOLDINGS LLC	SETTLERS TRL			TRAILSHEDD HOMES (09), S34, T01 N, R25 E, UNIT 26, 3.225% COMMON AREA INTEREST, (1/31%) LT 1 BLK 1 TRAILSHEDD SUB (0)	11.95	\$ 6.71
A34211H	BB PROPERTY HOLDINGS LLC	SETTLERS TRL			TRAILSHEDD HOMES (09), S34, T01 N, R25 E, UNIT 27, 3.225% COMMON AREA INTEREST, (1/31%) LT 1 BLK 1 TRAILSHEDD SUB (0)	11.95	\$ 6.71
A34211I	BB PROPERTY HOLDINGS LLC	SETTLERS TRL			TRAILSHEDD HOMES (09), S34, T01 N, R25 E, UNIT 28, 3.225% COMMON AREA INTEREST, (1/31%) LT 1 BLK 1 TRAILSHEDD SUB (0)	11.95	\$ 6.71
A34211J	BB PROPERTY HOLDINGS LLC	SETTLERS TRL			TRAILSHEDD HOMES (09), S34, T01 N, R25 E, UNIT 29, 3.225% COMMON AREA INTEREST, (1/31%) LT 1 BLK 1 TRAILSHEDD SUB (0)	11.95	\$ 6.71
A34211K	BB PROPERTY HOLDINGS LLC	SETTLERS TRL			TRAILSHEDD HOMES (09), S34, T01 N, R25 E, UNIT 30, 3.225% COMMON AREA INTEREST, (1/31%) LT 1 BLK 1 TRAILSHEDD SUB (0)	11.95	\$ 6.71
A34211L	BB PROPERTY HOLDINGS LLC	SETTLERS TRL			TRAILSHEDD HOMES (09), S34, T01 N, R25 E, UNIT 31, 3.225% COMMON AREA INTEREST, (1/31%) LT 1 BLK 1 TRAILSHEDD SUB (0)	11.95	\$ 6.71
A34211M	MORGAN, RANDY LEE & SUSAN E	2825 ARROWHEAD MEADOWS DR			ARROWHEAD MEADOWS TOWNHOMES (13), S34, T01 N, R25 E, UNIT 1, 8.333% COMMON AREA INTEREST, (1/12%) LOC @ TR 3	5.00	\$ 2.81
A34454B	LAUWERS, DAVID G & CYNTHIA	2815 ARROWHEAD MEADOWS DR			ARROWHEAD MEADOWS TOWNHOMES (13), S34, T01 N, R25 E, UNIT 2, 8.333% COMMON AREA INTEREST, (1/12%) LOC @ TR 3	5.00	\$ 2.81
A34454C	REGAL LAND DEVELOPMENT, INC	2805 ARROWHEAD MEADOWS DR			ARROWHEAD MEADOWS TOWNHOMES (13), S34, T01 N, R25 E, UNIT 3, 8.333% COMMON AREA INTEREST, (1/12%) LOC @ TR 3	5.00	\$ 2.81
A34454D	TOAVS, WILLARD A & ANITA S	2745 ARROWHEAD MEADOWS DR			ARROWHEAD MEADOWS TOWNHOMES (13), S34, T01 N, R25 E, UNIT 4, 8.333% COMMON AREA INTEREST, (1/12%) LOC @ TR 3	5.00	\$ 2.81
A34454E	REGAL LAND DEVELOPMENT, INC	2735 ARROWHEAD MEADOWS DR			ARROWHEAD MEADOWS TOWNHOMES (13), S34, T01 N, R25 E, UNIT 5, 8.333% COMMON AREA INTEREST, (1/12%) LOC @ TR 3	5.00	\$ 2.81
A34454F	FELTSCH, PERRY	2730 ARROWHEAD MEADOWS DR			ARROWHEAD MEADOWS TOWNHOMES (13), S34, T01 N, R25 E, UNIT 6, 8.333% COMMON AREA INTEREST, (1/12%) LOC @ TR 3	5.00	\$ 2.81

TaxID	OwnerName	PhysicalAddress	Lot	Block	LegalDescription	Lot Frontage	Assessment
A34454G	HOUCK, ROXY G	2740 ARROWHEAD MEADOWS DR			ARROWHEAD MEADOWS TOWNHOMES (13), S34, T01 N, R25 E, UNIT 7, 8.333% COMMON AREA INTEREST, (1/12%) LOC @ TR	5.00	\$ 2.81
A34454H	CERTAIN, BRENT	2750 ARROWHEAD MEADOWS DR			ARROWHEAD MEADOWS TOWNHOMES (13), S34, T01 N, R25 E, UNIT 8, 8.333% COMMON AREA INTEREST, (1/12%) LOC @ TR	5.00	\$ 2.81
A34454I	REGAL LAND DEVELOPMENT, INC	2800 ARROWHEAD MEADOWS DR			ARROWHEAD MEADOWS TOWNHOMES (13), S34, T01 N, R25 E, UNIT 9, 8.333% COMMON AREA INTEREST, (1/12%) LOC @ TR	5.00	\$ 2.81
A34454J	SADO, STEVEN J & CAROL A	2810 ARROWHEAD MEADOWS DR			ARROWHEAD MEADOWS TOWNHOMES (13), S34, T01 N, R25 E, UNIT 10, 8.333% COMMON AREA INTEREST, (1/12%) LOC @ TR	5.00	\$ 2.81
A34454K	BOLAND, EDEWARD M	2851 ARROWHEAD MEADOWS DR			ARROWHEAD MEADOWS TOWNHOMES (13), S34, T01 N, R25 E, UNIT 11, 8.333% COMMON AREA INTEREST, (1/12%) LOC @ TR	5.00	\$ 2.81
A34454L	REGAL LAND DEVELOPMENT, INC	2830 ARROWHEAD MEADOWS DR			ARROWHEAD MEADOWS TOWNHOMES (13), S34, T01 N, R25 E, UNIT 12, 8.333% COMMON AREA INTEREST, (1/12%) LOC @ TR	5.00	\$ 2.81
C03130A	NELSEN, JO ANN & JOHN D	2904 38TH ST W	1	1	PAUSADES PARK SUBD 1ST FILING, S28, T01 N, R25 E, BLOCK 1, Lot 1, & E2 LT 2 & ADJ 10 FT OF ALLEY	130.59	\$ 73.35
C03130A	FREDERICK, SPENCER & LEAH	2903 LAREDO PL	3	1	PAUSADES PARK SUBD 1ST FILING, S28, T01 N, R25 E, BLOCK 1, Lot 3, & W2 LT 2	133.50	\$ 74.99
C03131A	DEGGES, GREGORY L & CHERYL	3829 RIMROCK RD	1	2	PAUSADES PARK SUBD 1ST FILING, S28, T01 N, R25 E, BLOCK 2, Lot 1, & 20 FT ABDN ADJ ALLEY	83.00	\$ 46.62
C03131A	KUNTZ, HARVEY W & PATSY ANN	3835 RIMROCK RD	2	2	PAUSADES PARK SUBD 1ST FILING, S28, T01 N, R25 E, BLOCK 2, Lot 2, & ADJ 20' OF ALLEY	75.00	\$ 42.13
C03131B	SCHLOSSER, MICHAEL E & NICOLE M	3841 RIMROCK RD	3	2	PAUSADES PARK SUBD 1ST FILING, S28, T01 N, R25 E, BLOCK 2, Lot 3, & ADJ 20' OF ALLEY	75.00	\$ 42.13
C03131C	DUNCAN, TERRY A & FRANCES E	3847 RIMROCK RD	4	2	PAUSADES PARK SUBD 1ST FILING, S28, T01 N, R25 E, BLOCK 2, Lot 4, & 20 FT OF ADJ VAC ALLEY	74.24	\$ 41.70
C03132	BOWMAN, JAMES G & KATHY R	3807 PINE COVE RD	5	2	PAUSADES PARK SUBD 2ND FILING, S28, T01 N, R25 E, BLOCK 2, Lot 5, & ADJ 10 FT FOR ALLEY	87.76	\$ 49.30
C03135	MCKNIRE, VESTER D & MARILYN J	3905 RIMROCK RD	1	3	PAUSADES PARK SUBD 2ND FILING, S28, T01 N, R25 E, BLOCK 3, Lot 1, & ADJ 10 FT FOR ALLEY	83.00	\$ 46.62
C03136	KELLY, JOEL	3911 RIMROCK RD	2	3	PAUSADES PARK SUBD 2ND FILING, S28, T01 N, R25 E, BLOCK 3, Lot 2, & ADJ 10 FT FOR ALLEY	79.00	\$ 44.38
C03137	ZISS, MARTIN M	3917 RIMROCK RD	3	3	PAUSADES PARK SUBD 2ND FILING, S28, T01 N, R25 E, BLOCK 3, Lot 3, & ADJ 10 FT FOR ALLEY	79.00	\$ 44.38
C03138	ROBSON, GARTH A & GALE R	3923 RIMROCK RD	4	3	PAUSADES PARK SUBD 2ND FILING, S28, T01 N, R25 E, BLOCK 3, Lot 4, & ADJ 10 FT FOR ALLEY	79.00	\$ 44.38
C03139	PFEIFFER, JARED & TRACI	3929 RIMROCK RD	5	3	PAUSADES PARK SUBD 2ND FILING, S28, T01 N, R25 E, BLOCK 3, Lot 5, & ADJ 10 FT FOR ALLEY	79.00	\$ 44.38
C03140	COEN, LARRY D & JUDY M	2909 MELROSE LN	6	3	PAUSADES PARK SUBD 2ND FILING, S28, T01 N, R25 E, BLOCK 3, Lot 6, & ADJ 10 FT FOR ALLEY	83.17	\$ 46.72
C06134	KRAUSE, COLLEEN G	3959 RIMROCK RD	10A	1	MONTY'S PLACE SUBD, S28, T01 N, R25 E, BLOCK 1, Lot 10A, AMD LT 10 99145F (05)	91.00	\$ 51.12
C06135	WILLET, WALTER H JR & BEATRICE H	3953 RIMROCK RD	11	1	MONTY'S PLACE SUBD, S28, T01 N, R25 E, BLOCK 1, Lot 11	90.03	\$ 50.57
C06136	LOGAN, ARTHUR W & TERESA M	3947 RIMROCK RD	12	1	MONTY'S PLACE SUBD, S28, T01 N, R25 E, BLOCK 1, Lot 12	87.00	\$ 48.87
C06137	WICKS, ARLENE G	3941 RIMROCK RD	13	1	MONTY'S PLACE SUBD, S28, T01 N, R25 E, BLOCK 1, Lot 13	88.00	\$ 49.43
D04710	LUTHERAN RETIREMENT HOME INC	3940 RIMROCK RD			S33, T01 N, R25 E, C.O.S. 369 5TH AMD, PARCEL A4, & A1A, A2A & TR A3 COS 369 AMD 14 389 AC(06)	718.09	\$ 403.36
D04714	MISSIONS UNITED INC	3840 RIMROCK RD			S33, T01 N, R25 E, C.O.S. 369, PARCEL B, AMND	806.93	\$ 453.26
D04753	BOTNEN, AMANDA R & CRAIG W	3216 RIMROCK RD			S34, T01 N, R25 E, C.O.S. 247, PARCEL 1A, TR 1A COS 247 AMD (11)	103.89	\$ 58.36
D04755	LIND, MARGARET P TRUSTEE	3208 RIMROCK RD			S34, T01 N, R25 E, C.O.S. 358, PARCEL 2, AMEND	113.63	\$ 63.83
D04756	BALLAN, DAVID G & CHRYSHEEL	3204 RIMROCK RD			S34, T01 N, R25 E, C.O.S. 358, PARCEL 3, AMND	22.00	\$ 12.36
D04757	LIND, WILLIAM R	3200 RIMROCK RD			S34, T01 N, R25 E, C.O.S. 358, PARCEL 4, AMEND & LT 5 SAUNDERS SUB	22.00	\$ 12.36

11,705.88 \$6,575.36